

Building and Parking Summary		
Land Use	Proposed OSTA Certificate Square Footage	Parking Spaces
LU 823 - Outlet Center	239,063	
LU 931 - Quality Restaurant	12,280	1,259
LU 932 - High Turnover Restaurant	13,657	
<b>Total:</b>	<b>265,000</b>	<b>1,259</b>

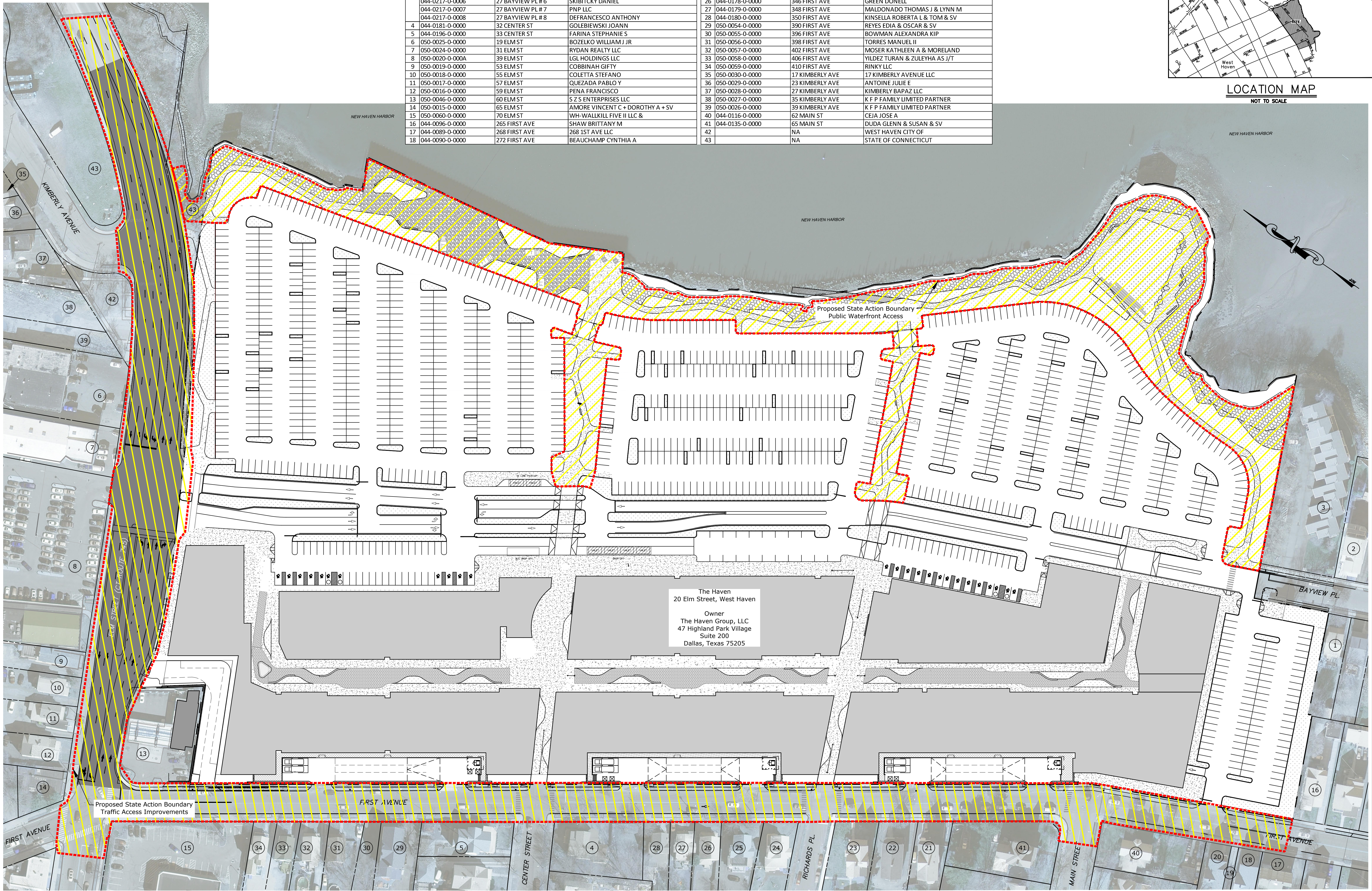

ABUTTERS							
Parcel ID	Site Address	Owner Name	Parcel ID	Site Address	Owner Name		
1	044-0106-0-0000	18 BAYVIEW PL	JONES CHRISTOPHER W & BONNIE A AS J/T	19	044-0091-0-0000	274 FIRST AVE	KAISER AND HEFFERNAN, L.L.C.
2	044-0218-0-0000	25 BAYVIEW PL	ZHENG REN HUANG	20	044-0092-0-0000	276 FIRST AVE	QUEZADA SERGIO M & ELA & SV
3	044-0217-0-0001	27 BAYVIEW PL # 1	LAMOUNTAIN JERI L	21	044-0136-0-0000	320 FIRST AVE	DALTON MICHELE J. 1/2 & DYKUN
4	044-0217-0-0002	27 BAYVIEW PL # 2	PEI LIANG	22	044-0137-0-0000	324 FIRST AVE	MIGLIARO SALVATORE
5	044-0217-0-0003	27 BAYVIEW PL # 3	ZHANG YIM NGOR	23	044-0138-0-0000	328 FIRST AVE	GRESTINI DAVID A & LAURA A & SV
6	044-0217-0-0004	27 BAYVIEW PL # 4	CHURCHILL TYLER J	24	044-0176-0-0000	338 FIRST AVE	PAGAN JOSE A
7	044-0217-0-0005	27 BAYVIEW PL # 5	COLLINS MATTHEW	25	044-0177-0-0000	342 FIRST AVE	BOUKNIGHT EBONY S
8	044-0217-0-0006	27 BAYVIEW PL # 6	SKIBITCKY DANIEL	26	044-0178-0-0000	346 FIRST AVE	GREEN DONELL
9	044-0217-0-0007	27 BAYVIEW PL # 7	PNP LLC	27	044-0179-0-0000	348 FIRST AVE	MALDONADO THOMAS J & LYNN M
10	044-0217-0-0008	27 BAYVIEW PL # 8	DEFRANCESCO ANTHONY	28	044-0180-0-0000	350 FIRST AVE	KINSELLA ROBERTA L & TOM & SV
11	044-0181-0-0000	32 CENTER ST	GOLEBIEWSKI JOANN	29	050-0054-0-0000	390 FIRST AVE	REYES EDIA & OSCAR & SV
12	044-0196-0-0000	33 CENTER ST	FARINA STEPHANIE S	30	050-0055-0-0000	396 FIRST AVE	BOWMAN ALEXANDRA KIP
13	050-0025-0-0000	19 ELM ST	BOZELKO WILLIAM J JR	31	050-0056-0-0000	398 FIRST AVE	TORRES MANUEL II
14	050-0024-0-0000	31 ELM ST	RYDAN REALTY LLC	32	050-0057-0-0000	402 FIRST AVE	MOSER KATHLEEN A & MORELAND
15	050-0020-0-000A	39 ELM ST	LGL HOLDINGS LLC	33	050-0058-0-0000	406 FIRST AVE	YILDEZ TURAN & ZULEYHA AS J/T
16	050-0019-0-0000	53 ELM ST	COBBINAH GIFTY	34	050-0059-0-0000	410 FIRST AVE	RINKY LLC
17	050-0018-0-0000	55 ELM ST	COLETTA STEFANO	35	050-0030-0-0000	17 KIMBERLY AVE	17 KIMBERLY AVENUE LLC
18	050-0017-0-0000	57 ELM ST	QUEZADA PABLO Y	36	050-0029-0-0000	23 KIMBERLY AVE	ANTOINE JULIE E
19	050-0016-0-0000	59 ELM ST	PENA FRANCISCO	37	050-0028-0-0000	27 KIMBERLY AVE	KIMBERLY BAPAZ LLC
20	050-0046-0-0000	60 ELM ST	S Z S ENTERPRISES LLC	38	050-0027-0-0000	35 KIMBERLY AVE	K F P FAMILY LIMITED PARTNER
21	050-0015-0-0000	65 ELM ST	AMORE VINCENT C + DOROTHY A + SV	39	050-0026-0-0000	39 KIMBERLY AVE	K F P FAMILY LIMITED PARTNER
22	050-0060-0-0000	70 ELM ST	WH-WALKKILL FIVE II LLC &	40	044-0116-0-0000	62 MAIN ST	CEJA JOSE A
23	044-0096-0-0000	265 FIRST AVE	SHAW BRITTANY M	41	044-0135-0-0000	65 MAIN ST	DUDA GLENN & SUSAN & SV
24	044-0089-0-0000	268 FIRST AVE	268 1ST AVE LLC	42		NA	WEST HAVEN CITY OF
25	044-0090-0-0000	272 FIRST AVE	BEAUCHAMP CYNTHIA A	43		NA	STATE OF CONNECTICUT

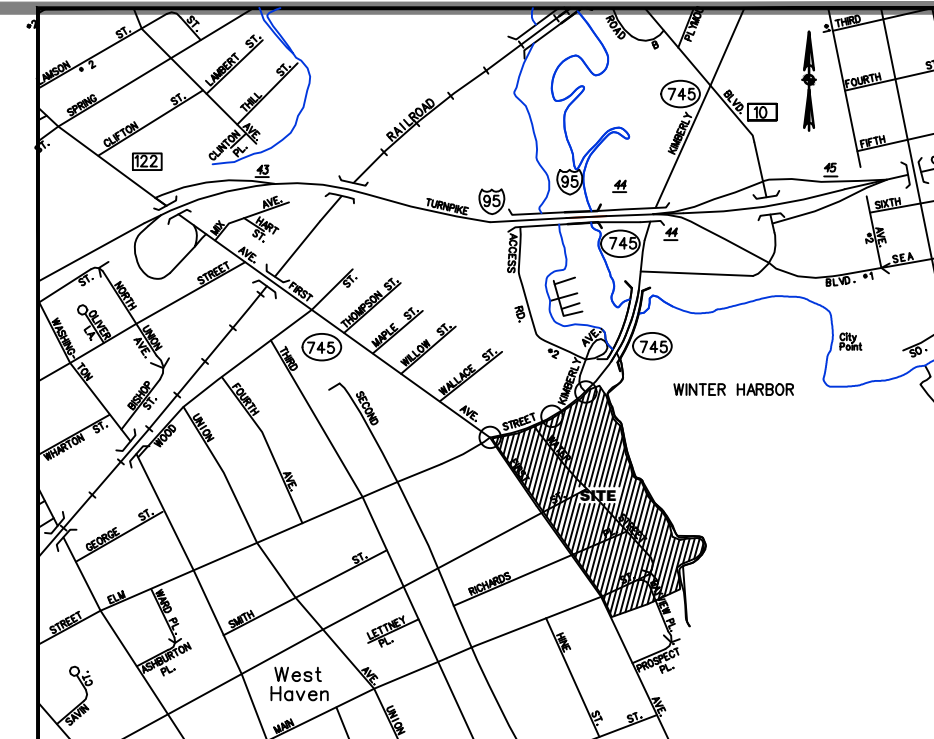

REVISIONS	DESCRIPTION	SURVEY BOOK: n/a	SURVEYOR: n/a	DRAWN: SRU	CHECKED: JLF	APPROVED: JLF
No.	DATE					

SCALE: HORZ.: 1" = 60'  
VERT.: n/a

SURVEY DATUM: HORZ.: n/a  
VERT.: n/a

GRAPHIC SCALE

Prepared By: **benesch**

Alfred Benesch & Company  
120 Hebron Avenue, 2nd Floor  
Glastonbury, Connecticut 06033  
860-633-6341

**THE HAVEN**  
Overall Site Plan  
With  
Proposed State Action Boundaries  
20 Elm Street  
West Haven  
Connecticut

PROJ. No.: 70132.00  
DATE: 10/19/2018

**SA-1**