

NO.	DATE	DESCRIPTION	DESIGNER	REVIEWER
1				

AECOM
 AECOM
 500 ENTERPRISE DRIVE, SUITE 3B
 ROCKY HILL, CT 06067
 (860) 529-8882

CONCEPTUAL SITE PLAN
 161/177 STATE STREET
 MERIDEN, CT

PROJ. NO.: 00445978
 DATE: NOVEMBER, 2015

C-101

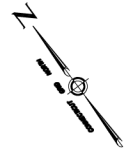

- LEGEND:**
- 5" CONCRETE SIDEWALK
 - 5" CONCRETE INTERIOR SIDEWALK
 - 6" CONCRETE OUTDOOR PLAY AREA
 - PAVEMENT MARKINGS
 - DRAINAGE EASEMENT
 - TOTAL LOT AREA
 - LANDSCAPE MATERIALS (REFER TO SHEET C-109)
 - CONCRETE RETAINING WALL (REFER TO ARCHITECTURAL PLANS FOR DETAILS)

NOTES:

PERMIT PLANS
NOT FOR CONSTRUCTION

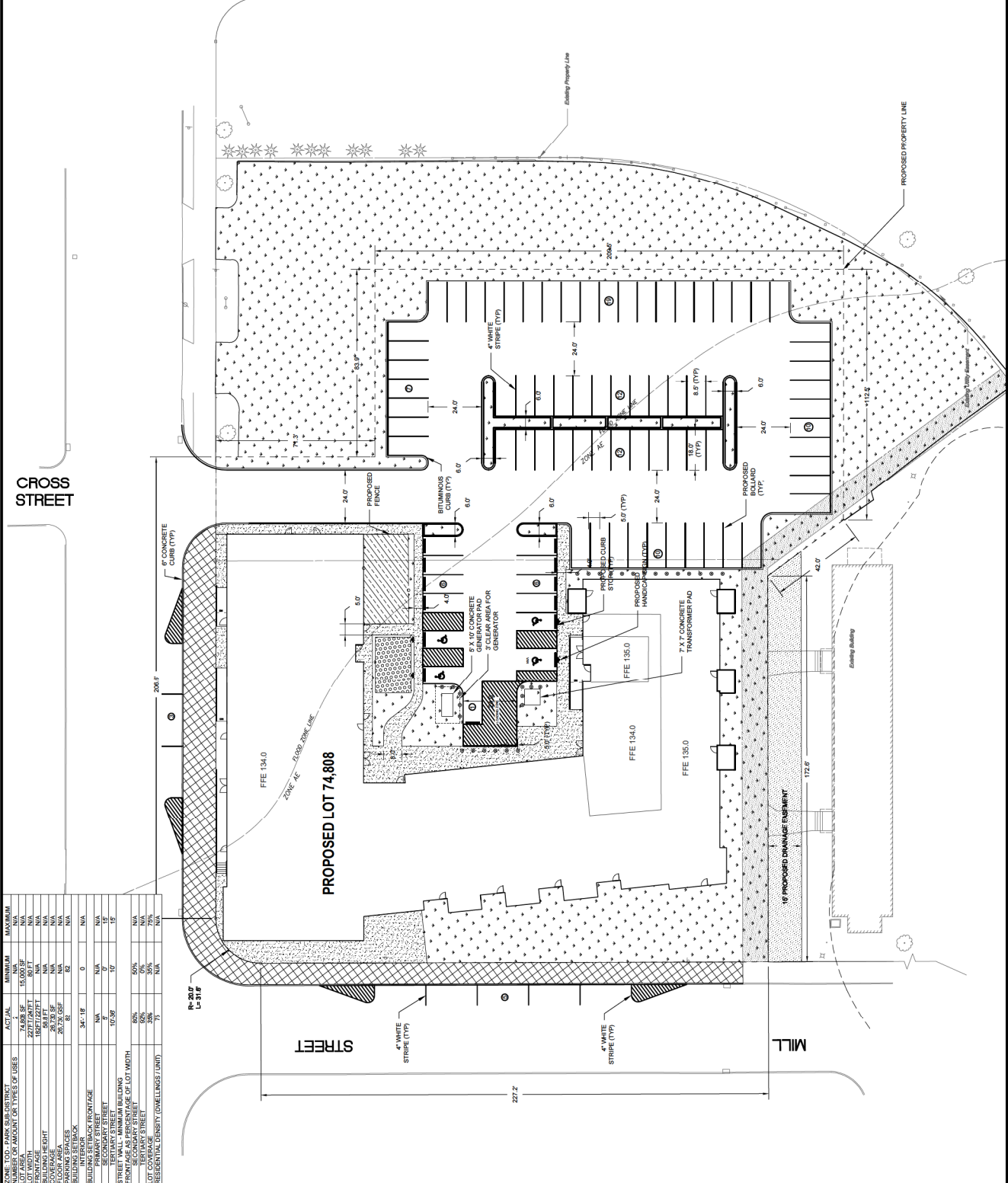
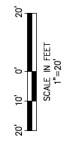

PROPERTY INFORMATION	ACT. VAL.	MINIMUM	MAXIMUM
NUMBER OF UNITS	74,808 SF	15,000 SF	N/A
LOT AREA	74,808 SF	N/A	N/A
COVERAGE	48.27%	N/A	N/A
SETBACKS	8.0 FT	N/A	N/A
BUILDING HEIGHT	8.0 FT	N/A	N/A
FLOOR AREA	26,736 SF	N/A	N/A
FLOOR AREA	81	N/A	N/A
BUILDING SETBACK	81	N/A	N/A
INTERIOR	0	N/A	N/A
EXTERIOR	0	N/A	N/A
PRIMARY STREET	N/A	N/A	N/A
SECONDARY STREET	10.0 FT	10	10
STREET WALL - MINIMUM BUILDING	6.0 FT	50%	N/A
STREET WALL - MAXIMUM BUILDING	6.0 FT	50%	N/A
WIDTH OF LOT WIDTH	6.0 FT	50%	N/A
TERTIARY STREET	7.5 FT	50%	N/A
RESIDENTIAL DENSITY (Dwellings/Unit)	75	N/A	N/A