

The enclosed overlay of the Hartford South Quadrangle includes the location, shape, and dip and strike of a number of outcrops which are not included on Deane's surficial map or which were more extensive prior to 1967.

All of these outcrops were mapped in the early 1890's by A.P. Bryant, E.L. Rice, and Wm. N. Rice. Many of these outcrops are the victims of urbanization (pavement and grass). Others such as many of the basalt outcrops on Vexation Mtn have not been mapped in recent times due to the difficulty of mapping in a wooded area. However, using the 1890 paced and compass locations of these outcrops prepared by A.P. Bryant and replotting each outcrop on the Hartford M.D.C. sheets it is possible to accurately locate these outcrops. In locating each outcrop on the 1":200'/2' contour interval M.D.C. sheets only those which correspond to significant topographic features were plotted. Any questionable outcrop was omitted. This method appears to be satisfactory for the moment, but all locations should be field checked.

Most of the outcrops on the overlay appear with dip and strike information, however the basalt outcrops generally do not and some sedimentary outcrops were so weathered that the original workers were not able to gather the data and so state in their notes.

Joe Peoples, who supplied this data from the Wesleyan files, and I have discussed the use of the data on the new bedrock map for the Hartford South. We agree that because competent geologists collected and recorded this data, it should be used. Some symbol such as "x" for "reported" would be used to designate such "outcrops". Any comments pro or con for such use of this data or its means of presentation would be greatly appreciated.

Westleyan Station
Middletown, Conn. 06457

Compiled by John Byrnes 10/1/72
blue = rudimentary rock outcrops
orange = basalt outcrops

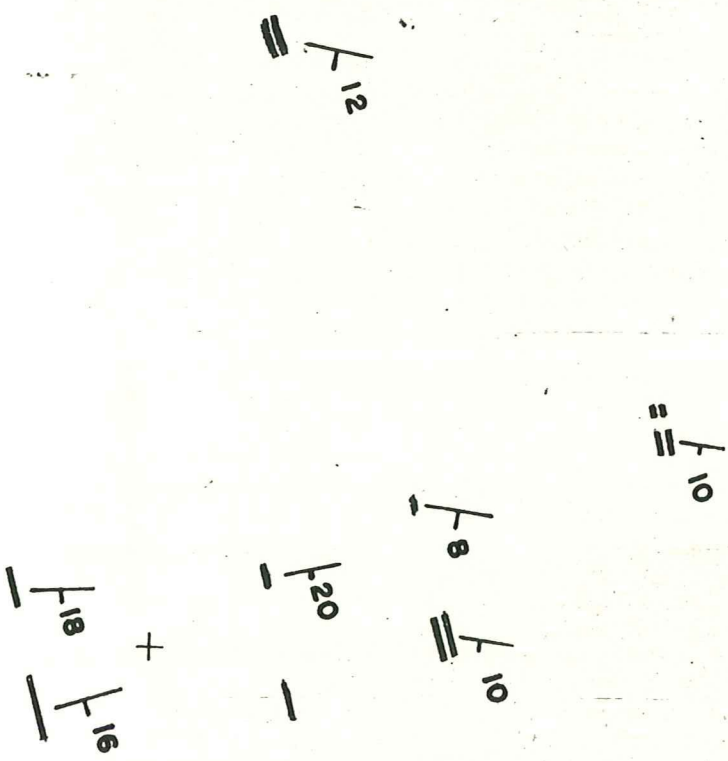

⊕

F₁₂

F₁₀

F_{10r}

F₁₀

F₈

F₂₀

F₁₈

+

F₁₆

F₂₈

F₁₀

F₁₅

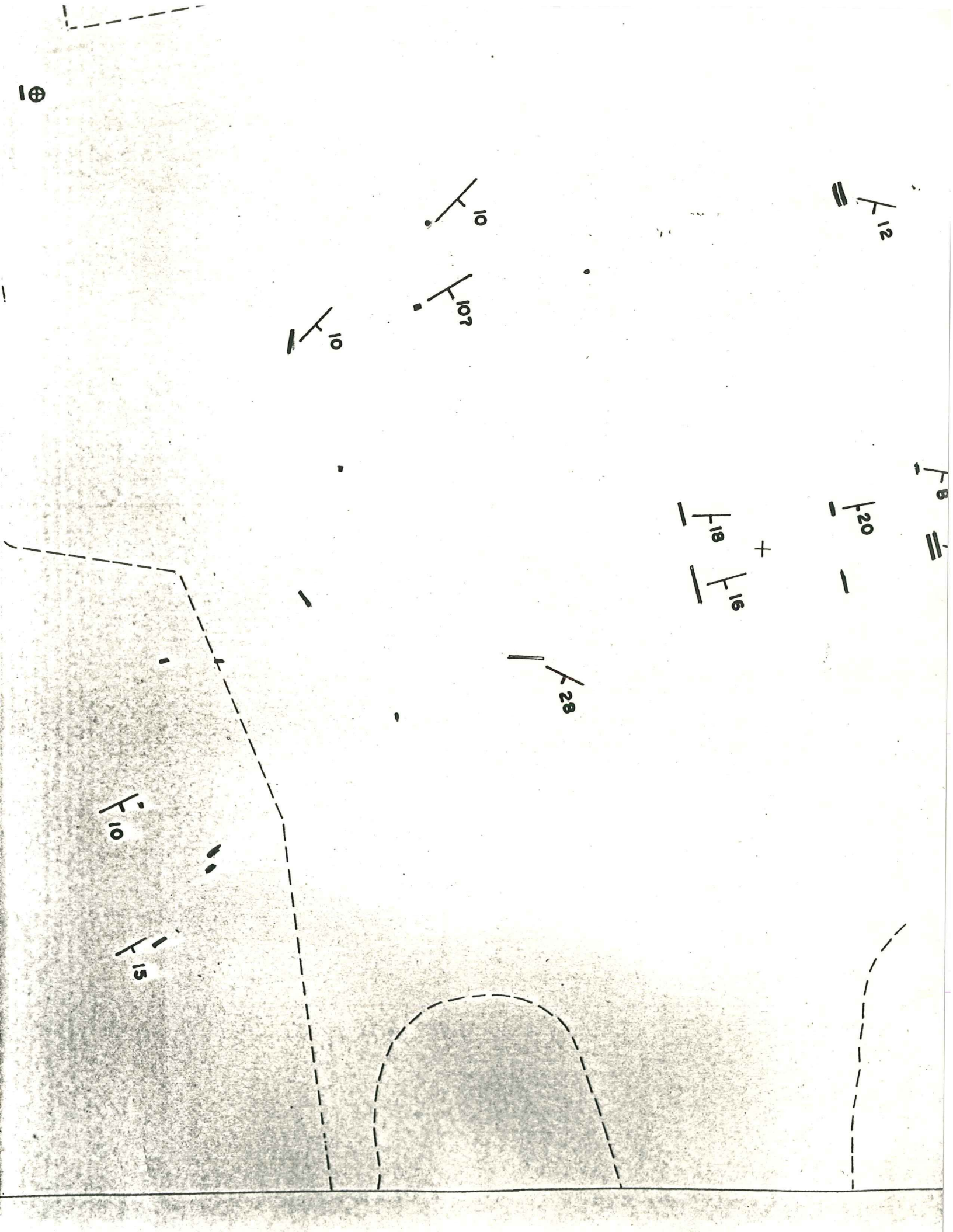

⊕

12

8

10

12

9

10

F10

F15

10



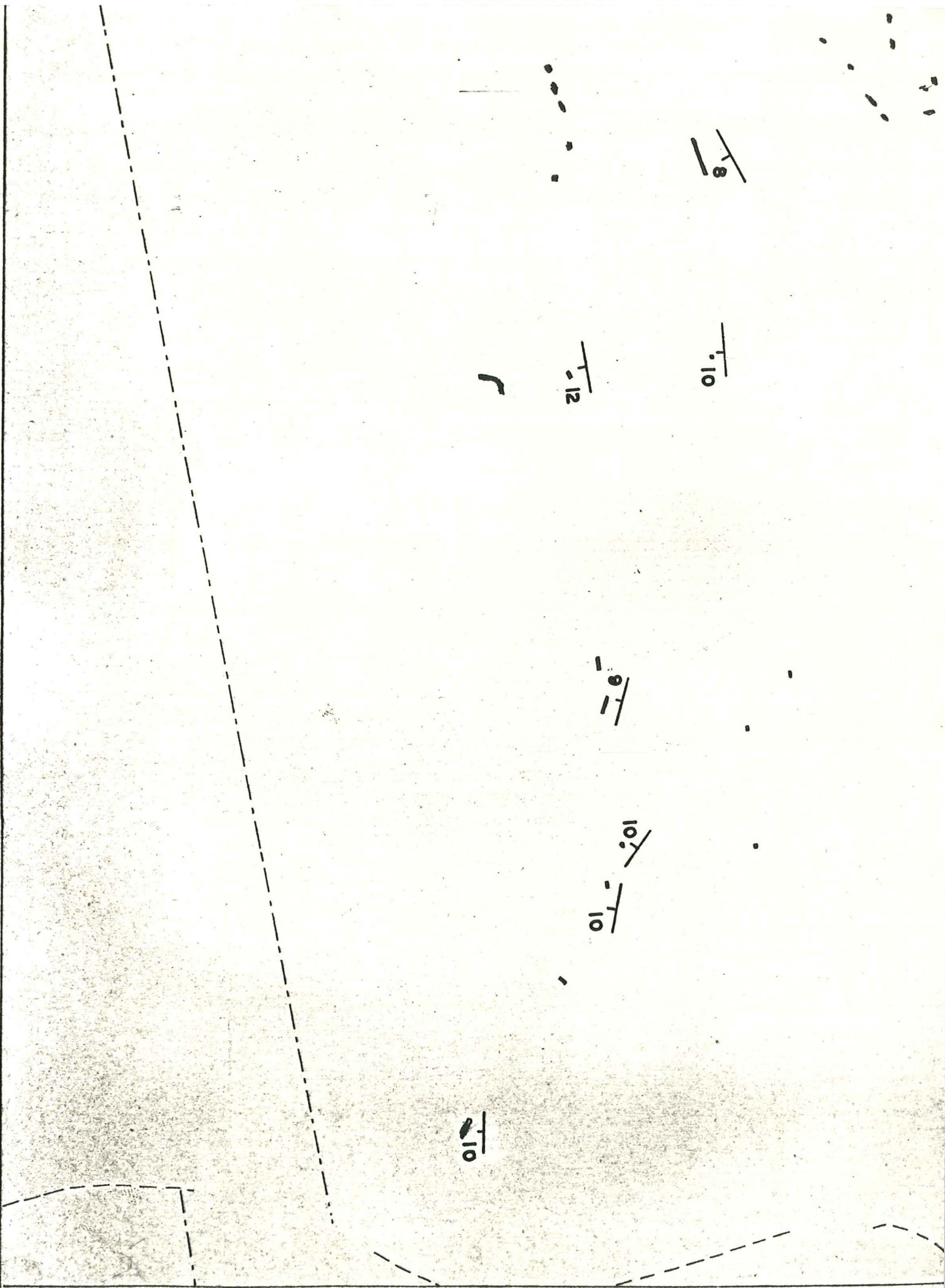

HARTFORD SOUTH

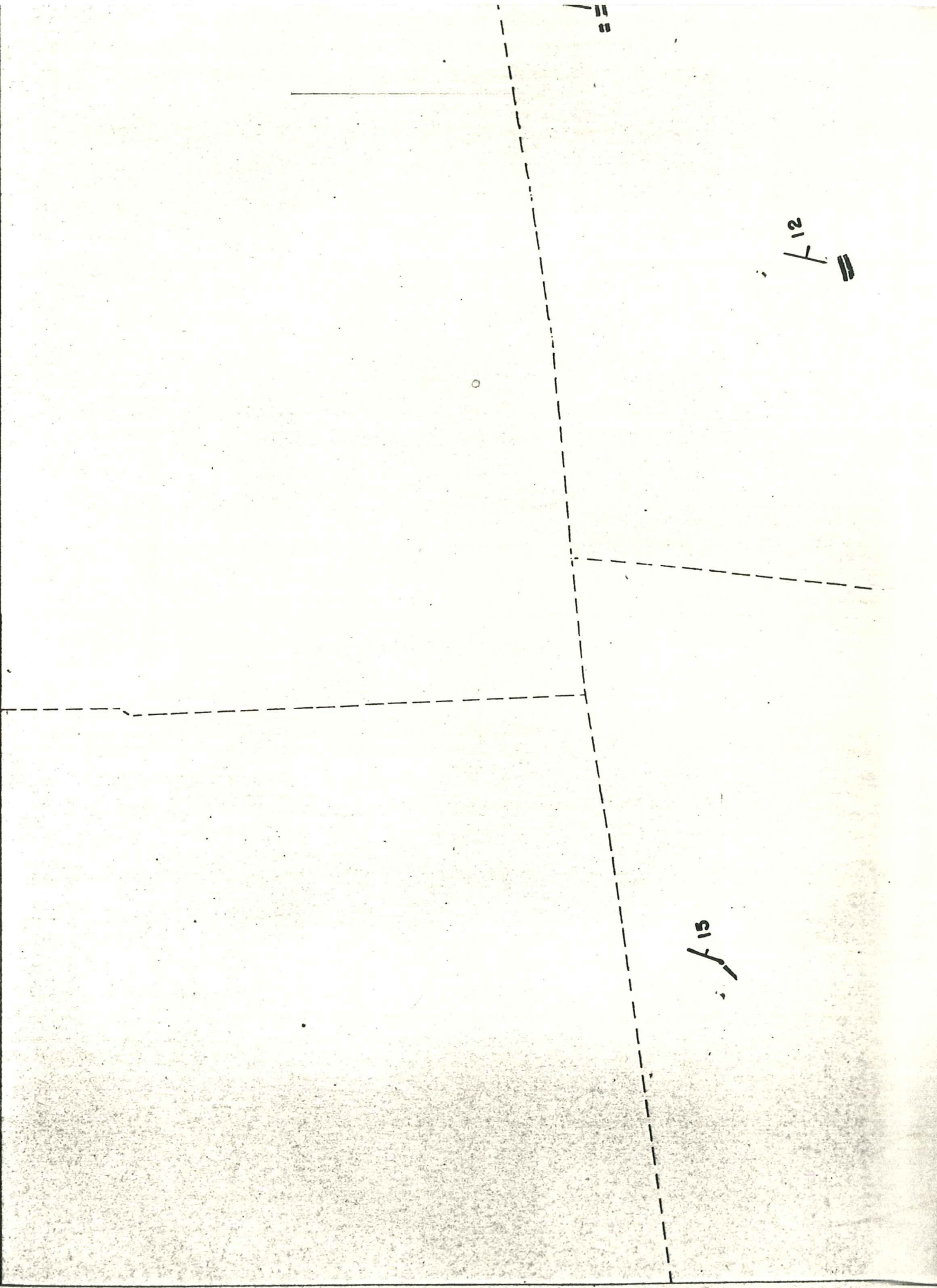

F 15

F 12

7

f 12

f 10

f 107

f 10

f 15

f 10

f 10



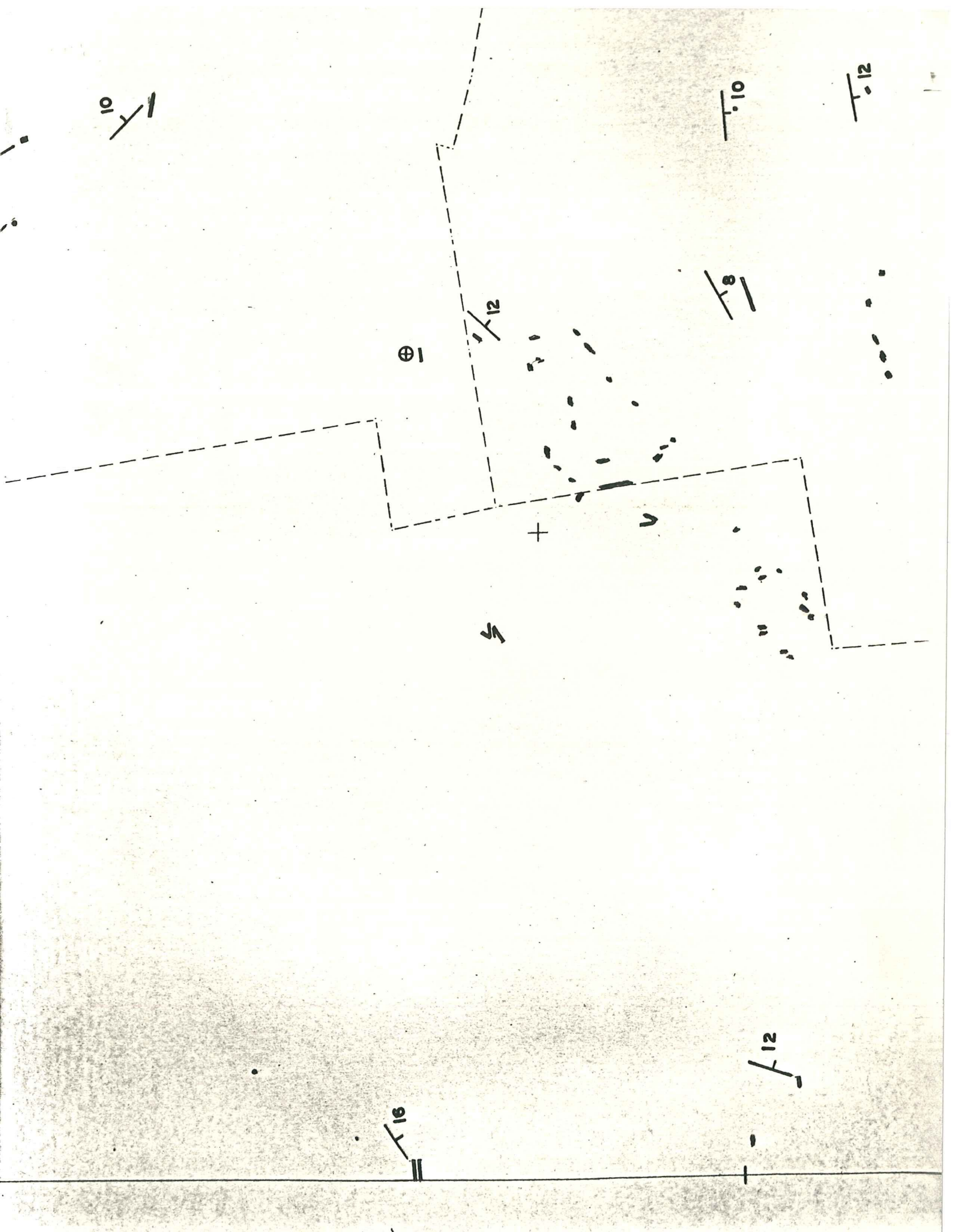

10

12

8

12

15 15 10 15 15 8 8