

Request for Proposals:

HOUSATONIC RIVER NATURAL RESOURCES RESTORATION PROJECT
CONNECTICUT SUBCOUNCIL REQUEST FOR PROPOSALS (RFP)

Part A: RESPONDER AND PROJECT SUMMARY FORM

RECEIVED
JAN 18 2017
INLAND FISHERIES

Please read "RFP: Overview of Selection Process" before completing this form.

Part A must be completed using Submittal Form A. Responses may be entered electronically using the Microsoft Word version of Part A of this form available on the Housatonic River Basin Natural Resource Restoration Project in Connecticut website (www.housatonicrestoration.org), saved and printed. Alternatively, the responder may print the form and complete it with black ink. An Adobe Acrobat version of the entire form (Part A and Part B) is also available on the Housatonic River Basin Natural Resource Restoration Project in Connecticut website

Project Name Provide a brief working name.

Sega Meadows Park River Enhancement

Responder – if there is more than one party involved in the project, please provide the information for the primary or lead party.

Patricia Murphy

Name

Mayor

Title

10 Main St.

Address

Address

New Milford, CT 06776

City State Zip

(860) 355-6010

Phone

mayor@newmilford.org

Email

Type of Entity

Check the box that best describes the primary respondent.

- Private individual
- Non-profit organization
- Municipal government
- State government
- County government
- Federal government
- Tribal government
- Corporation or Business
- Academic Institution
- Other (explain)

Project Implementation

Does the responder plan to be the Project Sponsor and respond to the Request for Supplemental Information (RSI) pending approval of this Proposal?

Yes No

If yes, please list any other project participants. _____

If the responder does **NOT** plan to be the Project Sponsor and does **NOT** intend to respond to the Request for Supplemental Information (RSI), is the responder interested in being a project participant and assisting a different Project Sponsor on this project?

Yes No

Request for Proposals:

Restoration Priority Funding Category See Sec. 3 of "RFP: Overview of Selection Process" for category descriptions.

Primary Restoration Category. Check the restoration category that is the primary goal of the project. Check one box.

- Aquatic Natural Resources Restoration/Enhancement
- Riparian & Floodplain Natural Resources Restoration/Enhancement
- Restoration/Enhancement of Recreational Uses of Natural Resources

Secondary Categories. Check all relevant boxes.

- Aquatic Natural Resources Restoration/Enhancement
- Riparian & Floodplain Natural Resources Restoration/Enhancement
- Restoration/Enhancement of Recreational Uses of Natural Resources

List Specific Injured Natural Resources and/or Impaired Natural Resource Services to Benefit from Project

Construct a park access, create nature trails throughout the park, establish picnic areas, promote flora and fauna educational prospects and promote passive and active recreational opportunities along the Housatonic River.

Project Location (if known) See directions and "RFP: Overview of Selection Process" for additional materials to provide (maps, aerial photographs)

Municipality/ies:

New Milford

Longitude for approximate center of project area: W 73deg 27min

Latitude for approximate center of project area: N 41deg 36min

Project Budget Estimate (if known)

Total Project Cost Estimate: \$ 75,000

Housatonic River NRD Fund Estimate: \$ 75,000

Sega Meadows Park
Town of New Milford
10 Main St New Milford CT 06776

Item 1. – Project Narrative

1. Identify project Goals and Objectives

The Town of New Milford is requesting consideration for funding from the Housatonic River Natural Resources Restoration Project for the development of Sega Meadows Park. Sega Meadows Park was purchased by the Town of New Milford in 1992 and has yet to be developed. Sega Meadows is a 23-acre public park nestled between the beautiful Housatonic River and scenic River Road in northern New Milford.

Prior to 2005, the Town was unable to fully use this undeveloped park area due to public fear of PCB contamination, limited pedestrian access and no available parking for vehicles. However, in November 2005, through the generosity of Northeast Utilities, an additional 65.12 acres on the Housatonic River was licensed to the Town to be used expressly for access improvements and development of the park. The Town of New Milford would like to begin the process of appropriately utilizing this wonderful resource for passive recreational use.

2. Project Benefits

The proposed improvements will provide numerous benefits, including, but not limited to the following:

- Provide the public with unique educational opportunities and direct public access to this pristine property through the creation of a parking area, installation of signage and an information kiosk
- Continued support for a variety of wildlife, including bobcats, wild turkeys, foxes, coyotes, beavers, deer, a wide variety of fish and numerous types of birds for the naturalist to enjoy
- Creation of nature trails throughout the park and alongside the river, including identification of native flora and fauna through the use of educational signage
- Establishment of picnic areas, and areas for primitive camping
- Creation of designated areas for fishing, non-motorized boating and the establishment of trails for mountain biking, horseback riding and cross country skiing.
- Promotion of programs emphasizing the importance of wetlands awareness and the preservation of the Housatonic River habitat and tiered floodplain system.
- Provide opportunities for schools, scouts and emergency preparedness personnel to visit and study floodplain function and formation

Sega Meadows Park
Town of New Milford
10 Main St New Milford CT 06776

3. General Tasks

The general tasks in order to bring this project to fruition are the following:

- Procure the appropriate permits as required by federal, state and local agencies
- Purchase and installation of appropriate erosion controls
- Purchase and installation of materials necessary for construction of the access road and parking area
- Purchase and installation of site amenities, including picnic tables, grills, park benches, garbage receptacles, and bike rack
- Purchase and installation of park signage
- Design and development of the trail system and an information kiosk
- Development and construction of a primitive camping area on the banks of the Housatonic River
- Development of a designated fishing area along the Housatonic River and around a pond located on the property
- Maintenance and development of a nature observation area around the pond and along the river bank
- Purchase and installation of nesting boxes for native species of birds

We are confident that this project meets your criteria and believe this proposal would be of interest to the Housatonic River Natural Resources Restoration Project Sub-Council. Through careful planning, the passive and active recreational areas proposed for this property will encourage the public to improve and preserve the environmental conditions along the shoreline of the Housatonic River.

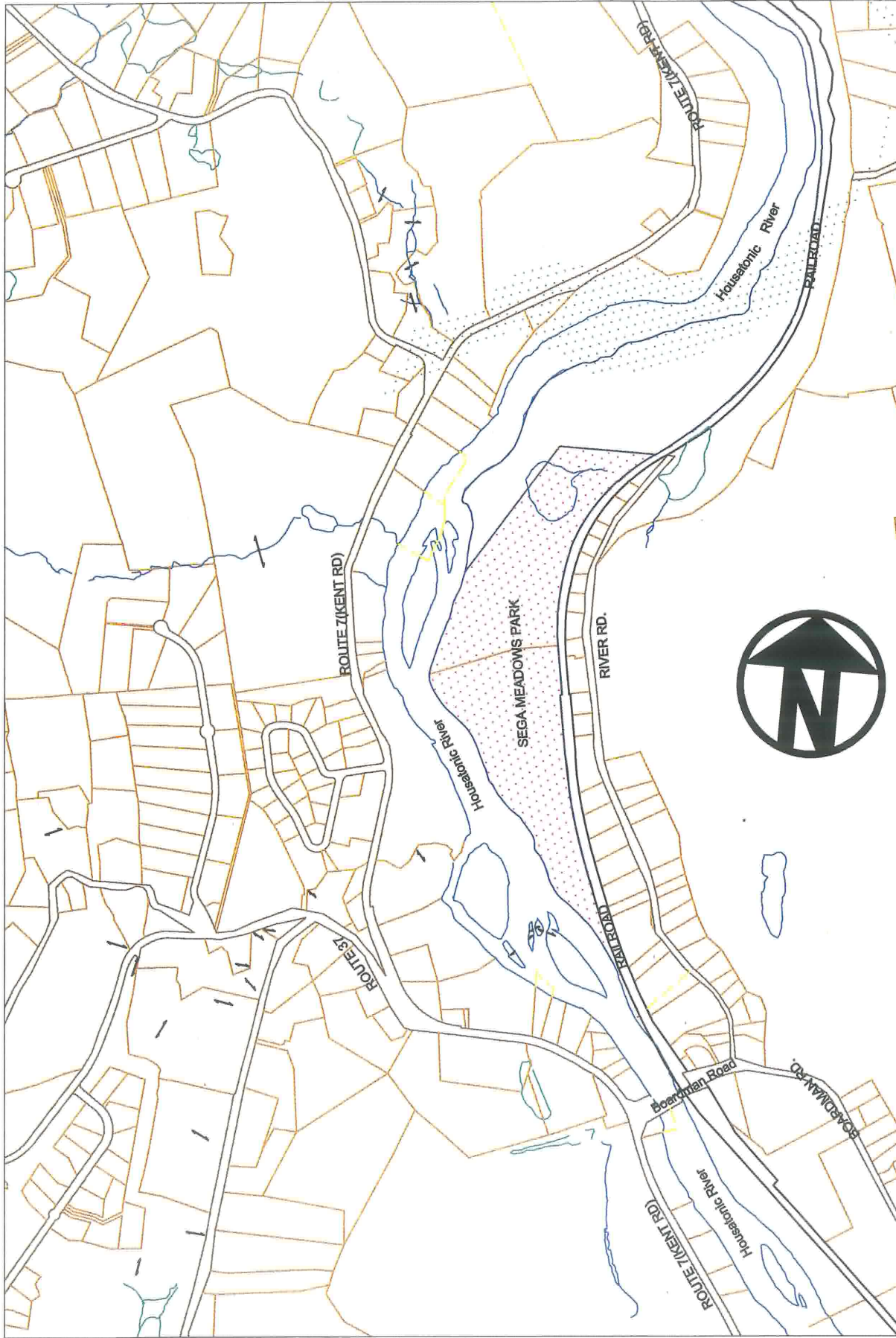

Vicinity Map Sega Meadows Park
 Town Of New Milford
 Scale 1" = 1000', Date January 16, 2007



Town of New Milford
 Public Works Department
 6 Young's Field Road
 New Milford, Connecticut
 (860) 355-6040, fax (860) 355-6055

Sega Meadows Park
Town of New Milford
10 Main St New Milford CT 06776

Item 3. – Criteria Statement

1. Does the proposal contain the information identified by the CT SubCouncil as set out in the “Instructions for the Preparation and Submission of Restoration Project Proposals”?
 - **Yes, the proposal contains the requested information and has been submitted.**
2. Does the Proposed Project restore, rehabilitate, replace, and/or acquire natural resources or natural resource services equivalent to those that were injured by the release of PCB’s or other hazardous substances from the GE facility at Pittsfield, MA?
 - **Yes, the Proposed Project does restore and rehabilitate natural resources that were injured by the release of PCB’s or other hazardous substances from the GE facility at Pittsfield, MA. Due to the polluted river and river bank conditions many individuals refrained from using this parcel for recreation endeavors. The development of this park will allow us to offer controlled access to the recreational and conservation amenities and areas that we have planned.**
3. Is the Proposed Project, or any portion of the Proposed Project, an action that is presently required under other federal, state, or local laws, including, but not limited to, enforcement actions?
 - **No, there are no enforcement actions pending for this site.**
4. Is the Proposed Project inconsistent with any federal, state or local law or policy?
 - **No, the project is not inconsistent with any federal, state, or local law or policy.**
5. Will the Proposed Project, or any portion of the project, be inconsistent with any ongoing or anticipated remedial actions in the Housatonic River watershed?
 - **No, the Proposed Project will not be inconsistent with any ongoing or anticipated remedial actions in the Housatonic River watershed.**

