

# Starting a Visit from the Search Client tab (Known Client)

## Starting a Visit from the Search Client tab (Known Client)

Navigate to the **SEARCH CLIENT** tab and follow the instructions to start a visit.

1. Tap the **Enter Client Identifier** field, enter search criteria.
2. Tap **SEARCH CLIENT**.
3. Tap **CONTINUE VISIT**.

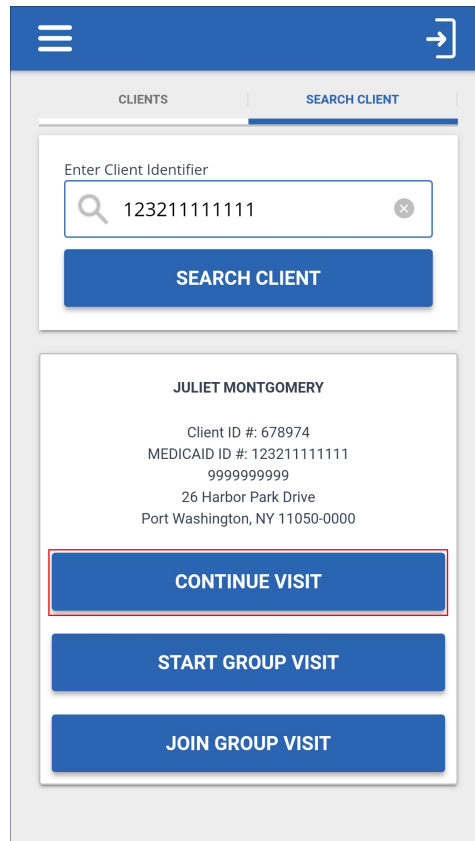

CLIENTS | SEARCH CLIENT

Enter Client Identifier

123211111111

SEARCH CLIENT

**JULIET MONTGOMERY**

Client ID #: 678974  
MEDICAID ID #: 123211111111  
9999999999  
26 Harbor Park Drive  
Port Washington, NY 11050-0000

CONTINUE VISIT

START GROUP VISIT

JOIN GROUP VISIT

4. Tap the **Select Service** field.
5. Select a service from the list.

# Starting a Visit from the Search Client tab (Known Client)

6. Tap **OK**.

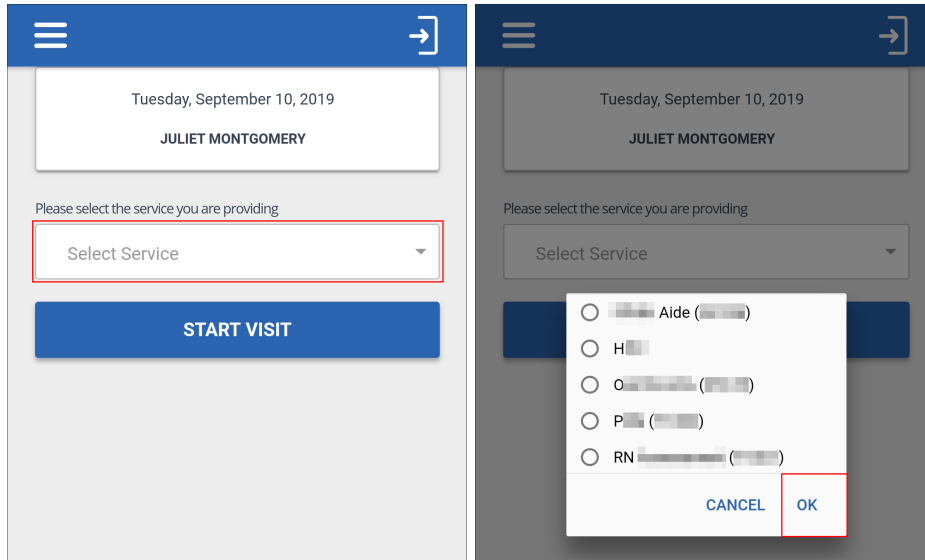

7. Tap **START VISIT**.

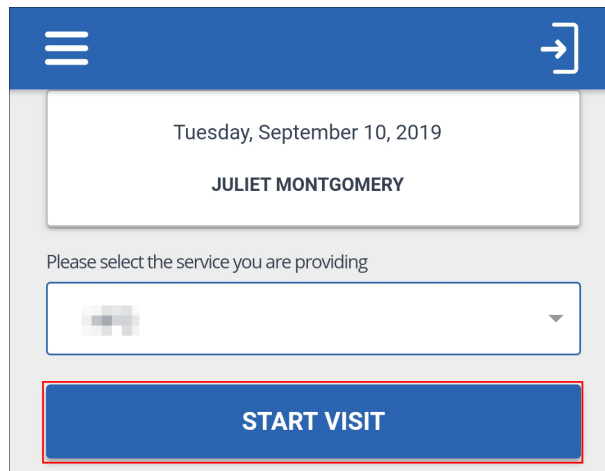

# Starting a Visit from the Search Client tab (Known Client)

8. Tap **YES** to start the visit.

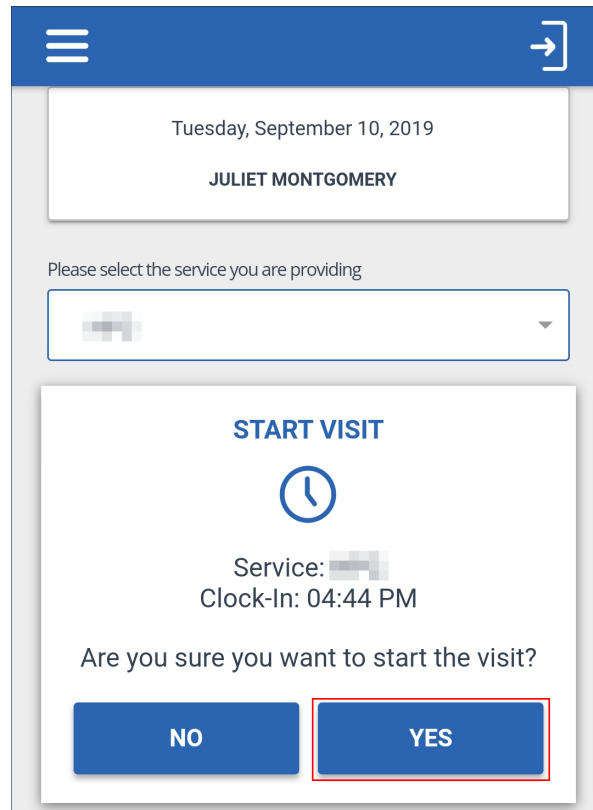

The screenshot shows a mobile application interface with a blue header bar containing a menu icon on the left and a back arrow on the right. Below the header, the date "Tuesday, September 10, 2019" and the name "JULIET MONTGOMERY" are displayed. A prompt "Please select the service you are providing" is followed by a dropdown menu with a blurred selection. A white card titled "START VISIT" features a clock icon, the text "Service: [blurred]", and "Clock-In: 04:44 PM". Below this, the question "Are you sure you want to start the visit?" is shown, with two blue buttons: "NO" and "YES". The "YES" button is highlighted with a red border.