

ELEVATION

SCALE: 1"=10'

- PROPOSED BRIDGE
- OPEN METAL BRIDGE RAIL
- WATERCOURSE

BRIDGE REPLACEMENT	
SAND ROAD OVER WEST ASPETUCK RIVER	
PROPOSED ALTERNATE A	
CITY/TOWN: NEW MILFORD	BRIDGE NO. 05263
STATE PROJECT NO.: 0095-0258	DATE: 11/29/2022

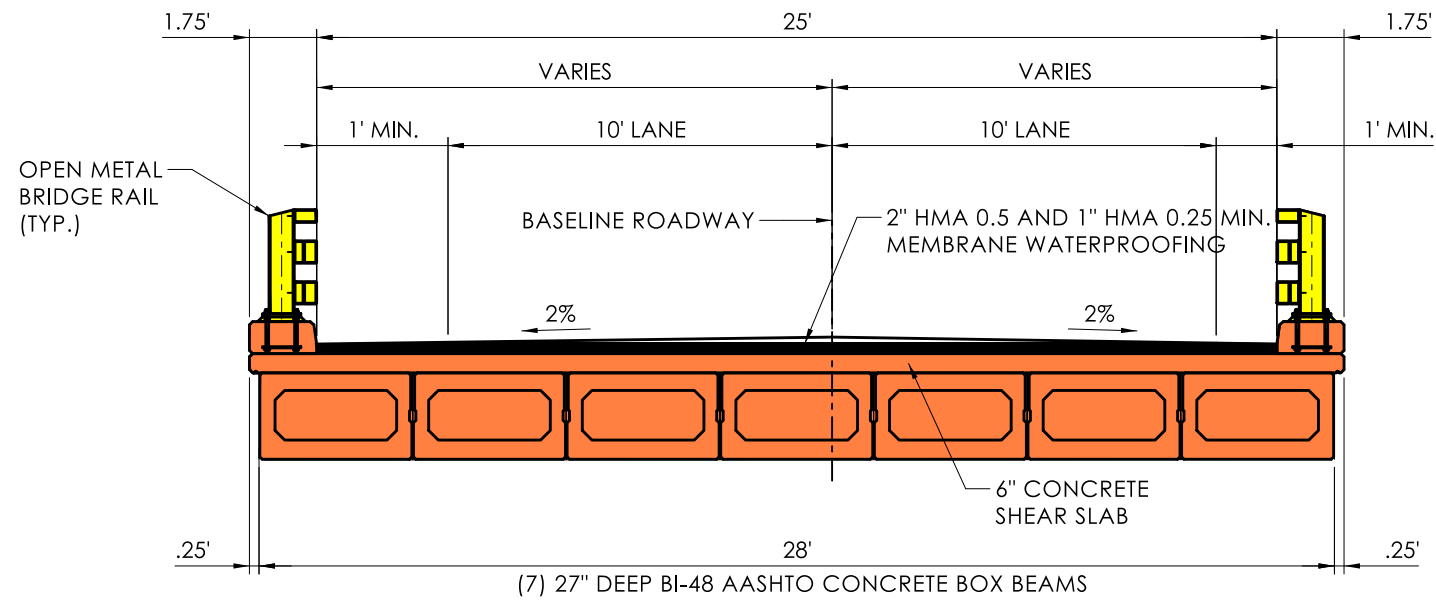

TYPICAL SECTION

SCALE: 1"=5'

- PROPOSED BRIDGE
- OPEN METAL BRIDGE RAIL
- PAVEMENT

BRIDGE REPLACEMENT	
SAND ROAD OVER WEST ASPETUCK RIVER	
PROPOSED ALTERNATE A	
CITY/TOWN: NEW MILFORD	BRIDGE NO. 05263
STATE PROJECT NO.: 0095-0258	DATE: 11/29/2022

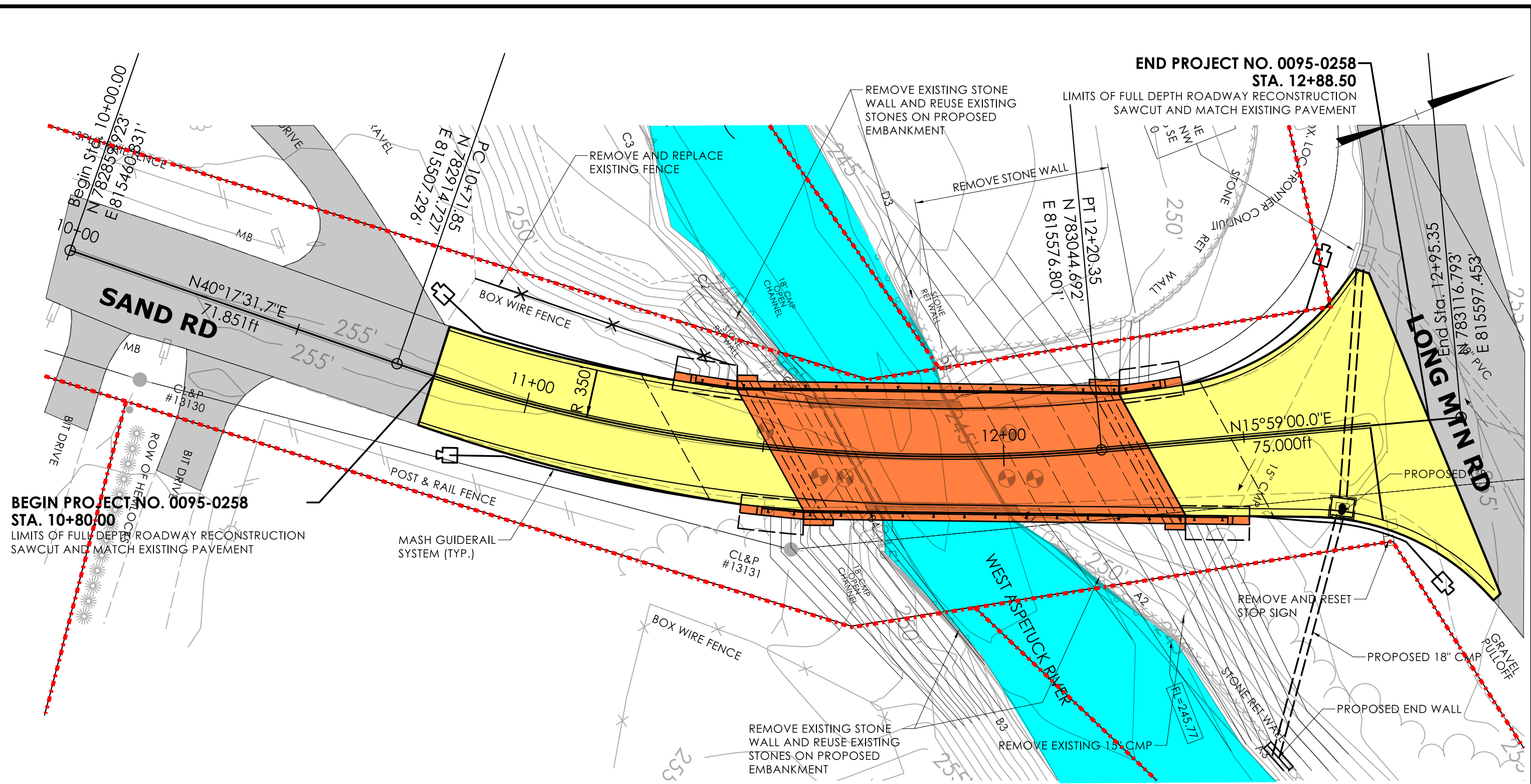

BEGIN PROJECT NO. 0095-0258
STA. 10+80.00
 LIMITS OF FULL DEPTH ROADWAY RECONSTRUCTION
 SAWCUT AND MATCH EXISTING PAVEMENT

END PROJECT NO. 0095-0258
STA. 12+88.50
 LIMITS OF FULL DEPTH ROADWAY RECONSTRUCTION
 SAWCUT AND MATCH EXISTING PAVEMENT

- PROPOSED BRIDGE
- RECONSTRUCTED PAVEMENT
- EXISTING PAVEMENT
- WATERCOURSE
- APPROX. PROPERTY LINE

PLAN
 SCALE: 1"=20'

BRIDGE REPLACEMENT	
SAND ROAD OVER WEST ASPETUCK RIVER	
PROPOSED ROADWAY PLAN	
CITY/TOWN: NEW MILFORD	BRIDGE NO. 05263
STATE PROJECT NO.: 0095-0258	DATE: 11/29/2022

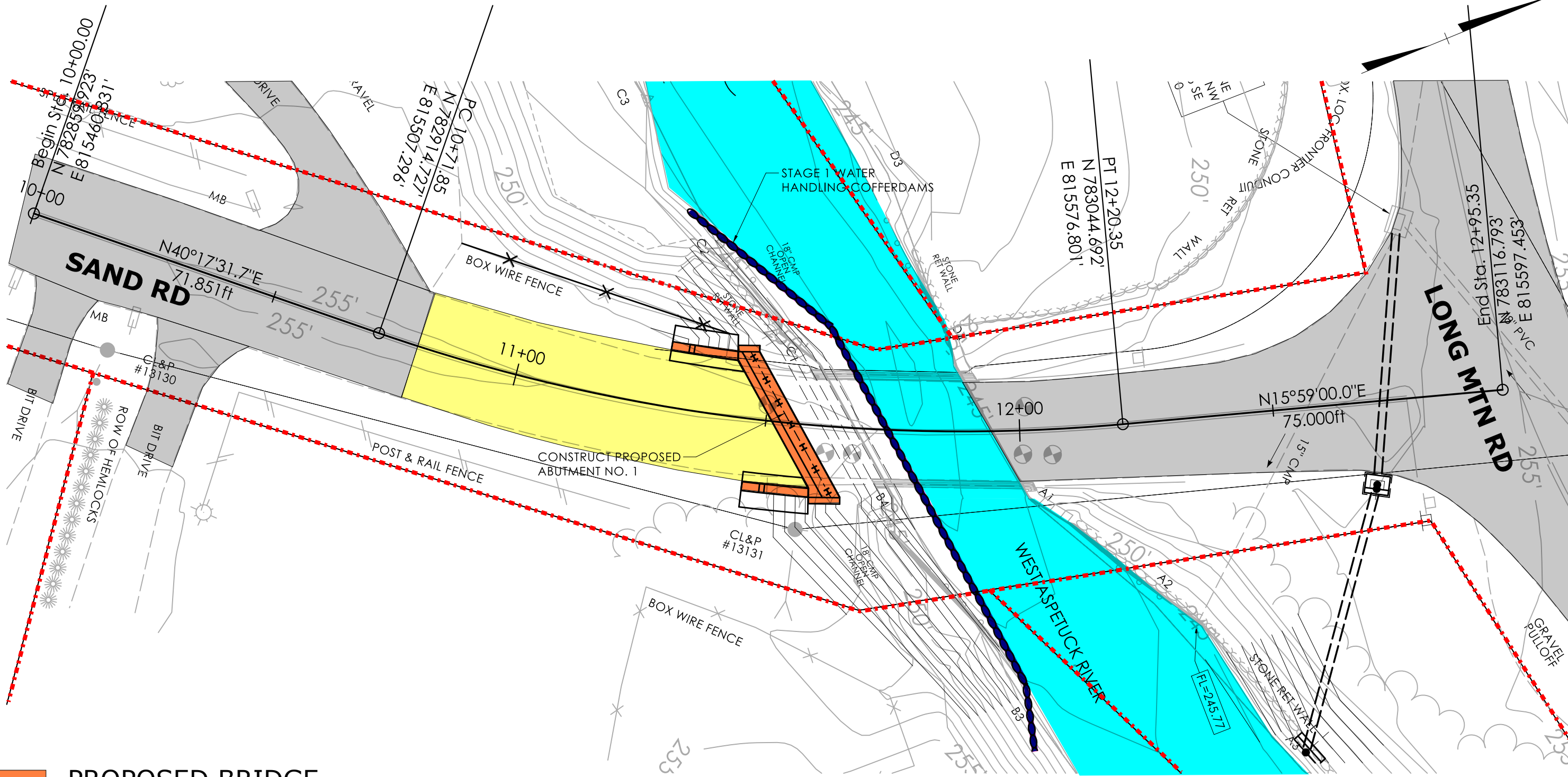

PLAN

SCALE: 1"=20'

- PROPOSED BRIDGE
- RECONSTRUCTED PAVEMENT
- TEMPORARY WATER HANDLING
- EXISTING PAVEMENT
- WATERCOURSE
- APPROX. PROPERTY LINE

BRIDGE REPLACEMENT	
SAND ROAD OVER WEST ASPETUCK RIVER	
PROPOSED WATER HANDLING - 1	
CITY/TOWN: NEW MILFORD	BRIDGE NO. 05263
STATE PROJECT NO.: 0095-0258	DATE: 11/29/2022

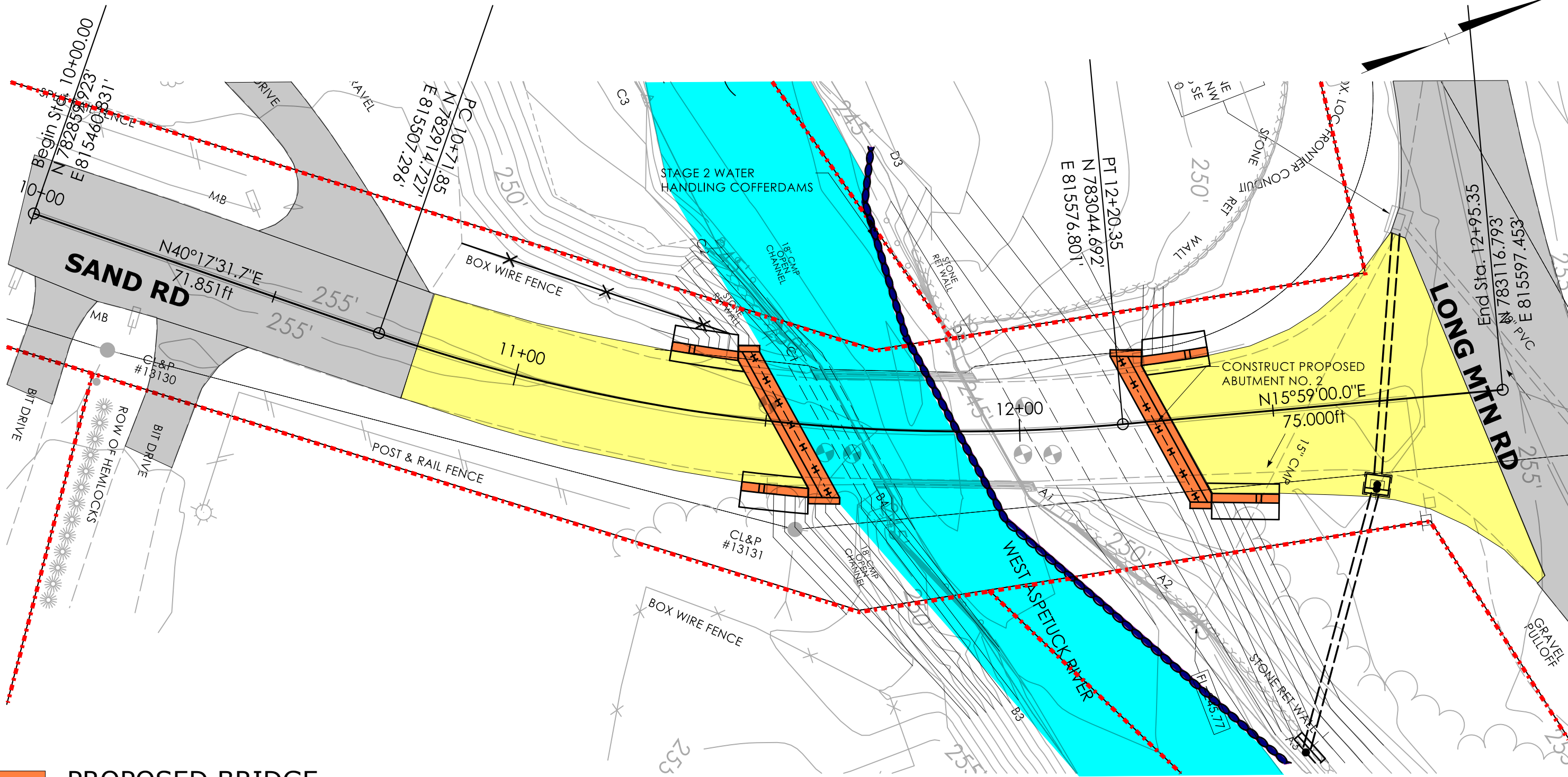

- PROPOSED BRIDGE
- RECONSTRUCTED PAVEMENT
- TEMPORARY WATER HANDLING
- EXISTING PAVEMENT
- WATERCOURSE
- APPROX. PROPERTY LINE

PLAN

SCALE: 1"=20'

BRIDGE REPLACEMENT SAND ROAD OVER WEST ASPETUCK RIVER	
PROPOSED WATER HANDLING - 2	
CITY/TOWN: NEW MILFORD	BRIDGE NO. 05263
STATE PROJECT NO.: 0095-0258	DATE: 11/29/2022

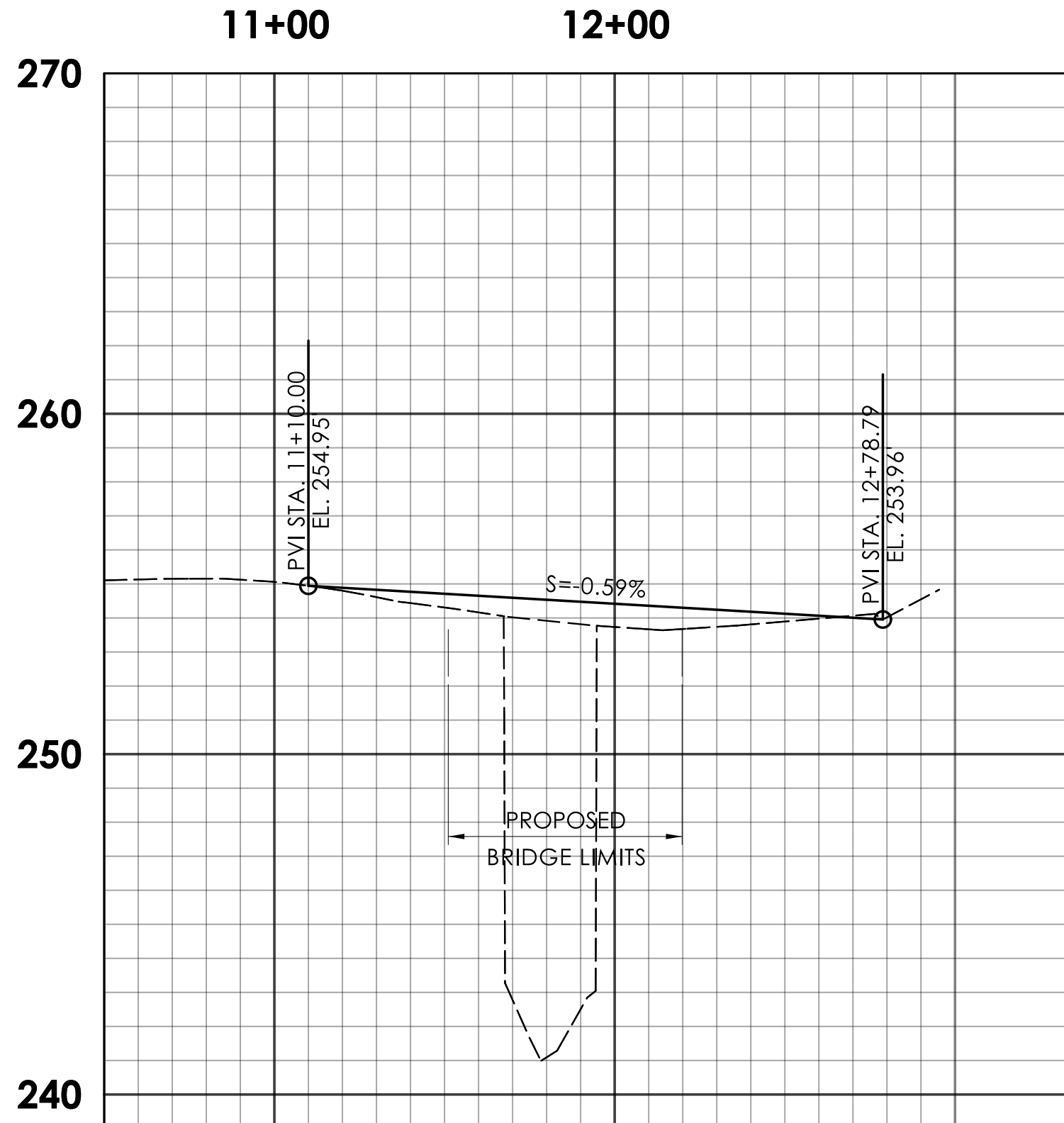

PROFILE

SCALE: 1"=40' (H)
SCALE: 1"=4' (V)

BRIDGE REPLACEMENT SAND ROAD OVER WEST ASPETUCK RIVER	
PROPOSED PROFILE	
CITY/TOWN: NEW MILFORD	BRIDGE NO. 05263
STATE PROJECT NO.: 0095-0258	DATE: 11/29/2022