

GENERAL PLAN
SCALE: 1" = 10'

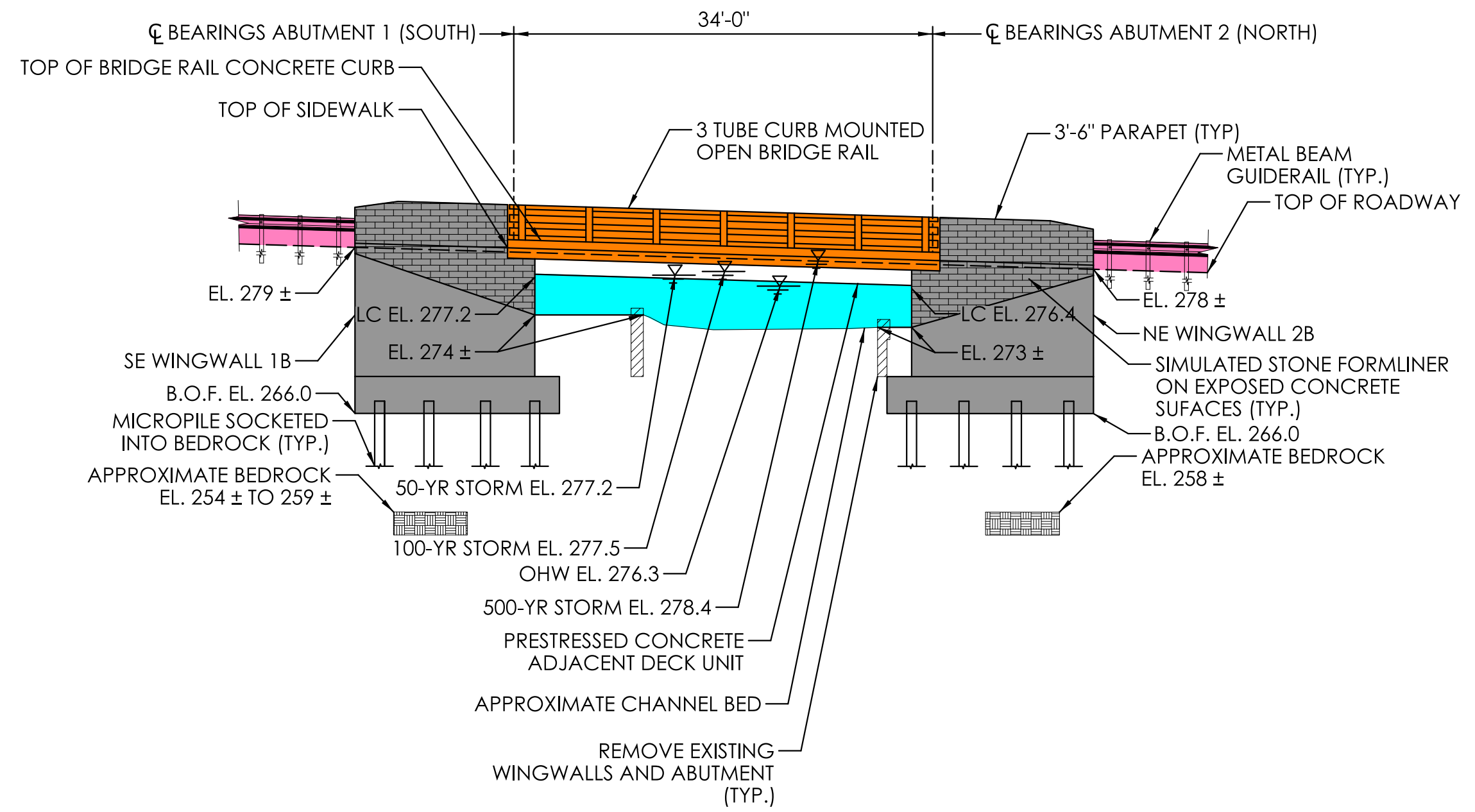

EAST ELEVATION
SCALE: 1" = 10'

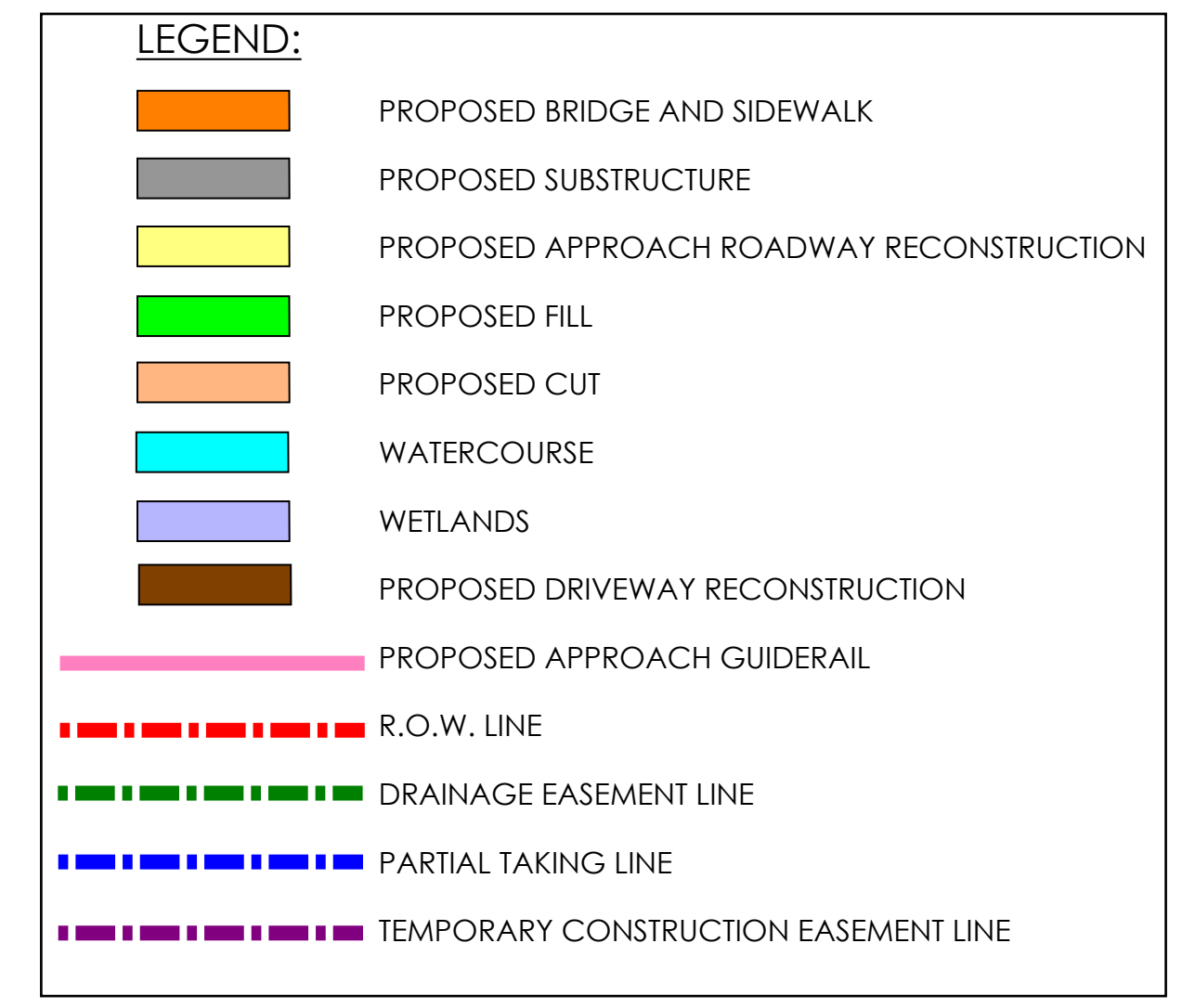
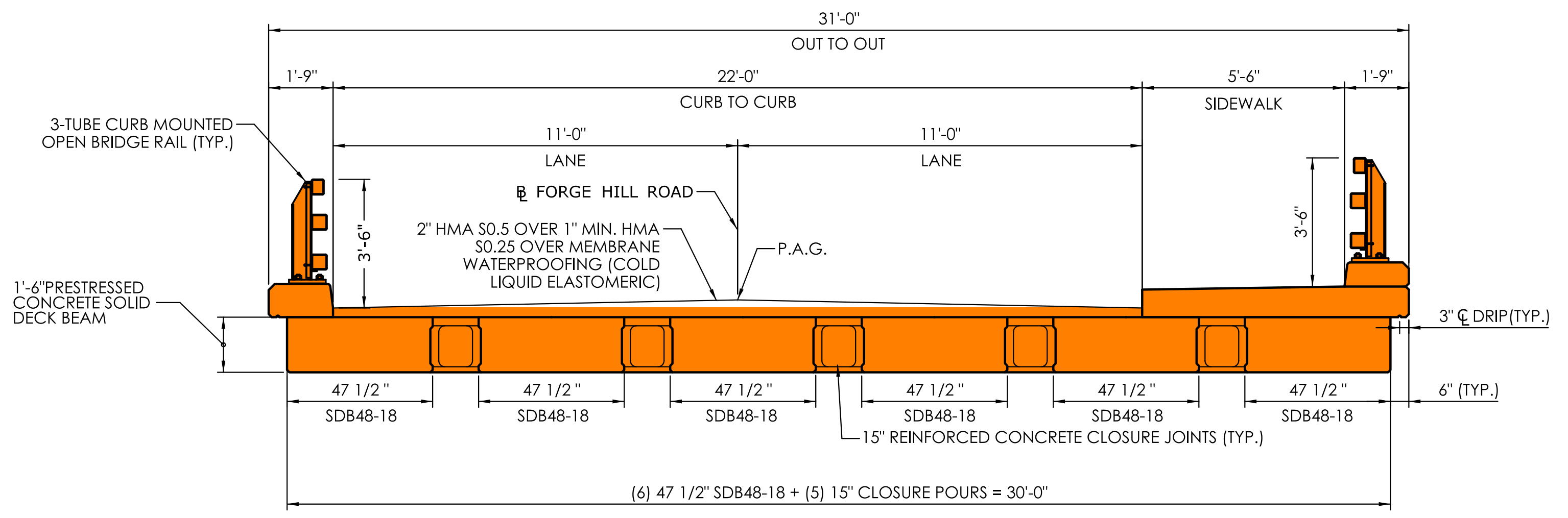

PROPOSED BRIDGE SECTION (LOOKING NORTH)
SCALE: 3/8" = 1'-0"

- LEGEND:**
- PROPOSED BRIDGE AND SIDEWALK
 - PROPOSED SUBSTRUCTURE
 - PROPOSED APPROACH ROADWAY RECONSTRUCTION
 - PROPOSED FILL
 - PROPOSED CUT
 - WATERCOURSE
 - WETLANDS
 - PROPOSED DRIVEWAY RECONSTRUCTION
 - PROPOSED APPROACH GUIDERAIL
 - R.O.W. LINE
 - DRAINAGE EASEMENT LINE
 - PARTIAL TAKING LINE
 - TEMPORARY CONSTRUCTION EASEMENT LINE

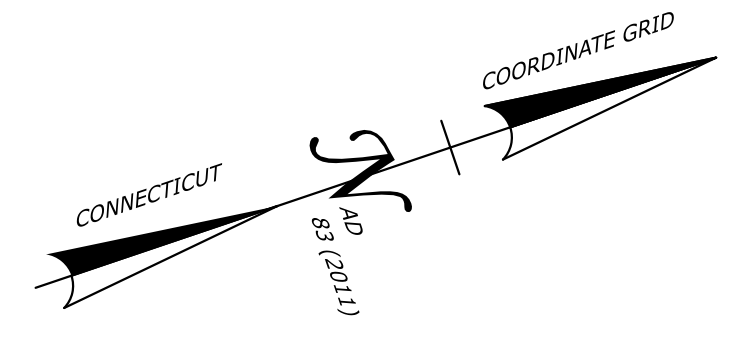

END PROJECT NO. 0147-0062
END FULL DEPTH PAVEMENT RECONSTRUCTION
CUT BITUMINOUS CONCRETE PAVEMENT
MEET EXISTING PAVEMENT
STA. 22+50
N 773951.103
E 1254032.981

NOTES:
 1. PROPOSED DRAINAGE LAYOUT SHOWN IS CONCEPTUAL. FINAL DRAINAGE DESIGN WILL BE BASED ON DRAINAGE DESIGN COMPUTATIONS.

NOTES - FORGE HILL ROAD
 ROADWAY FUNCTIONAL CLASSIFICATION: RURAL LOCAL ROAD
 POSTED SPEED LIMIT: 25 MPH
 DESIGN SPEED: 25 MPH
 EXISTING ROADWAY SECTION:
 (2) - 11' ± LANES
 NO SHOULDERS
 CROSS SLOPE, 1.5% NB 6.7% SB
 PROPOSED ROADWAY SECTION:
 (2) - 11' LANES
 NO SHOULDERS
 CROSS SLOPE, 2% - 4%
 PROPOSED STRUCTURE:
 ALT 1A - PRESTRESSED ADJACENT DECK UNIT BRIDGE
 ALT 1B - PRESTRESSED CONCRETE SOLID DECK BEAM BRIDGE
 PROFILE: MAINTAIN EXISTING
 HORIZONTAL ALIGNMENT: 14' ± SHIFT WEST (DOWNSTREAM)

CURVE DATA
FORGE HILL ROAD

CURVE #1
PI 13+09.83
DELTA 99°10'4.8"
D 67°24'25.2"
T 99.818'
L 147.118'
R 85.000'

NOTES - WYLIE SCHOOL ROAD/NORTH SHORE ROAD
 ROADWAY FUNCTIONAL CLASSIFICATION: RURAL LOCAL ROAD
 POSTED SPEED LIMIT: 25 MPH / 15 MPH
 DESIGN SPEED: 25 MPH
 EXISTING ROADWAY SECTION:
 (2) - 10' ± LANES
 NO SHOULDERS
 CROSS SLOPE, 8.0% NB 2.5% SB
 PROPOSED ROADWAY SECTION:
 (2) 10' LANES
 NO SHOULDERS
 CROSS SLOPE: 2%
 PROFILE: SLIGHT RAISE NEAR INTERSECTION
 HORIZONTAL ALIGNMENT: MAINTAIN EXISTING

CURVE #2	CURVE #3	CURVE #4
PI 22+82.73	PI 24+94.81	PI 26+68.11
DELTA 25°36'27.6"	DELTA 50°34'16.8"	DELTA 13°00'05.9"
D 14°19'26.2"	D 38°11'49.9"	D 14°19'26.2"
T 90.906'	T 70.859'	T 45.580'
L 178.775'	L 132.395'	L 90.769'
R 400.000'	R 150.000'	R 400.000'

- ROW LEGEND**
- DRAINAGE RIGHT OF WAY (D.R.O.W.) LINE
 - TAKING LINE
 - TEMPORARY CONSTRUCTION EASEMENT LINE
 - PROPERTY LINE
 - PARTIAL TAKE REQUIRED
 - EASEMENT TO SLOPE FOR THE SUPPORT OF THE HIGHWAY REQUIRED
 - EASEMENT TO SLOPE FOR THE SAFETY OF THE HIGHWAY REQUIRED
 - DRAINAGE RIGHT OF WAY (D.R.O.W.) REQUIRED
 - RIGHT TO CONSTRUCT DRIVEWAY REQUIRED
 - RIGHT TO GRADE REQUIRED
 - RIGHT TO INSTALL SEDIMENTATION CONTROL SYSTEM REQUIRED
 - TEMPORARY CONSTRUCTION EASEMENT REQUIRED

BEGIN PROJECT NO. 0147-0062
BEGIN FULL DEPTH PAVEMENT RECONSTRUCTION
CUT BITUMINOUS CONCRETE PAVEMENT
BEGIN PAVEMENT MARKINGS
STA. 11+50
N 773707.159
E 1254373.242
 N/F
 PAUL J SABROWSKI

REV.	DATE	REVISION DESCRIPTION

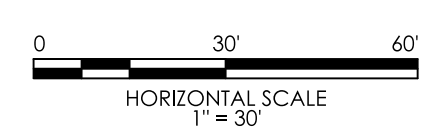

SIGNATURE/
 BLOCK:

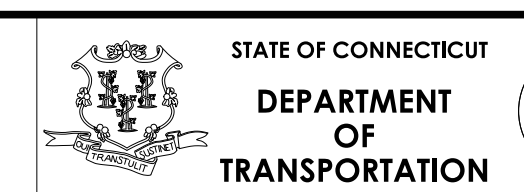

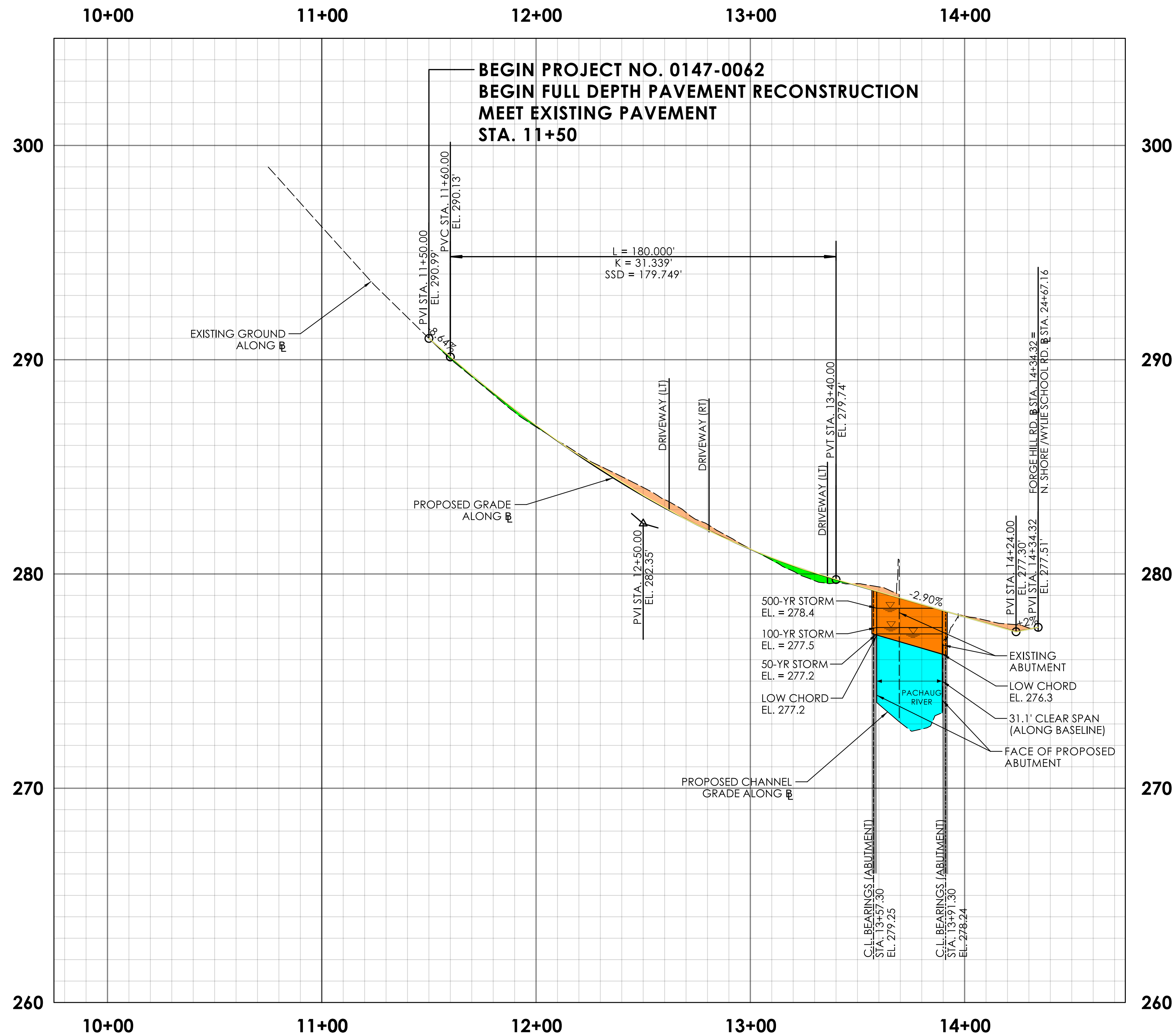

LEGEND:

- PROPOSED BRIDGE AND SIDEWALK
- PROPOSED SUBSTRUCTURE
- PROPOSED APPROACH ROADWAY RECONSTRUCTION
- PROPOSED FILL
- PROPOSED CUT
- WATERCOURSE
- WETLANDS
- PROPOSED DRIVEWAY RECONSTRUCTION
- PROPOSED APPROACH GUIDERAIL
- R.O.W. LINE
- DRAINAGE EASEMENT LINE
- PARTIAL TAKING LINE
- TEMPORARY CONSTRUCTION EASEMENT LINE

REV.	DATE	REVISION DESCRIPTION

DESIGNER/DRAFTER: MZ CHECKED BY: JDL

HORIZONTAL SCALE IN FEET: 0 30 60

VERTICAL SCALE IN FEET: 0 3 6

SIGNATURE/BLOCK:

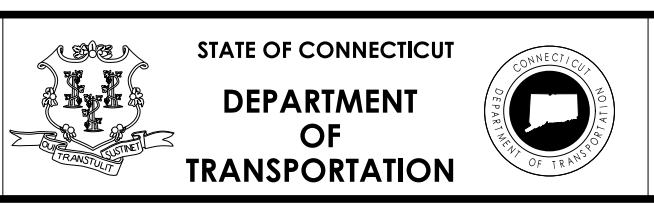

PROJECT NUMBER: 0147-0062

PROJECT DESCRIPTION: REPLACEMENT OF BRIDGE NO. 04805; FORGE HILL ROAD OVER PACHAUG RIVER

TOWN(S): VOLUNTOWN

DRAWING TITLE: ROADWAY PROFILE - FORGE HILL ROAD (ALTERNATIVE 1A & 1B)

DRAWING NO. HWY-02

SHEET NO.

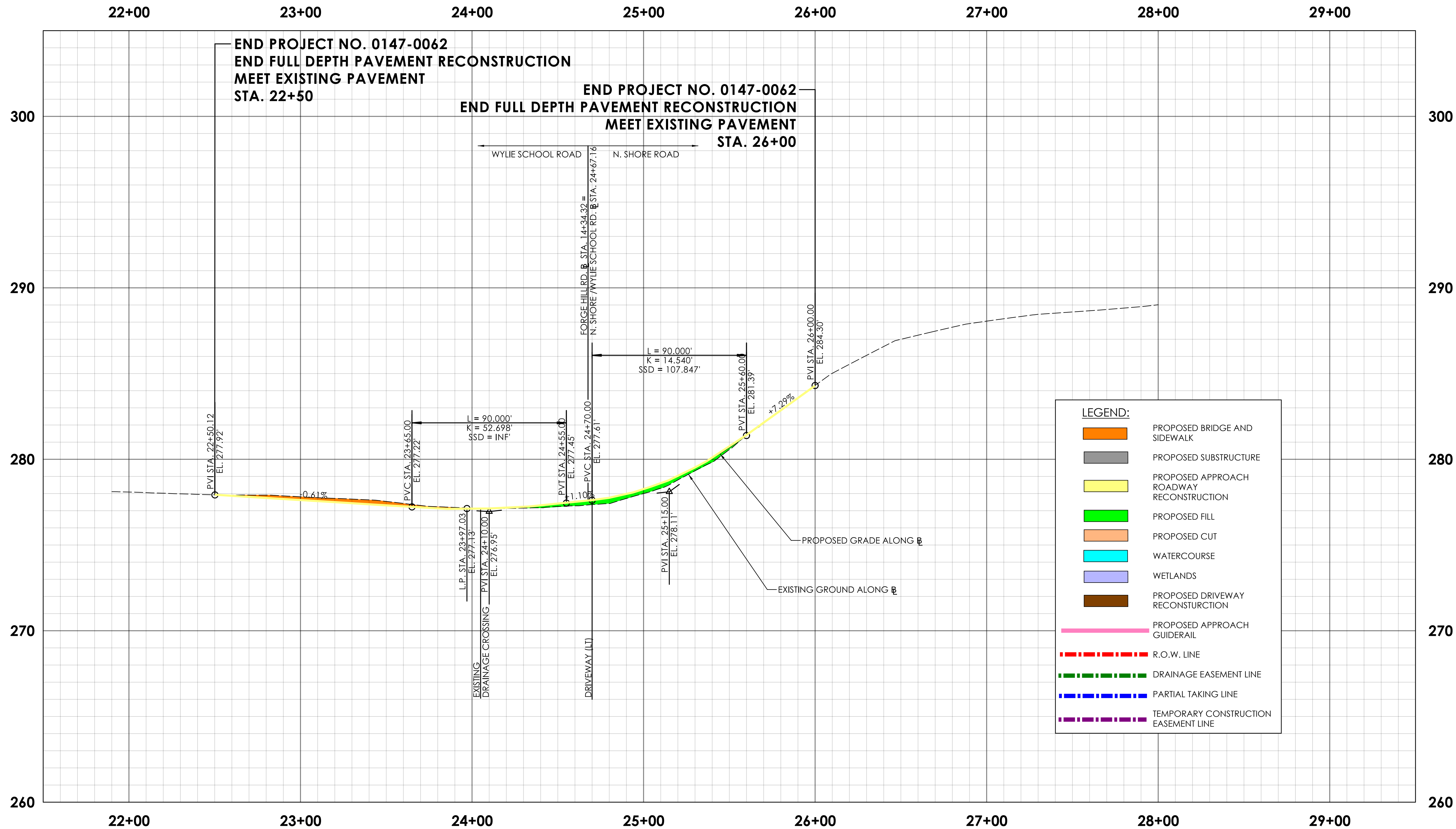

LEGEND:

	PROPOSED BRIDGE AND SIDEWALK
	PROPOSED SUBSTRUCTURE
	PROPOSED APPROACH ROADWAY RECONSTRUCTION
	PROPOSED FILL
	PROPOSED CUT
	WATERCOURSE
	WETLANDS
	PROPOSED DRIVEWAY RECONSTRUCTION
	PROPOSED APPROACH GUIDERAIL
	R.O.W. LINE
	DRAINAGE EASEMENT LINE
	PARTIAL TAKING LINE
	TEMPORARY CONSTRUCTION EASEMENT LINE

REV.	DATE	REVISION DESCRIPTION

DESIGNER/DRAFTER: MZ CHECKED BY: JDL

HORIZONTAL SCALE IN FEET: 0 30 60

VERTICAL SCALE IN FEET: 0 3 6

SIGNATURE/BLOCK:

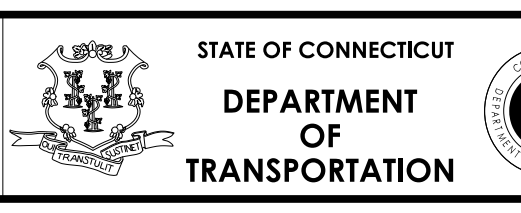

PROJECT NUMBER: 0147-0062
 PROJECT DESCRIPTION: REPLACEMENT OF BRIDGE NO. 04805; FORGE HILL ROAD OVER PACHAUG RIVER
 TOWN(S): VOLUNTOWN
 DRAWING TITLE: ROADWAY PROFILE - NORTH SHORE ROAD / WYLIE SCHOOL ROAD (ALTERNATIVE 1A & 1B)

DRAWING NO. HWY-03
 SHEET NO.

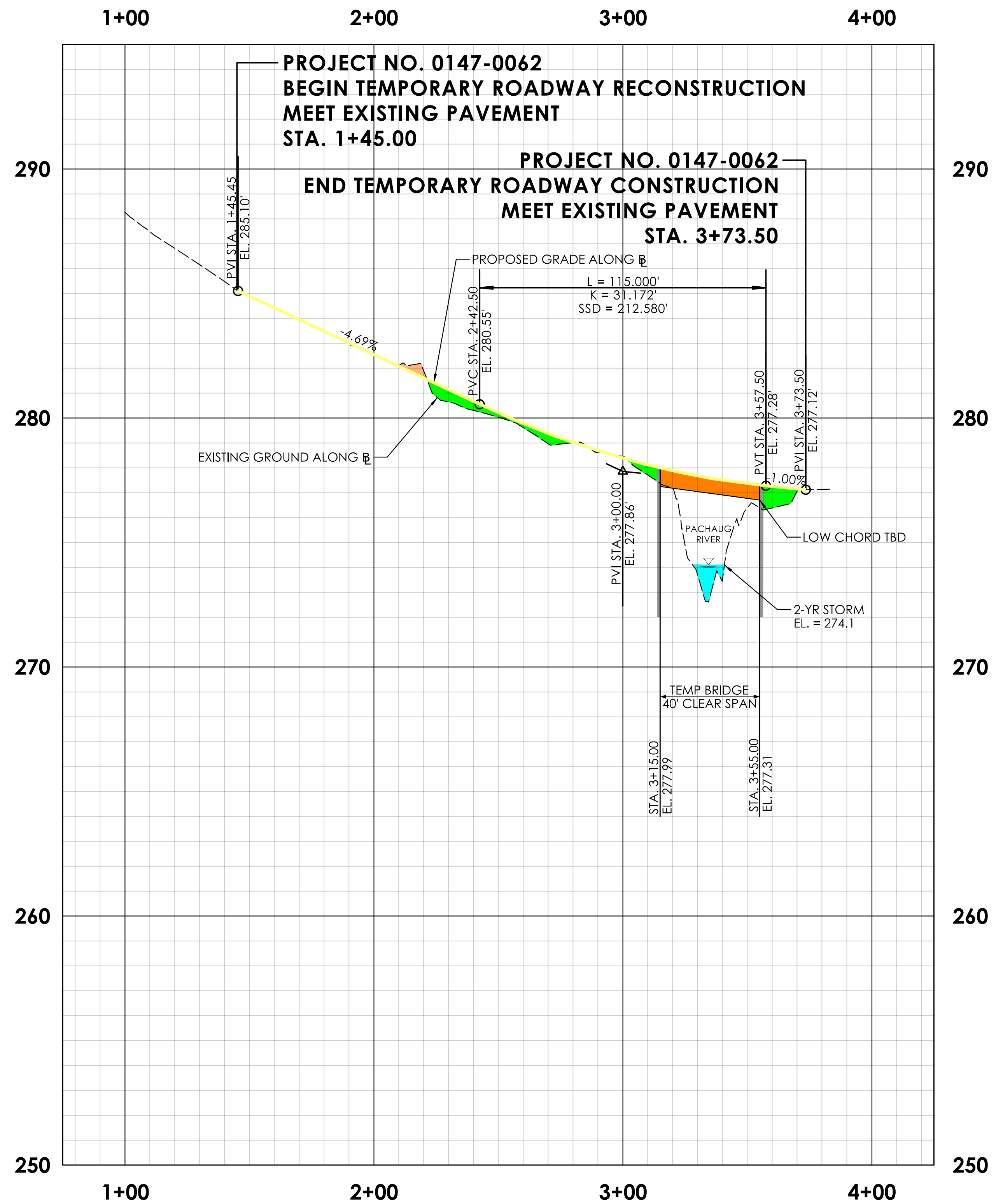

LEGEND:

- PROPOSED TEMPORARY BRIDGE
- PROPOSED TEMPORARY SUBSTRUCTURE
- PROPOSED TEMPORARY ROADWAY
- PROPOSED TEMPORARY FILL
- WATERCOURSE
- WETLANDS
- WORK AREA
- R.O.W. LINE
- TEMPORARY CONSTRUCTION EASEMENT LINE

REV.	DATE	REVISION DESCRIPTION

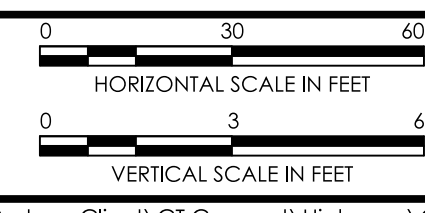

SIGNATURE/BLOCK:

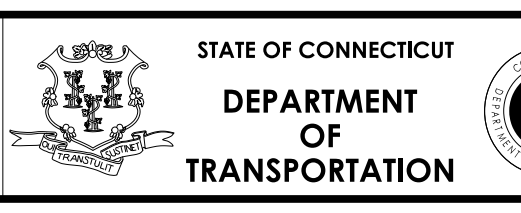

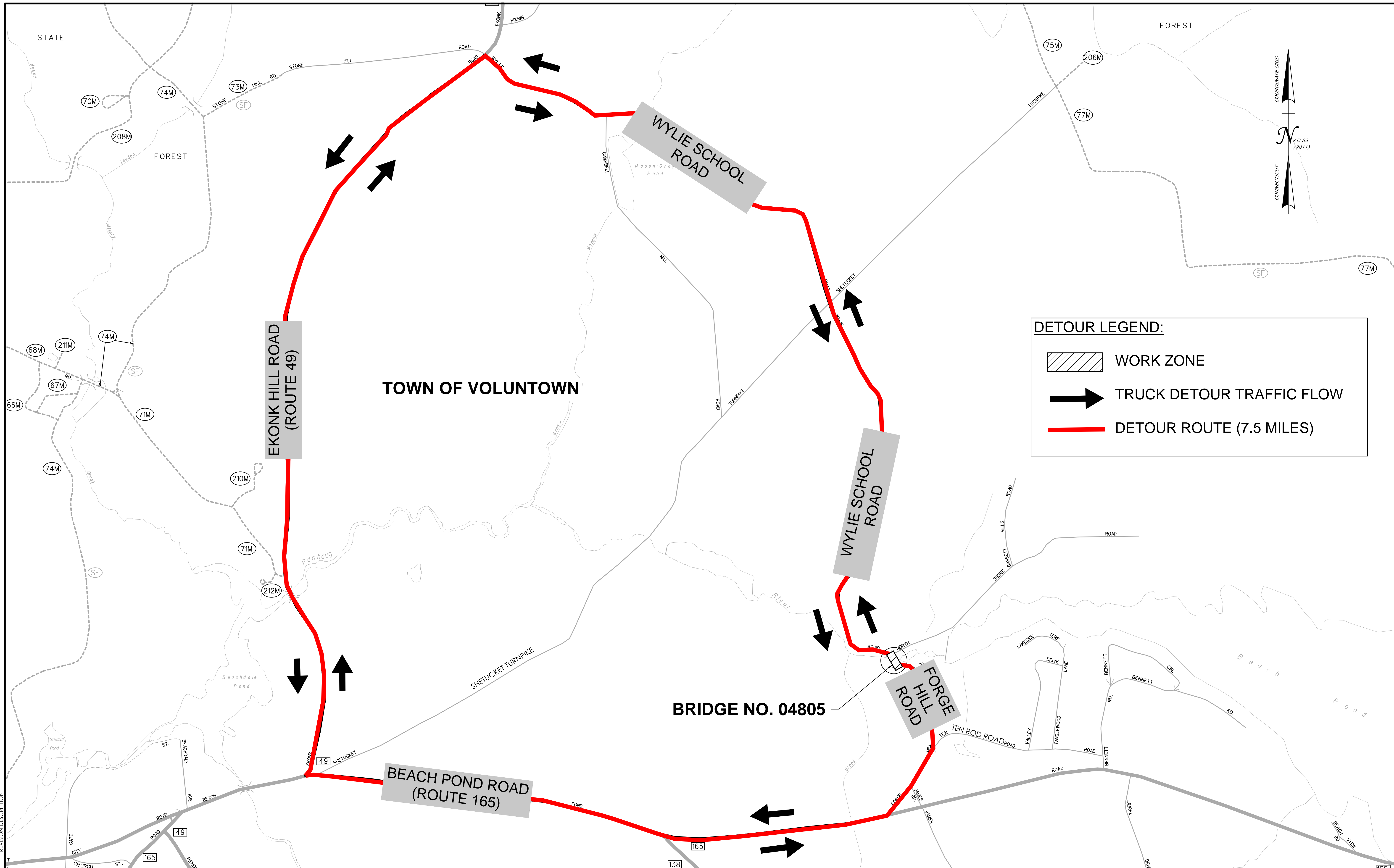

PROJECT NUMBER: 0147-0062
 PROJECT DESCRIPTION: REPLACEMENT OF BRIDGE NO. 04805; FORGE HILL ROAD OVER PACHAUG RIVER
 TOWN(S): VOLUNTOWN
 DRAWING TITLE: TEMPORARY ROADWAY PROFILE (FORGE HILL ROAD)

DRAWING NO. HWY-05
 SHEET NO.

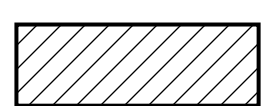

DETOUR LEGEND:

-  WORK ZONE
-  TRUCK DETOUR TRAFFIC FLOW
-  DETOUR ROUTE (7.5 MILES)

REV.	DATE	REVISION DESCRIPTION

DESIGNER/DRAFTER: MZ CHECKED BY: JDL
 HORIZONTAL SCALE: 1" = 700'
 SIGNATURE/BLOCK: _____



PROJECT NUMBER: 0147-0062
 PROJECT DESCRIPTION: REPLACEMENT OF BRIDGE NO. 04805; CARRYING FORGE HILL ROAD OVER PACHAUG RIVER
 TOWN(S): VOLUNTOWN
 DRAWING TITLE: TRUCK DETOUR PLAN - FORGE HILL ROAD (ALTERNATIVE 1A & 1B)

DRAWING NO. HWY-06
SHEET NO.