

**RELEASE AREA = 5,000± SQ. FT.**

STATE OF CONNECTICUT  
FORMERLY  
MOTOROLA COMMUNICATIONS  
AND ELECTRONICS INC.  
WARRANTY DEED  
VOL. 46, PG. 425

N/F  
MARC ALLEN  
ET AL

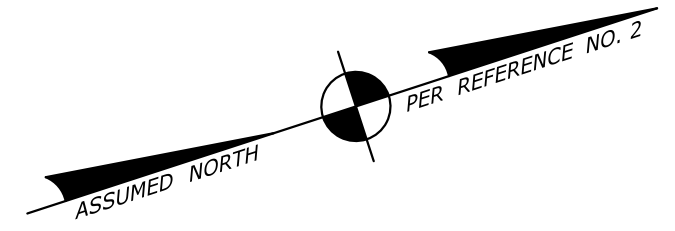

REFERENCES:

1. MAP ENTITLED: "SURVEY OF PARCEL OF LAND ON LOON MEADOW DRIVE TOWN OF NORFOLK, CONN. TO BE CONVEYED BY EDITH FORD HENRY TO MOTOROLA C. & E., INC.," SCALE 1"=20', DATED APRIL 9, 1958, PREPARED ERNEST L. DESHEFY, SURVEYOR NEW LONDON, CONN.
2. 2019 ORTHO IMAGERY

NOTES:

1. THIS COMPILATION PLAN HAS BEEN PREPARED IN ACCORDANCE WITH THE REGULATIONS OF CONNECTICUT STATE AGENCIES, SECTIONS 20-300B-1 THROUGH 20-300B-20, THE "MINIMUM STANDARDS OF ACCURACY, CONTENT & CERTIFICATION FOR SURVEYS AND MAPS," AS AMENDED OCTOBER 26, 2018. IT CONFORMS TO CLASS D ACCURACY AND IS INTENDED TO DEPICT THE LIMITS OF THE PROPERTY TRANSACTION AS NOTED HEREON. THIS PLAN WAS COMPILED FROM OTHER MAPS, RECORD RESEARCH AND/OR OTHER SOURCES OF INFORMATION. IT IS NOT TO BE CONSTRUED AS HAVING BEEN NECESSARILY OBTAINED AS THE RESULT OF A FIELD SURVEY AND IS SUBJECT TO SUCH CHANGE AS AN ACCURATE FIELD SURVEY MAY DISCLOSE.
2. THE TOPOGRAPHY AND PROPERTY LINE EVIDENCE DEPICTED ARE BASED UPON THE SURVEY/MAPPING DATA AS REFERENCED. UNLESS OTHERWISE NOTED, THESE PROPERTY/BOUNDARY LINES DO NOT REPRESENT THE PROFESSIONAL OPINION OF THE UNDERSIGNED.

N/F  
MARC ALLEN  
ET AL

N/F  
MARC ALLEN  
ET AL

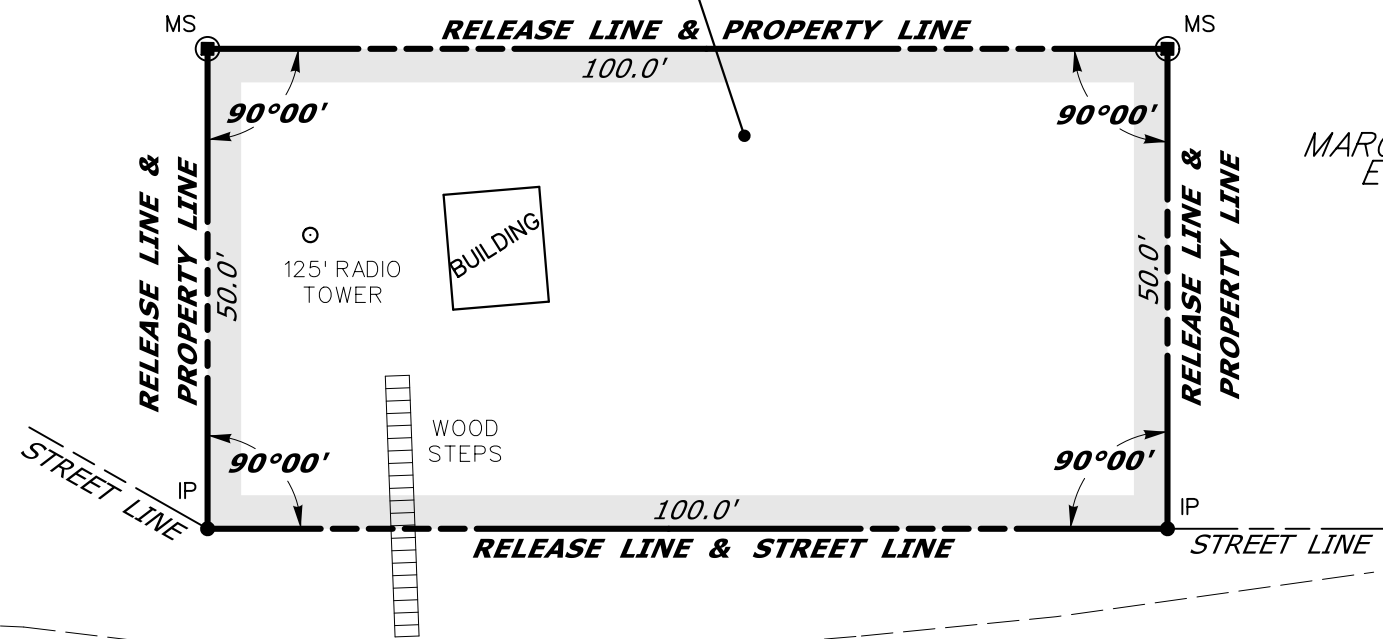

PRESENT LOON MEADOW DRIVE

TO MY KNOWLEDGE AND BELIEF, THIS MAP IS  
SUBSTANTIALLY CORRECT AS NOTED HEREON.

SCALE IN FEET



DATE	REVISION	REQ. BY

VOID WITHOUT LIVE SIGNATURE AND EMBOSSED SEAL PLS #18823

TOWN NO. 97  
PROJECT NO. 97-000 CHRISTINE E. AUBREY, P.L.S.  
SERIAL NO. 197 TITLE MANAGER - SURVEY OPERATIONS  
SHEET 1 OF 1 DATE \_\_\_\_\_

DRAWN BY DFH  
DATE 7/7/2022  
CHECKED BY TJB  
DATE 7/8/2022

**COMPILATION PLAN**

**TOWN OF NORFOLK**

**MAP SHOWING LAND RELEASED TO**

---

BY

**THE STATE OF CONNECTICUT**

DEPARTMENT OF TRANSPORTATION

**LOON MEADOW DRIVE**

SCALE 1" = 20' JULY 2022

SCOTT A. HILL, P.E.

CHIEF ENGINEER - BUREAU OF ENGINEERING AND CONSTRUCTION