

REFERENCES:

1. COMNDOT CONSTRUCTION PROJECT NO. 105-171, SHEETS 4, 53, 56, 59 AND 64 DATED 1989
2. COMNDOT CONSTRUCTION PROJECT NO. 105-172, SHEET 5, DATED 1989
3. COMNDOT CONSTRUCTION PROJECT NO. 105-130, SHEET 63-5, DATED 1994
4. COMNDOT R.O.W. MAP NO. 858, SHEETS 3 AND 4 OF 4, DATED JAN. 31, 1930
5. COMNDOT R.O.W. MAP NO. 105-11, SHEET 1 OF 5, DATED AUGUST 27, 1975
6. COMNDOT B.R.C. FILE NO. (105)104-51-1
7. COMNDOT B.R.C. FILE NO. (105)104-51-4
8. COMNDOT B.R.C. FILE NO. (105)104-51-5
9. COMNDOT B.R.C. FILE NO. (105)104-51-5A
10. COMNDOT B.R.C. FILE NO. (105)104-51-5B
11. COMNDOT B.R.C. FILE NO. (105)104-51-5C
12. COMNDOT B.R.C. FILE NO. (105)104-51-5D
13. COMNDOT B.R.C. FILE NO. (105)104-51-5E
14. COMNDOT B.R.C. FILE NO. 105-000-41
15. COMNDOT B.R.C. FILE NO. 105-000-41A
16. COMNDOT B.R.C. FILE NO. 105-109-81
17. 2016 STATEWIDE AERIAL ORTHOPHOTOGRAPHY
18. MAP ENTITLED "GENERAL LOCATION SURVEY PREPARED FOR STATE OF CONNECTICUT, DEPARTMENT OF ENVIRONMENTAL PROTECTION, OIL SPILL RESPONSE BUILDING, ESSEX ROAD - FERRY ROAD, OLD SAYBROOK, CONNECTICUT, SCALE: 1"=20', DATE: NOVEMBER 7, 2000', PREPARED BY HEALEY & ASSOCIATES



RELEASE AREA = 3.69± ACRES

SUBJECT TO CT D.E.E.P. FLOOD MANAGEMENT CERTIFICATE, LICENSE NO. 202007568-FM

EASEMENT TO DRAIN & MAINTAIN EXISTING DRAINAGE STRUCTURES RESERVED IN FAVOR OF THE STATE OF CONNECTICUT (D.O.T.) OR ITS ASSIGNS

EASEMENT TO SLOPE RESERVED IN FAVOR OF THE STATE OF CONNECTICUT (D.O.T.) OR ITS ASSIGNS

ACCESS EASEMENT FOR MAINTENANCE OF EXISTING WALKWAY & BICYCLE PATH RESERVED IN FAVOR OF STATE OF CONNECTICUT (D.O.T.) OR ITS ASSIGNS

STATE OF CONNECTICUT
FORMERLY
MITCHELL SACHLOS
WARRANTEE DEED
VOL. 53, PG. 321
(105)104-51-5

STATE OF CONNECTICUT
FORMERLY
FLORENCE R. STOKES
WARRANTEE DEED
VOL. 52, PG. 552
(105)104-51-4

STATE OF CONNECTICUT
FORMERLY
ENOCH C. RICHARDSON
QUIT-CLAIM DEED
VOL. 54, PG. 255
(105)104-51-1

GRANTED TO D.E.E.P. BY
SECTION 13b-23 OF THE
GENERAL STATUTES OF CT,
10/23/1997
104-51-5B

STATE OF CONNECTICUT
FORMERLY
FLORENCE RICHARDSON STOKES
WARRANTEE DEED
VOL. 27, PG. 26
105-MISC-41

NOTES:

1. THIS COMPILATION PLAN HAS BEEN PREPARED IN ACCORDANCE WITH THE REGULATIONS OF CONNECTICUT STATE AGENCIES, SECTIONS 20-300B-1 THROUGH 20-300B-20, AND THE STANDARDS FOR SURVEYS AND MAPS IN THE STATE OF CONNECTICUT AS ADOPTED BY THE CONNECTICUT ASSOCIATION OF LAND SURVEYORS, INC. ON SEPTEMBER 26, 1996. IT CONFORMS TO CLASS D ACCURACY AND IS INTENDED TO DEPICT THE LIMITS OF PROPERTY TRANSACTION AS NOTED HEREON. THIS PLAN WAS COMPILED FROM OTHER MAPS, RECORD RESEARCH, AND/OR OTHER SOURCES OF INFORMATION. IT IS NOT TO BE CONSTRUED AS HAVING BEEN NECESSARILY OBTAINED AS THE RESULT OF A FIELD SURVEY AND IS SUBJECT TO SUCH CHANGE AS AN ACCURATE FIELD SURVEY MAY DISCLOSE.
2. THE TOPOGRAPHY AND PROPERTY LINE EVIDENCE DEPICTED ARE BASED UPON THE SURVEY/MAPPING DATA AS REFERENCED. UNLESS OTHERWISE NOTED, THESE PROPERTY/BOUNDARY LINES DO NOT REPRESENT THE PROFESSIONAL OPINION OF THE UNDERSIGNED.
3. MUCH OF THE TOPOGRAPHY DEPICTED HEREON WAS COMPILED FROM THE 2016 STATEWIDE AERIAL ORTHOPHOTOGRAPHY, AND SHOULD BE CONSIDERED APPROXIMATE.
4. THERE IS A WALKWAY/BIKEPATH THAT RUNS THROUGH THIS PARCEL. PUBLIC ACCESS & MAINTENANCE OF THIS TRANSPORTATION FACILITY SHALL NOT BE IMPEDED BY ANY FUTURE USE OF THIS PARCEL.
5. 100 YR. & 500 YR. FLOOD ZONE LIMITS & FLOODWAY AREA IN ZONE AE (BASE FLOOD ELEVATIONS DETERMINED) HAS BEEN DIGITIZED FROM FIRM PANEL 09007C0353 AND SHOULD BE CONSIDERED APPROXIMATE.

DRAWN BY LAL
DATE 8/2019
CHECKED BY CEA
DATE 8/2019

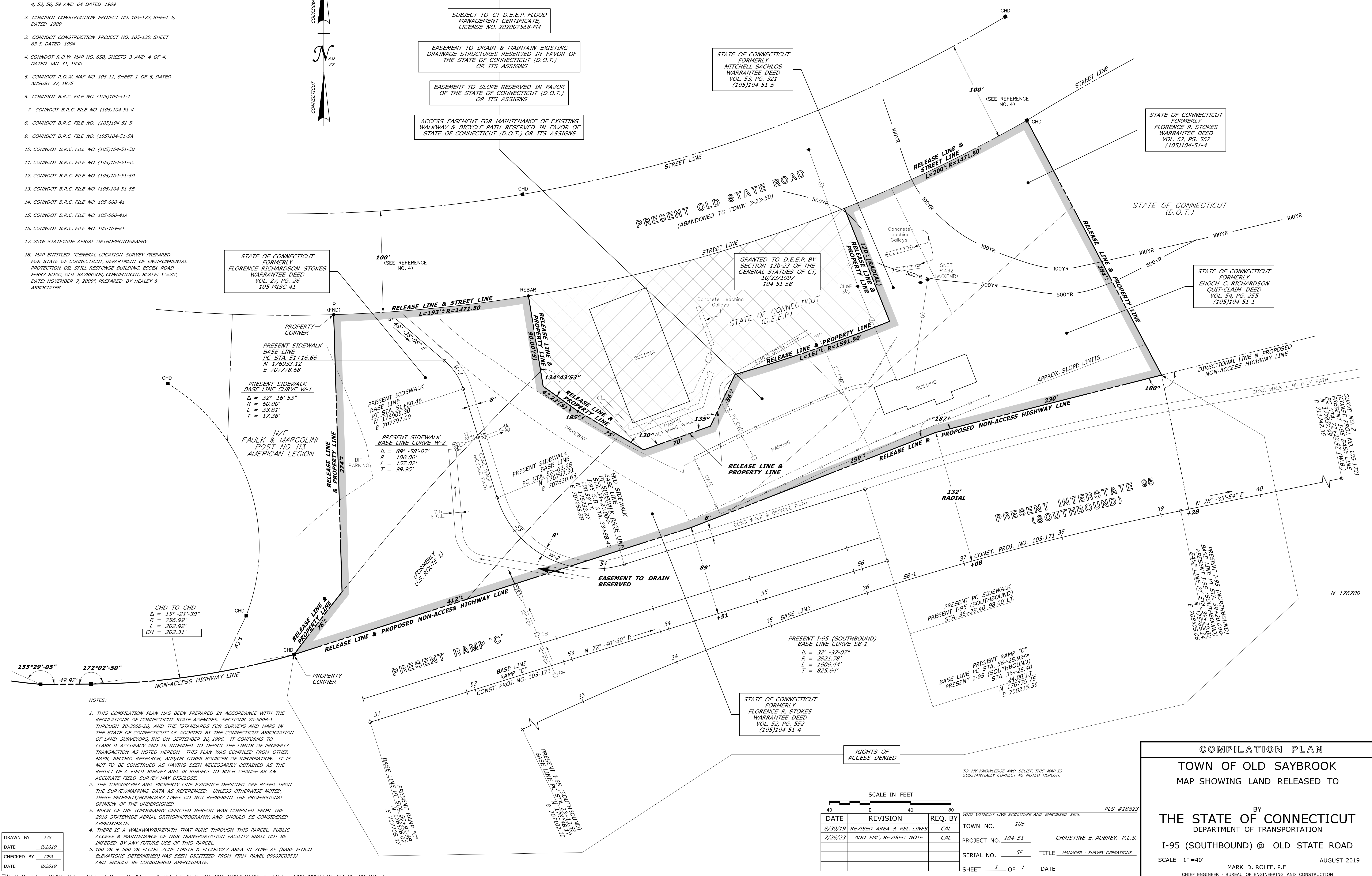

SCALE IN FEET

DATE	REVISION	REQ. BY
8/30/19	REVISED AREA & REL. LINES	CAL
7/26/23	ADD FMC, REVISED NOTE	CAL

TO MY KNOWLEDGE AND BELIEF THIS MAP IS SUBSTANTIALLY CORRECT AS NOTED HEREON.

PLS #18823

VOID WITHOUT LIVE SIGNATURE AND EMBOSSED SEAL

TOWN NO. 105

PROJECT NO. 104-51

SERIAL NO. 5F

SHEET 1 OF 1

DATE

CHRISTINE E. AUBREY, P.L.S.

TITLE: MANAGER - SURVEY OPERATIONS

COMPILED PLAN

TOWN OF OLD SAYBROOK

MAP SHOWING LAND RELEASED TO

BY

THE STATE OF CONNECTICUT

DEPARTMENT OF TRANSPORTATION

I-95 (SOUTHBOUND) @ OLD STATE ROAD

SCALE 1"=40'

AUGUST 2019

MARK D. ROLFE, P.E.

CHIEF ENGINEER - BUREAU OF ENGINEERING AND CONSTRUCTION