

Site Vicinity Map  
SCALE: 1"=1,000'

NOTES:

- Existing and proposed conditions are taken from plans prepared by the LRC Group revised through February 14, 2011. Off-site conditions have been supplemented with record as-built, traffic control signal plans and pavement marking plans.
- All construction materials and methods shall conform with the State of Connecticut Department of Transportation Standard Specifications for Road, Bridges, and Incidental Construction Form 816, as revised.
- Removal of pavement markings along State roadways shall be completed by a non-destructive method in compliance with the State of Connecticut Department of Transportation Standard Specifications for Road, Bridges, and Incidental Construction Form 816 Section 12.11 as revised.
- New pavement markings shall be painted with epoxy resin paint in compliance with the State of Connecticut Department of Transportation Standard Specifications for Road, Bridges, and Incidental Construction Form 816 Section 12.10 as revised. Pavement markings shall be installed in accordance with Standard Sheet 1210-03.
- New sign material and sheeting shall be made of reflective material in compliance with the State of Connecticut Department of Transportation Standard Specifications for Road, Bridges, and Incidental Construction Form 816 Section 12.08 as revised. Signs shall be installed in accordance with State Details TR-626-K, TR-625-1 and TR-625-2 and Standard Sheets TR-1208-01 and TR-1208-02.
- All signs and pavement markings installed along the State road must conform to the Manual on Uniform Traffic Control Devices (Millennium Edition), the latest State of Connecticut Catalog of Signs and standard sheets as revised.
- Any damage to the existing curb, sidewalk or any other highway appurtenances during development of the permitted site will be replaced by the Contractor as directed by the District 1 Permit Section at no cost to the State.
- All work within the State right-of-way shall comply with the State of Connecticut Department of Transportation Standard Specifications for Road, Bridges, and Incidental Construction Form 816 with the latest Special Provisions and Typical State Standard Details.
- The Contractor shall obtain an Encroachment Permit from the State of Connecticut Department of Transportation District 1 Office in Rocky Hill, Connecticut. The Contractor shall provide the required surety bond and insurance certificates. The developer will pay all application fees.
- The Contractor or developer shall stake the right-of-way adjacent to the proposed work prior to commencement of roadway construction to avoid work on and impacts to private property.
- The Contractor shall furnish and install traffic control signals and pavement markings as shown on this plan. Sign materials and installation shall conform to the standards of the State Traffic Commission and the FHWA's Manual on Uniform Traffic Control Devices. Pavement markings shall be fast-drying epoxy resin.
- Intersection Sight Lines are depicted based on 85th percentile speed data provided from the ConnDOT. The 85th percentile (design) speed for State Route 30 (Ellington Road) is 44 mph and for State Route 194 (Sullivan Avenue) is 48 mph. The 85th percentile speed data is the suggested values contained in the ConnDOT Highway Design Manual, 2003.

TRAFFIC CONTROL SIGNS					
SIGN NO./ConnDOT NO.	STATUS	LEGEND	SIGN NO./ConnDOT NO.	STATUS	LEGEND
A	31-0222	EXISTING	P	31-5505	EXISTING
B	31-0307	EXISTING	Q	31-0223	EXISTING
C	31-0817	EXISTING	R	31-0552	TO BE INSTALLED BY DEVELOPER
D	31-0135	EXISTING	S	31-1120	TO BE INSTALLED BY DEVELOPER
E	31-5505	EXISTING	T	31-1819	TO BE INSTALLED BY DEVELOPER
F	31-0552	EXISTING	U	31-1620	TO BE INSTALLED BY DEVELOPER
G	31-0552	EXISTING	V	31-0118	TO BE INSTALLED BY DEVELOPER
H	31-0302	EXISTING	W	31-1528	TO BE INSTALLED BY DEVELOPER
I	31-0509	EXISTING	X	31-0830-D	TO BE INSTALLED BY DEVELOPER
J	31-1112	EXISTING	Y	31-0828	TO BE INSTALLED BY DEVELOPER
K	31-0552	EXISTING	Z	41-4441	EXISTING
L	41-4327	EXISTING	AA	31-0371	TO BE INSTALLED BY DEVELOPER
M	31-5505	EXISTING			
N	31-0552	EXISTING			
O	31-1601	EXISTING			

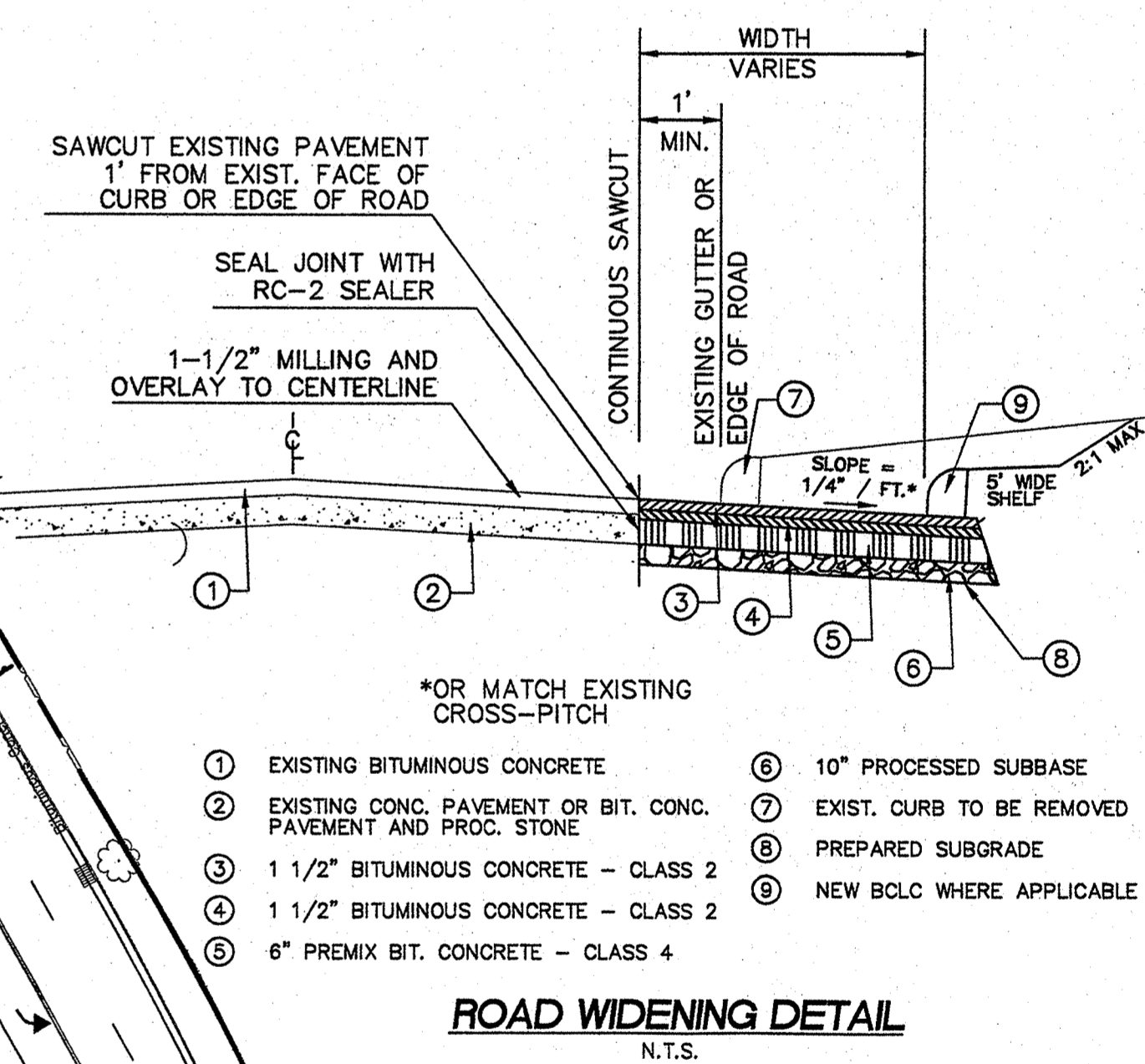
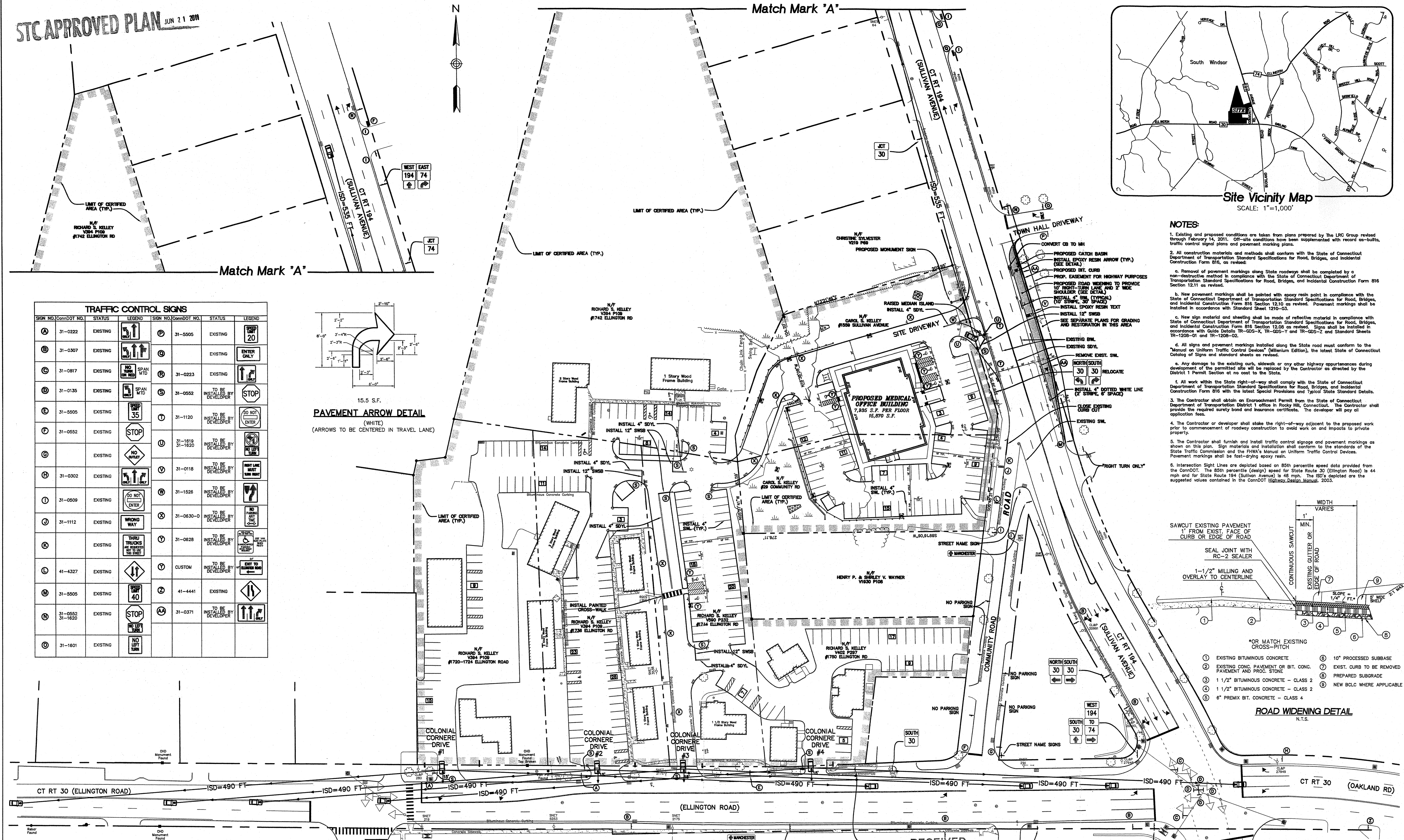
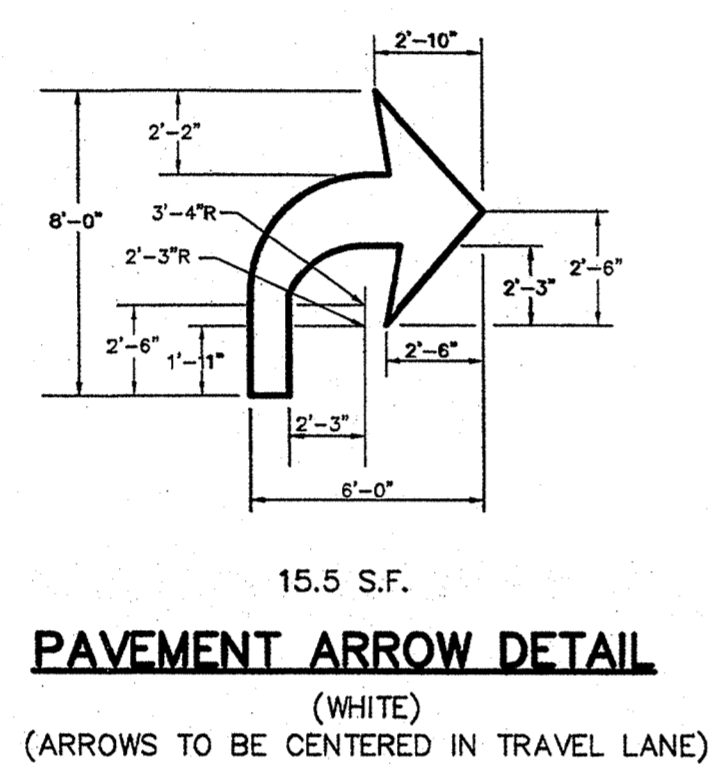

STRIPING LEGEND:		SHADE LEGEND:	
SDYL - 4" SOLID DOUBLE YELLOW LINE		[Shaded Area]	AREA OF FULL DEPTH ROAD WIDENING BY DEVELOPER
SWBD - SOLID WHITE STOP BAR		[Stippled Area]	EXISTING INLAND WETLAND SOILS
SWL - 4" SOLID WHITE LINE			
BWL - 4" BROKEN WHITE LINE			
SYL - 4" SOLID YELLOW LINE			

NO.	DATE	DESCRIPTION
2	6/10/11	PER CDOT TRAFFIC DIV. COMMENTS
1	6/3/11	PER S.T.C. COMMENTS
#		

**Robert V. Baltramaitis, P.E.**  
Consulting Engineer  
27 Tammy Hill Road  
Wallingford, Connecticut 06492  
(203) 915-8301, balro@aol.com

**TRAFFIC CONTROL PLAN**  
"Colonial Centers" and Proposed Medical Office  
#1720-1724, 1736, 1742, 1744, 1750 Ellington Road (CT RT 30)  
#1559 Sullivan Avenue (CT RT 194)  
#29 Community Road  
South Windsor, Connecticut

DATE: March 18, 2011  
SCALE: 1"=40'  
DRAWN: R.V.B.  
APPROVED: R.V.B.  
TCP-1

