

01.10.01 - RAILROAD INDEX OF SUBSETS

DRAWING NUMBER	DRAWING TITLE	DRAWING NUMBER	DRAWING TITLE
01.10.01	INDEX OF SUBSETS		
01.10.02	RAILROAD PLANS		

DESIGNED BY:

LOCHNER
H.W. LOCHNER, INC
 55 Hartland Street
 East Hartford, CT 06108

01.10.02 - RAILROAD PLANS

INDEX OF DRAWINGS

DRAWING NUMBER	DRAWING TITLE	DRAWING NUMBER	DRAWING TITLE
IND-01	INDEX OF DRAWINGS		
RRP-01	PROPOSED RAILROAD CROSSING PLAN		
RRP-02	PROPOSED RAILROAD CROSSING PROFILE		
RRP-03	RAILROAD CROSSING DETAILS		
RRP-04	RAILROAD CROSSING DETAILS		
RRP-05	TEMPORARY RAILROAD CROSSING PLAN		
RRP-06	TEMPORARY RAILROAD CROSSING PROFILE		
RRP-07	RAILROAD CLEARANCE DIAGRAM		
RRP-08	EXISTING RAILROAD CROSSING PLAN		

<p style="font-size: x-small;">THE INFORMATION, INCLUDING ESTIMATED QUANTITIES OF WORK, SHOWN ON THESE SHEETS IS BASED ON LIMITED INVESTIGATIONS BY THE STATE AND IS IN NO WAY WARRANTED TO INDICATE THE CONDITIONS OF ACTUAL QUANTITIES OF WORK WHICH WILL BE REQUIRED.</p>				DESIGNER/DRAFTER: CHECKED BY:		STATE OF CONNECTICUT DEPARTMENT OF TRANSPORTATION		LOCHNER H.W. LOCHNER, INC. 55 Hartland Street Suite 401 East Hartford, CT 06108		PROJECT TITLE: RELOCATION OF I-91 NB INTERCHANGE 29 AND WIDENING OF I-91 NB AND ROUTE 15 NB TO I-84 EB			CITY/TOWN: HARTFORD EAST HARTFORD		PROJECT NO. 63-703	
											DRAWING TITLE: INDEX OF DRAWINGS		DRAWING NO. IND-01			
REV.	DATE	REVISION DESCRIPTION	SHEET NO.	Plotted Date: 7/10/2018		Filename: ...\\HW_MSH_0603_0703_01-10_INX.dgn					SHEET NO. 01.10.02.01					

CURVE DATA
RAILROAD CROSSING

(48)
$\Delta = 13^\circ 35'12.1''$
$T = 48.54'$
$L = 96.63'$
$R = 407.50'$
PI N 834643.49
E 1025255.73
PI STA 10+48.54

CURVE DATA
RAILROAD CROSSING

(49)
$\Delta = 25^\circ 01'37.2''$
$T = 107.09'$
$L = 210.76'$
$R = 482.5'$
PI N 834510.77
E 1025337.01
PI STA 12+03.72

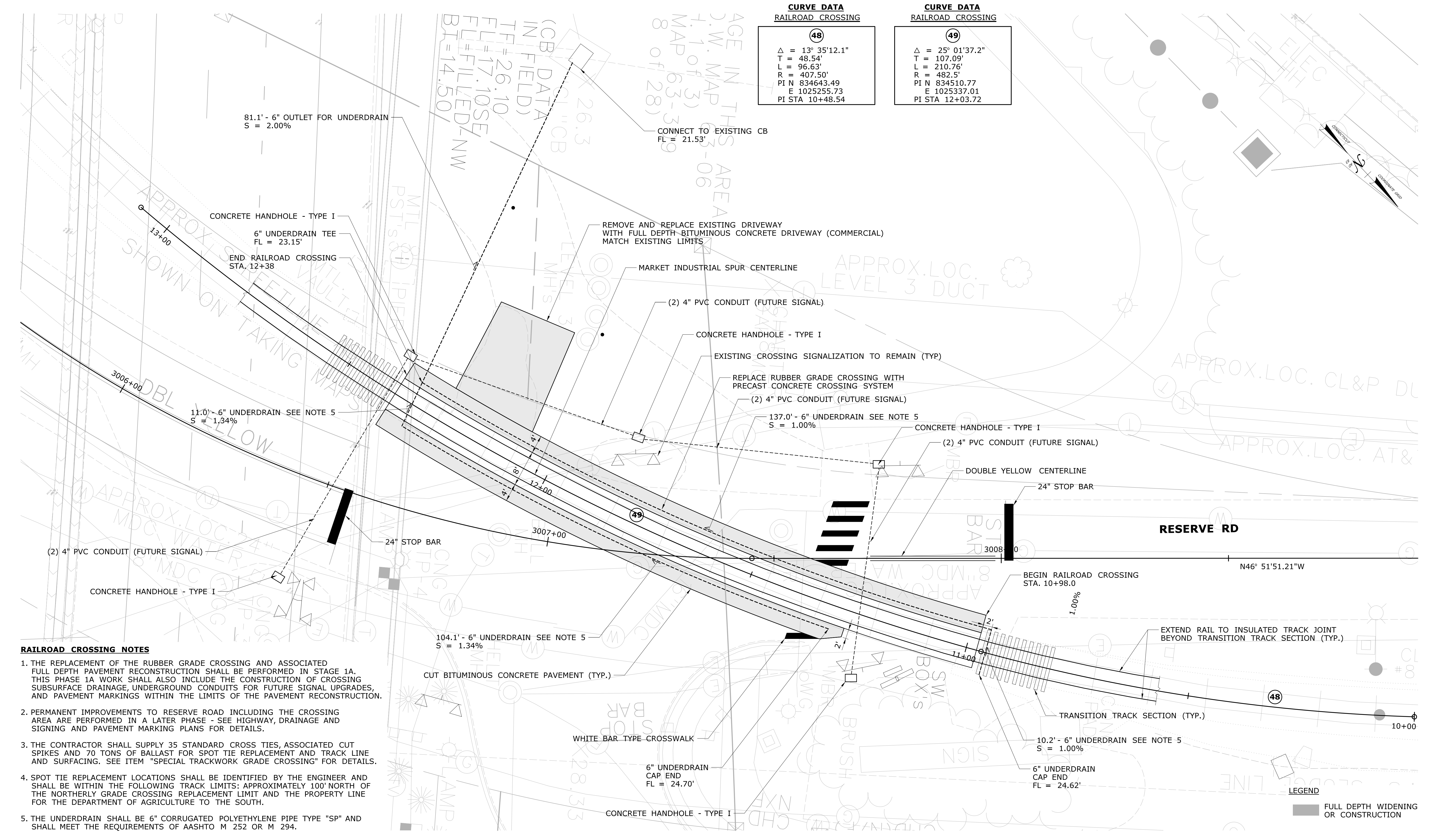

- RAILROAD CROSSING NOTES**
1. THE REPLACEMENT OF THE RUBBER GRADE CROSSING AND ASSOCIATED FULL DEPTH PAVEMENT RECONSTRUCTION SHALL BE PERFORMED IN STAGE 1A. THIS PHASE 1A WORK SHALL ALSO INCLUDE THE CONSTRUCTION OF CROSSING SUBSURFACE DRAINAGE, UNDERGROUND CONDUITS FOR FUTURE SIGNAL UPGRADES, AND PAVEMENT MARKINGS WITHIN THE LIMITS OF THE PAVEMENT RECONSTRUCTION.
 2. PERMANENT IMPROVEMENTS TO RESERVE ROAD INCLUDING THE CROSSING AREA ARE PERFORMED IN A LATER PHASE - SEE HIGHWAY, DRAINAGE AND SIGNING AND PAVEMENT MARKING PLANS FOR DETAILS.
 3. THE CONTRACTOR SHALL SUPPLY 35 STANDARD CROSS TIES, ASSOCIATED CUT SPIKES AND 70 TONS OF BALLAST FOR SPOT TIE REPLACEMENT AND TRACK LINE AND SURFACING. SEE ITEM "SPECIAL TRACKWORK GRADE CROSSING" FOR DETAILS.
 4. SPOT TIE REPLACEMENT LOCATIONS SHALL BE IDENTIFIED BY THE ENGINEER AND SHALL BE WITHIN THE FOLLOWING TRACK LIMITS: APPROXIMATELY 100' NORTH OF THE NORTHERLY GRADE CROSSING REPLACEMENT LIMIT AND THE PROPERTY LINE FOR THE DEPARTMENT OF AGRICULTURE TO THE SOUTH.
 5. THE UNDERDRAIN SHALL BE 6" CORRUGATED POLYETHYLENE PIPE TYPE "SP" AND SHALL MEET THE REQUIREMENTS OF AASHTO M 252 OR M 294.

LEGEND
 FULL DEPTH WIDENING OR CONSTRUCTION

REV.	DATE	REVISION DESCRIPTION	SHEET NO.	Plotted Date: 7/10/2018

DESIGNER/DRAFTER: K. MCDYER
 CHECKED BY: S. WEXELL
 SCALE IN FEET
 SCALE 1"=10'
 STATE OF CONNECTICUT
 DEPARTMENT OF TRANSPORTATION
 File name: ...VHW_MSH_0063_0703_01-10_RRP-01.dgn

LOCHNER
 H.W. LOCHNER, INC.
 55 Hartland Street
 Suite 401
 East Hartford, CT 06108

PROJECT TITLE:
RELOCATION OF I-91 NB INTERCHANGE 29 AND WIDENING OF I-91 NB AND ROUTE 15 NB TO I-84 EB

CITY/TOWN: **HARTFORD EAST HARTFORD**
 DRAWING TITLE:
PROPOSED RAILROAD CROSSING PLAN

PROJECT NO.: **63-703**
 DRAWING NO.: **RRP-01**
 SHEET NO.: **01.10.02.02**

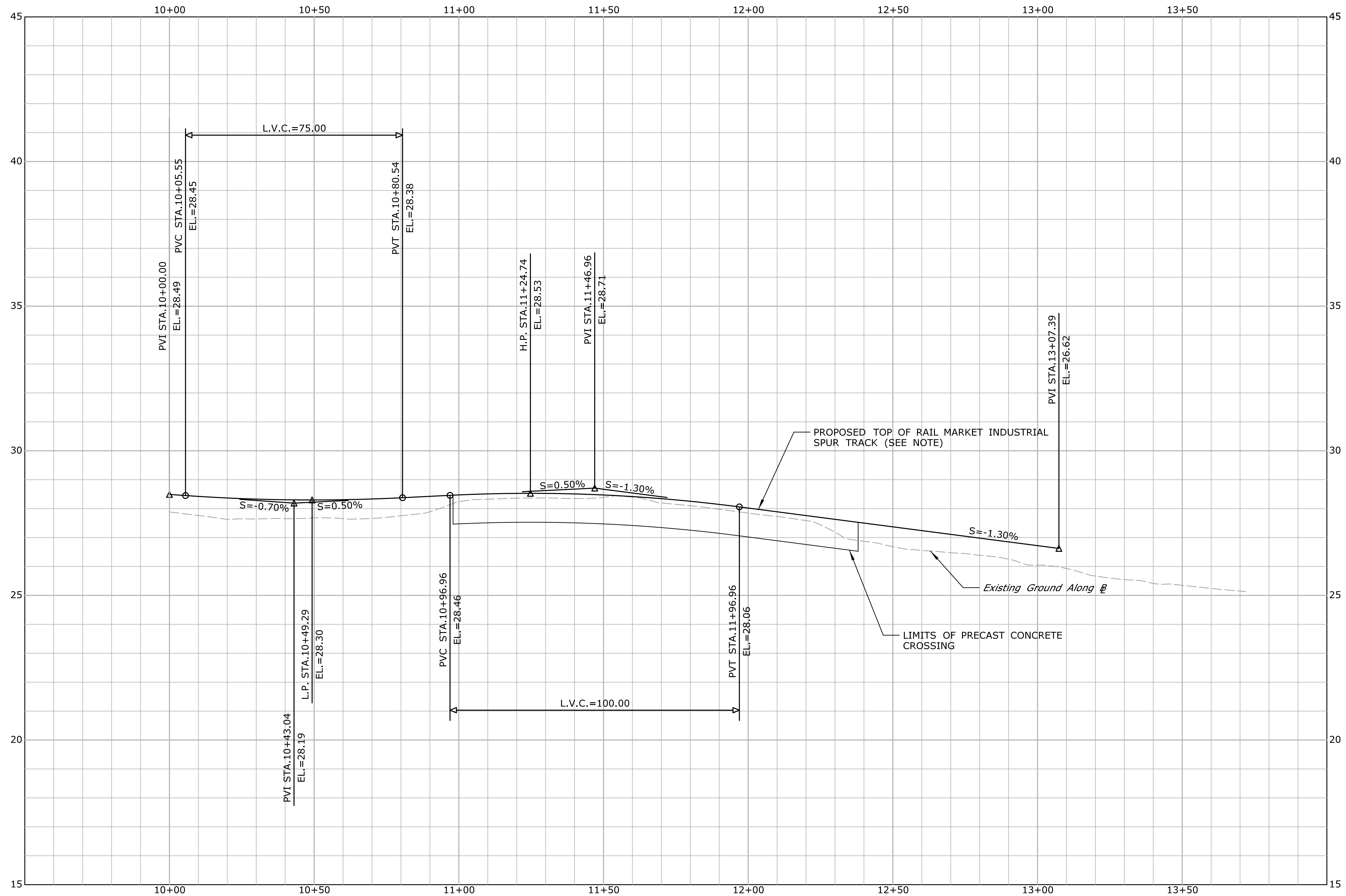

NOTE:
 PROPOSED TOP OF RAIL PROFILE IS A MATHEMATIZED REPRESENTATION OF THE EXISTING
 RAIL. NO PROFILE CHANGE IS PROPOSED ON EITHER RAIL IN THIS PROJECT.

REV.	DATE	REVISION DESCRIPTION	SHEET NO.

THE INFORMATION, INCLUDING ESTIMATED QUANTITIES OF WORK, SHOWN ON THESE SHEETS IS BASED ON LIMITED INVESTIGATIONS BY THE STATE AND IS IN NO WAY WARRANTED TO INDICATE THE CONDITIONS OF ACTUAL QUANTITIES OF WORK WHICH WILL BE REQUIRED.

Plotted Date: 7/10/2018

DESIGNER/DRAFTER:
R. ALLARD

CHECKED BY:
S. WEXELL

SCALE IN FEET
 0 20 40
 SCALE 1"=20'

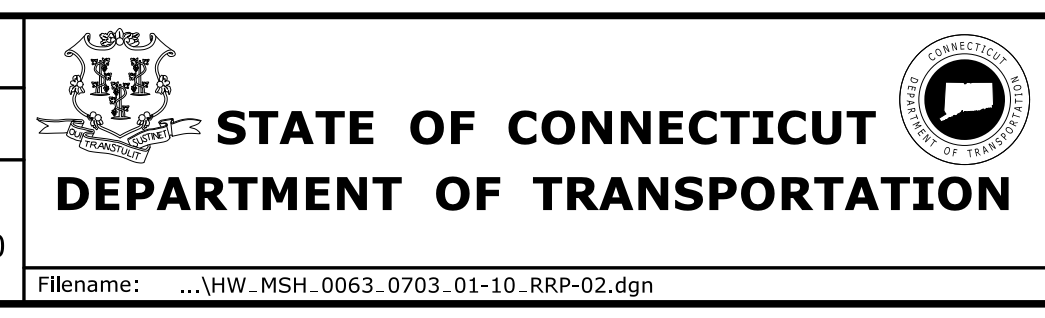

PROJECT TITLE:
**RELOCATION OF I-91 NB
 INTERCHANGE 29 AND WIDENING
 OF I-91 NB AND ROUTE 15 NB
 TO I-84 EB**

CITY/TOWN:
**HARTFORD
 EAST HARTFORD**

DRAWING TITLE:
**PROPOSED RAILROAD
 CROSSING PROFILE**

PROJECT NO.
63-703

DRAWING NO.
RRP-02

SHEET NO.
01.10.02.03

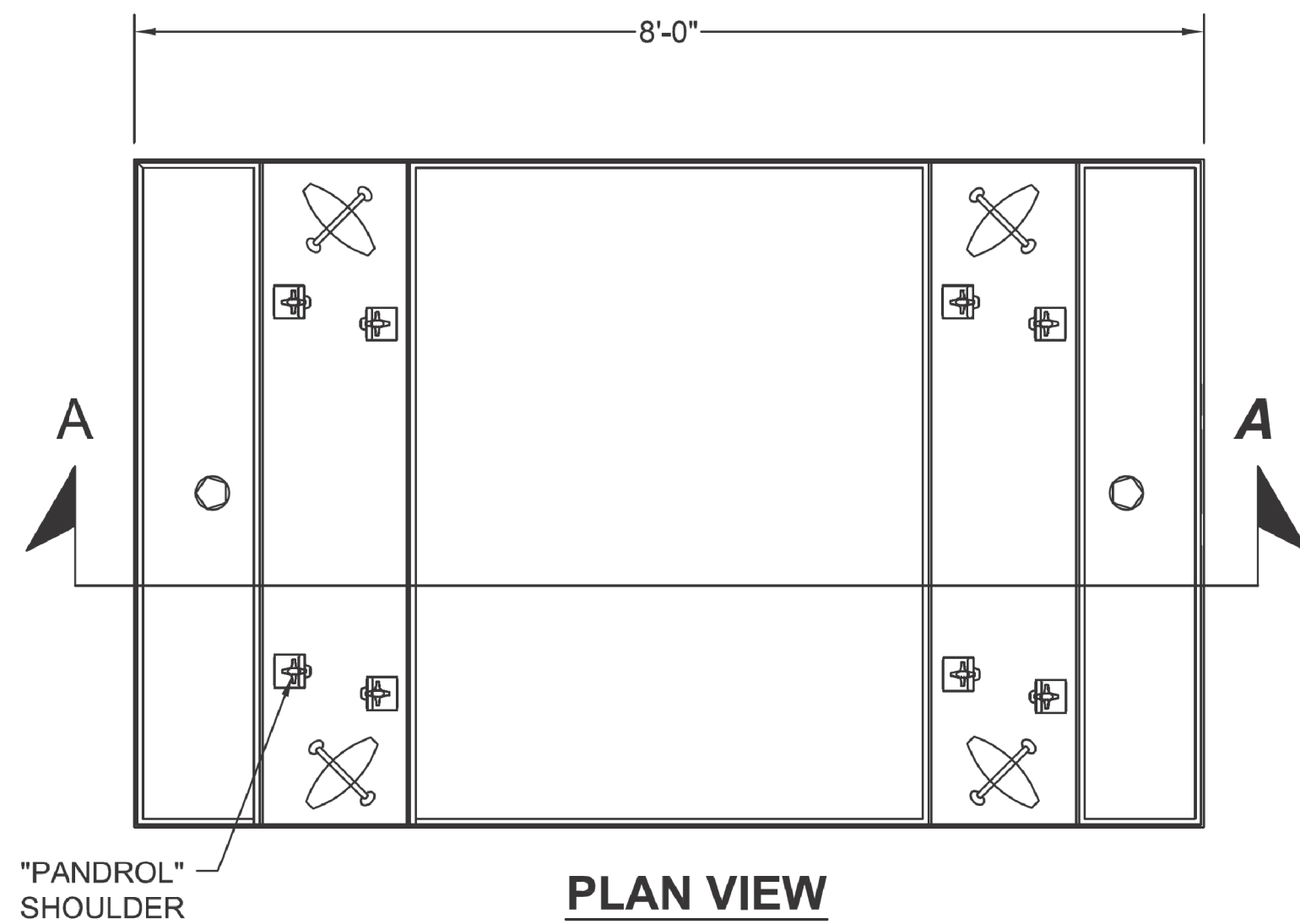

PLAN VIEW

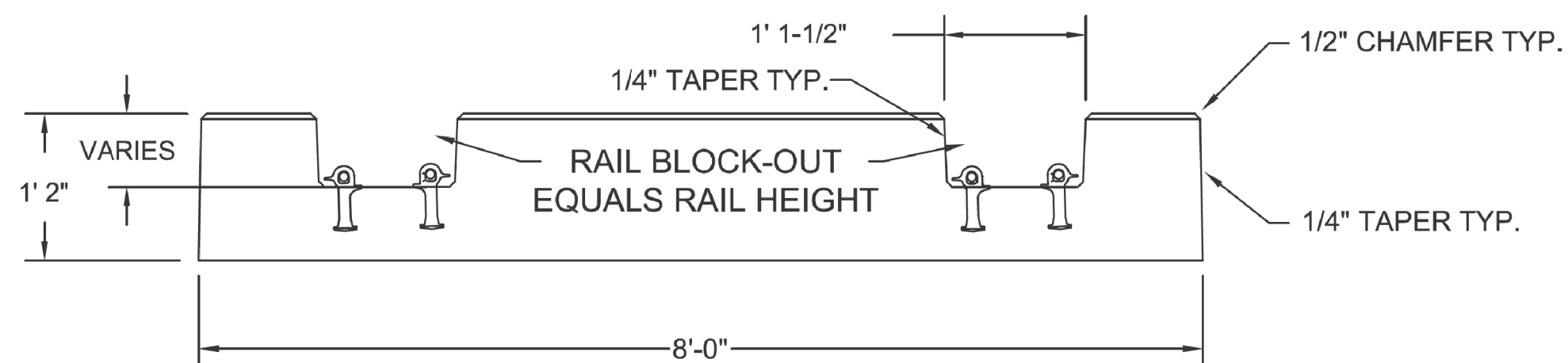

SECTION A-A

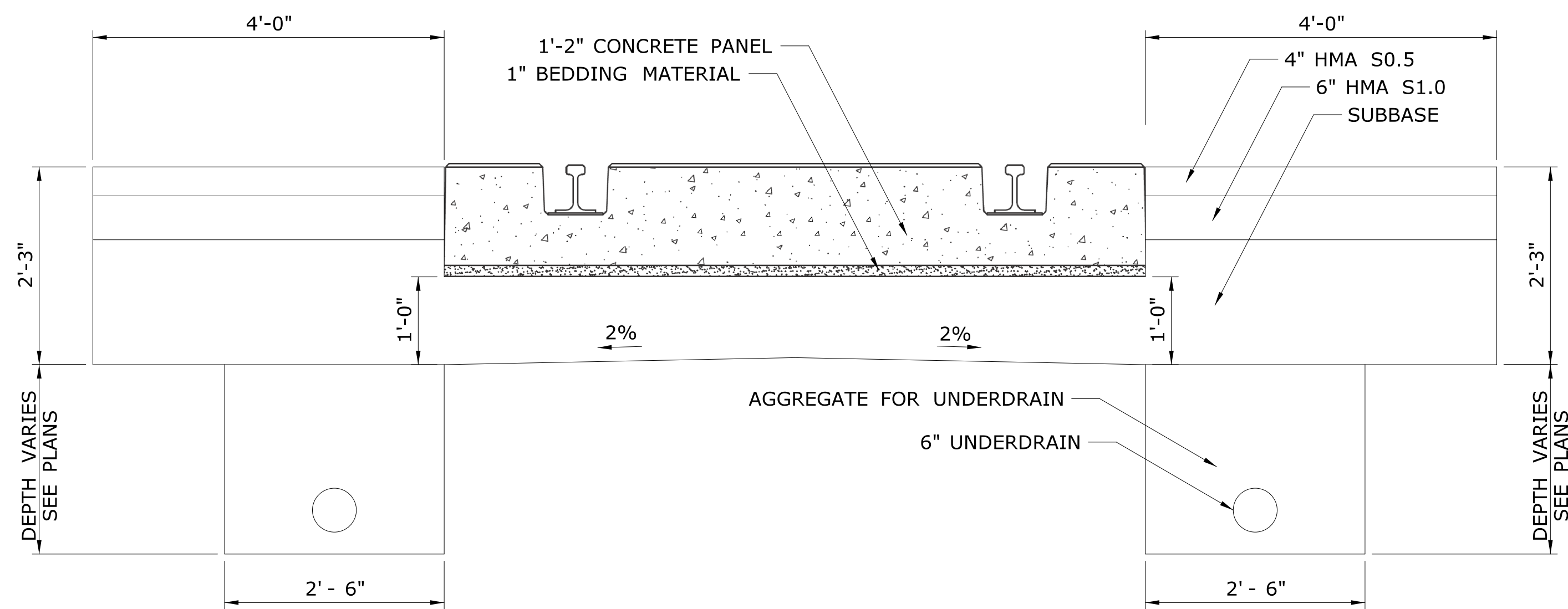

CONCRETE CROSSING SECTION

REV.	DATE	REVISION DESCRIPTION	SHEET NO.

THE INFORMATION, INCLUDING ESTIMATED QUANTITIES OF WORK, SHOWN ON THESE SHEETS IS BASED ON LIMITED INVESTIGATIONS BY THE STATE AND IS IN NO WAY WARRANTED TO INDICATE THE CONDITIONS OF ACTUAL QUANTITIES OF WORK WHICH WILL BE REQUIRED.

Plotted Date: 7/10/2018

DESIGNER/DRAFTER:
K. MCDYER
CHECKED BY:
S. WEXELL
NOT TO SCALE

STATE OF CONNECTICUT
 DEPARTMENT OF TRANSPORTATION
 Filename: ...VHW_MSH_0063_0703_01-10_RRP-03.dgn

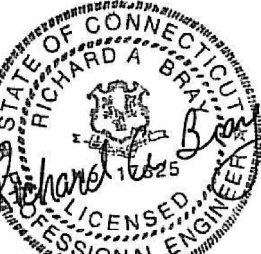

LOCHNER
 H.W. LOCHNER, INC.
 55 Hartland Street
 Suite 401
 East Hartford, CT 06108

PROJECT TITLE:
RELOCATION OF I-91 NB INTERCHANGE 29 AND WIDENING OF I-91 NB AND ROUTE 15 NB TO I-84 EB

CITY/TOWN: **HARTFORD EAST HARTFORD**
DRAWING TITLE: **RAILROAD CROSSING DETAILS**

PROJECT NO. **63-703**
DRAWING NO. **RRP-03**
SHEET NO. **01.10.02.04**

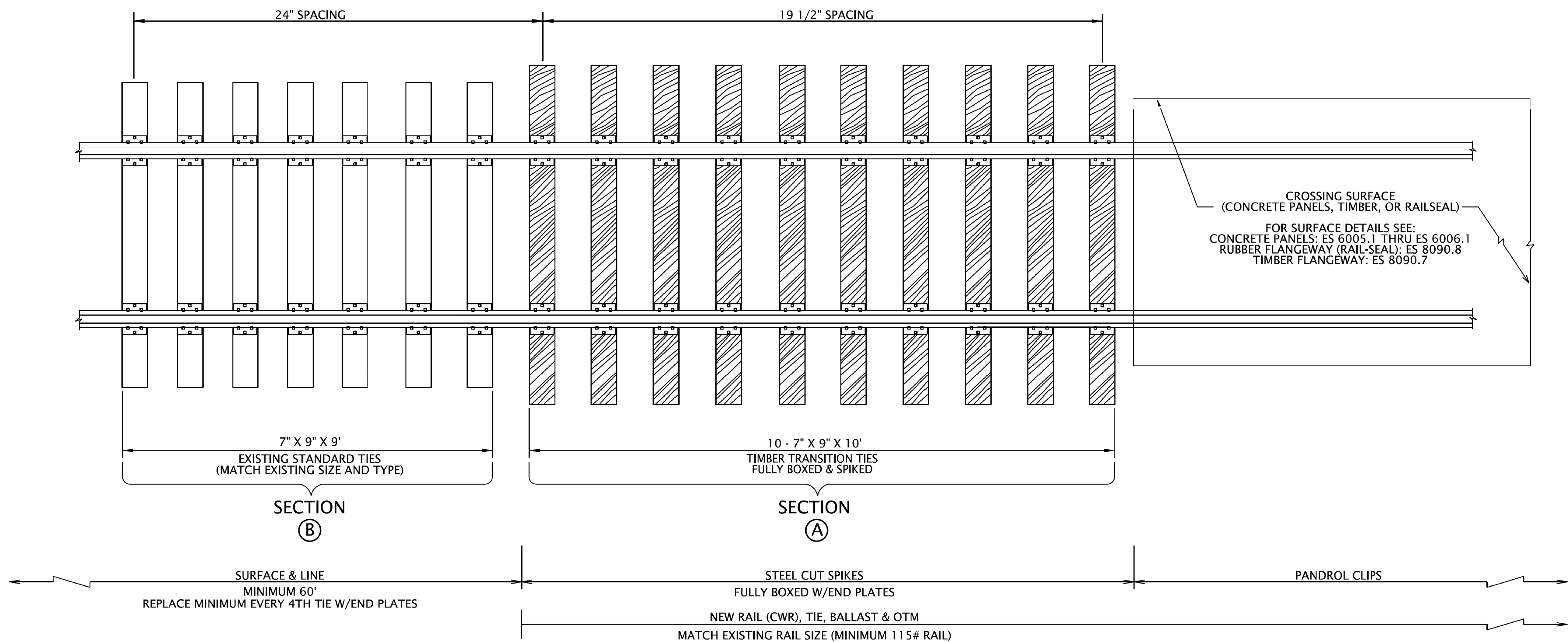
FILE	
ES6007.1	
REVISIONS	
02-18-2011	XRL/TJF
06-28-2011	XRL/TJF
07-03-2013	XRL/GRC



DETAIL PLAN

SEE ES8050.1 FOR ANCHOR AND SPIKING REQUIREMENTS

<p>GENESEE & WYOMING ENGINEERING DESIGN STANDARDS REFERENCE MANUAL</p>	Issue Date: 03-01-2009	Revised Date: 07-03-2013	<p>The material and equipment shown herein must meet or exceed all quality requirements. Any deviation from these standards must be submitted in writing and approved by the Regional V.P. of Engineering and A.V.P. Engineering Design prior to use.</p>	<p>Ties & Road Crossing</p> <p>SERIES 6000</p>	<p>TRANSITION ZONE FROM GRADE CROSSING TO EXISTING TIES (DETAIL)</p>	<p>ES6007.1</p> <p>SH. 1 OF 2</p>
	Authorized:	 AVP-Engineering Design				

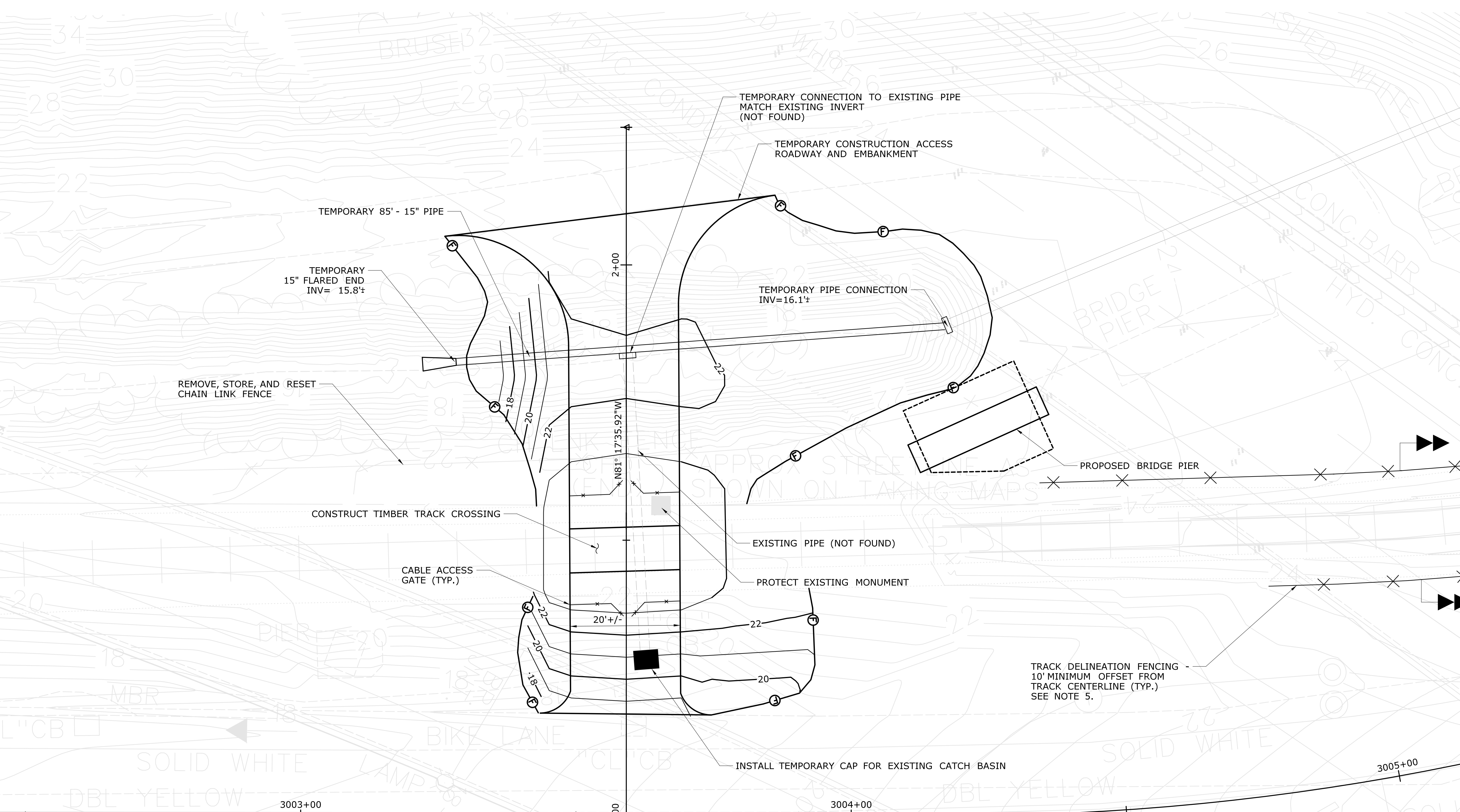
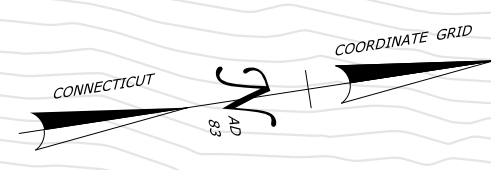

RESERVE RD

TEMPORARY CROSSING STA. 1+00=
RESERVE ROAD STA. 3003+59.15

TEMPORARY CROSSING NOTES:

1. THE GENERAL LAYOUT AND LOCATION OF THE TEMPORARY RAILROAD CROSSING IS A SUGGESTED CONSTRUCTION ACCESS PATH THAT IS ACCEPTABLE TO THE RAILROAD AND THE ENGINEER.
2. THE COST FOR CONSTRUCTION OF A TEMPORARY RAILROAD CROSSING AND ALL RELATED MATERIALS, EQUIPMENT AND LABOR SHALL BE INCLUDED IN THE GENERAL COST OF THE WORK. THIS INCLUDES BUT IS NOT LIMITED TO: CONSTRUCTING, MAINTAINING AND REMOVAL OF A TEMPORARY EMBANKMENT, FULL DEPTH TIMBER RAIL CROSSING, AND ACCESS GATES; CONSTRUCTING, MAINTAINING AND REMOVAL OF TEMPORARY DRAINAGE; REMOVAL, STORAGE, AND RESTORATION OF CHAIN LINK FENCE AND METAL BEAM RAIL; AND PROTECTING OR RESTORING SURVEY MONUMENTS.
3. ALL WORK ASSOCIATED WITH THE CONSTRUCTION, USE, MAINTENANCE, AND TEMPORARY RAILROAD CROSSING INCLUDING ANY PARKING OR STORAGE OF EQUIPMENT OR MATERIALS ADJACENT TO THE TRACK SHALL CONFORM TO THE REQUIREMENTS OF ALL RAILROAD RELATED SPECIAL PROVISIONS INCLUDING BUT NOT LIMITED TO: SECTION 1.05.06 - COOPERATION WITH UTILITIES (INCLUDING RAILROADS); AND NTC - WORK ON RAILROAD PROPERTY.
4. THE CONTRACTOR MAY PROPOSE AN ALTERNATIVE LOCATION OR LAYOUT FOR A TEMPORARY RAILROAD CROSSING TO THE ENGINEER AND THE RAILROAD FOR APPROVAL.
5. TRACK DELINEATION FENCING REQUIRED TO ENSURE RAILROAD TRACK CLEARANCE IS MAINTAINED. SEE ARTICLE 1.05.06 - COOPERATION WITH UTILITIES (INCLUDING RAILROADS).

REV.	DATE	REVISION DESCRIPTION	SHEET NO.	Plotted Date: 7/10/2018

DESIGNER/DRAFTER:
R. ALLARD

CHECKED BY:
S. WEXELL

SCALE IN FEET
0 10 20
SCALE 1"=10'

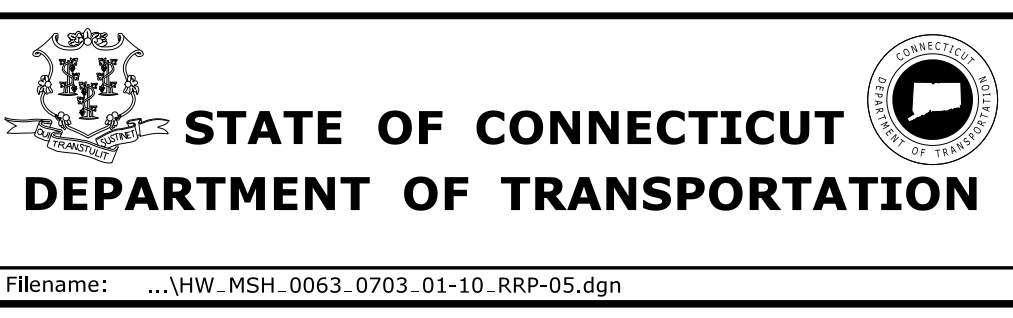

PROJECT TITLE:
RELOCATION OF I-91 NB INTERCHANGE 29 AND WIDENING OF I-91 NB AND ROUTE 15 NB TO I-84 EB

CITY/TOWN:
HARTFORD EAST HARTFORD

DRAWING TITLE:
TEMPORARY RAILROAD CROSSING PLAN

PROJECT NO.
63-703

DRAWING NO.
RRP-05

SHEET NO.
01.10.02.06

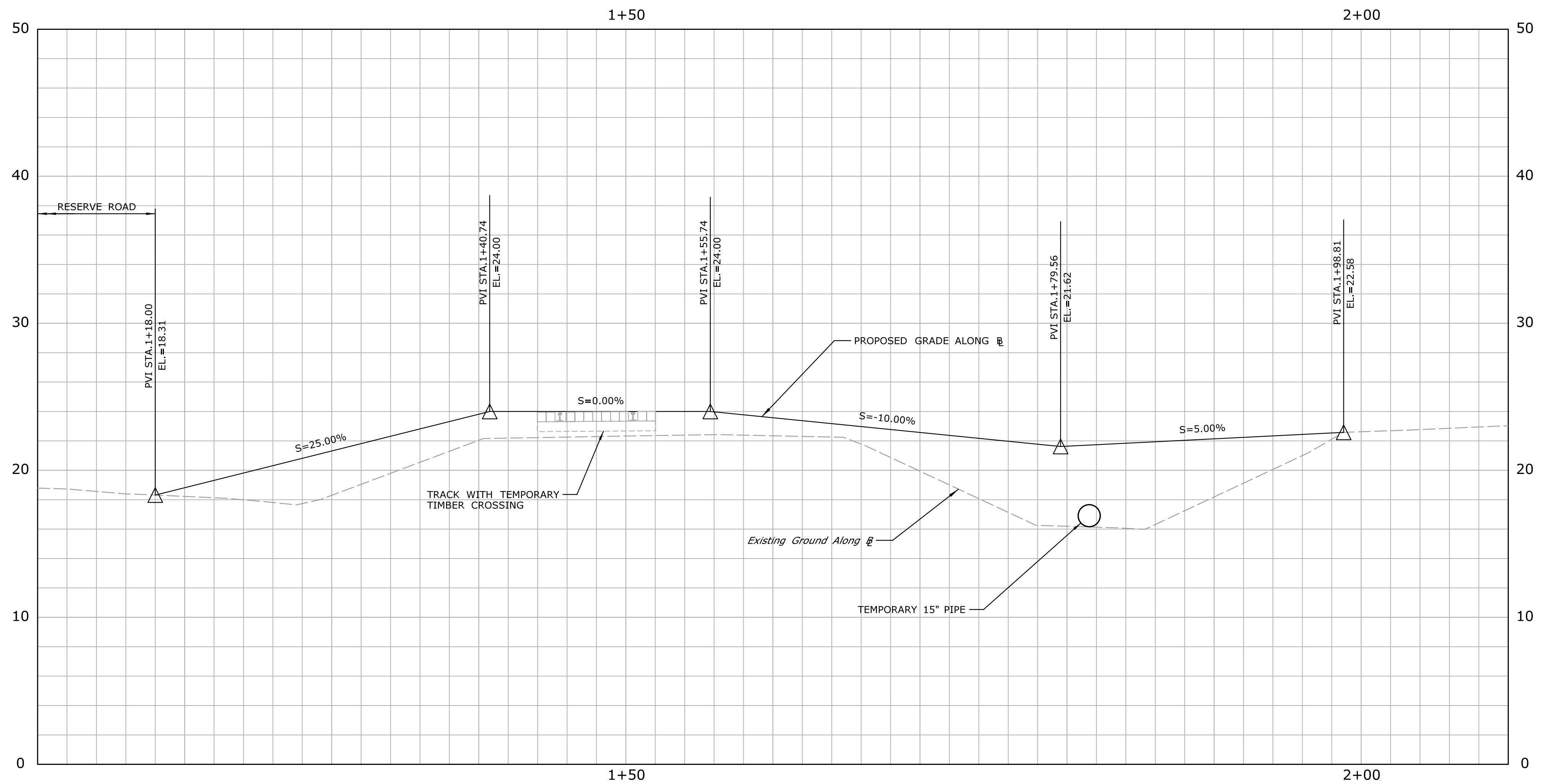

REV.	DATE	REVISION DESCRIPTION	SHEET NO.

THE INFORMATION, INCLUDING ESTIMATED QUANTITIES OF WORK, SHOWN ON THESE SHEETS IS BASED ON LIMITED INVESTIGATIONS BY THE STATE AND IS IN NO WAY WARRANTED TO INDICATE THE CONDITIONS OF ACTUAL QUANTITIES OF WORK WHICH WILL BE REQUIRED.

Plotted Date: 7/10/2018

DESIGNER/DRAFTER:
R. ALLARD

CHECKED BY:
S. WEXELL

SCALE IN FEET
0 5 10
SCALE 1"=5'

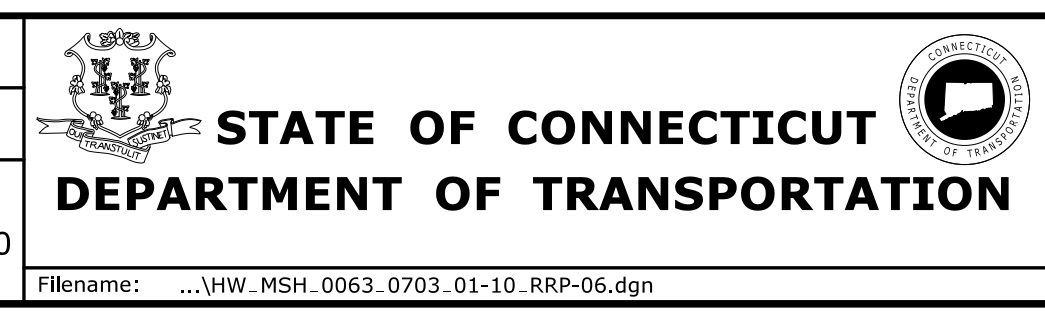

PROJECT TITLE:
RELOCATION OF I-91 NB INTERCHANGE 29 AND WIDENING OF I-91 NB AND ROUTE 15 NB TO I-84 EB

CITY/TOWN:
HARTFORD EAST HARTFORD

DRAWING TITLE:
TEMPORARY RAILROAD CROSSING PROFILE

PROJECT NO.
63-703

DRAWING NO.
RRP-06

SHEET NO.
01.10.02.07

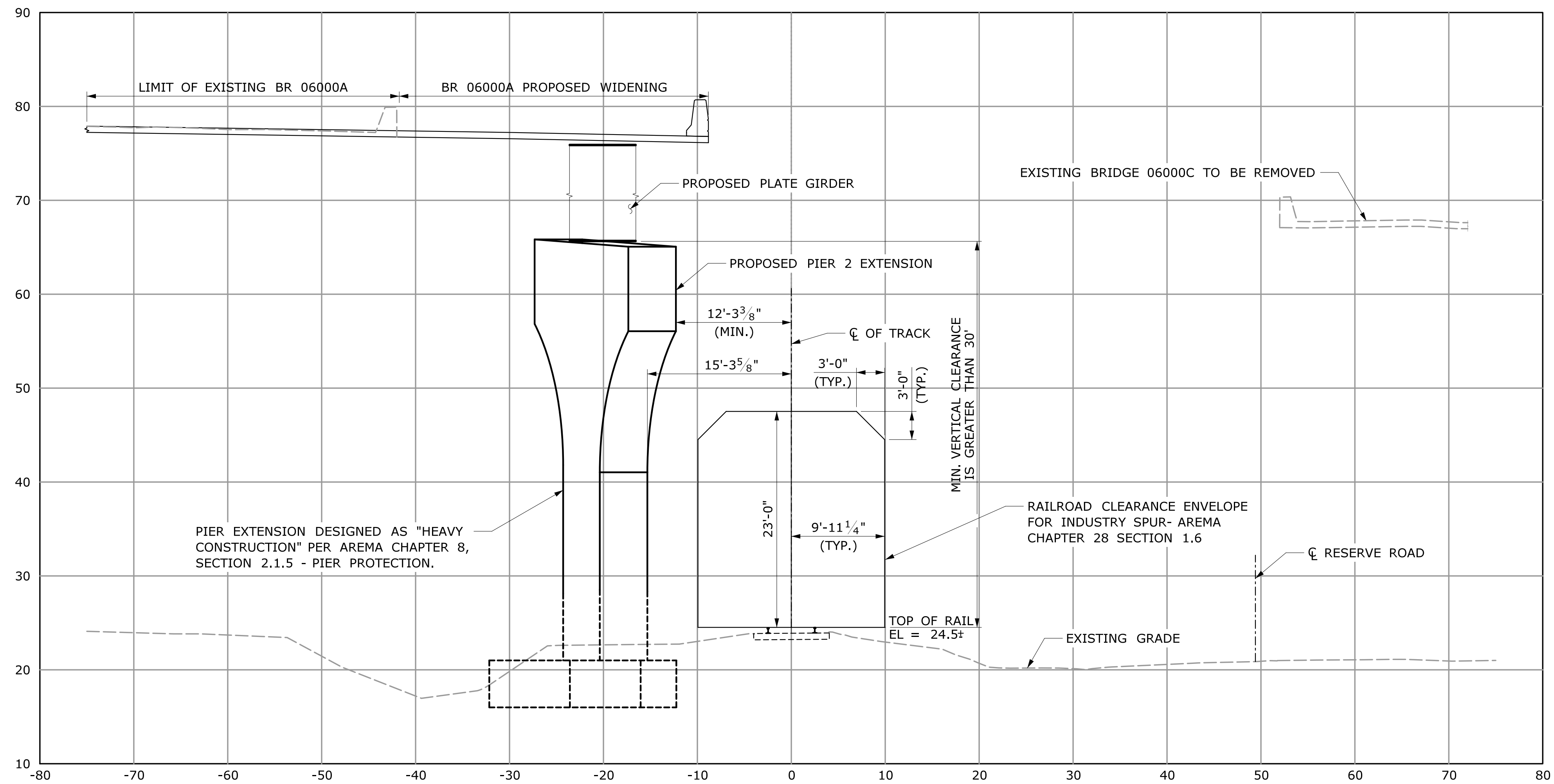

PIER EXTENSION DESIGNED AS "HEAVY CONSTRUCTION" PER AREMA CHAPTER 8, SECTION 2.1.5 - PIER PROTECTION.

**SECTION STA. 12+04.51 (LOOKING NORTH)
 MARKET INDUSTRIAL SPUR RAILROAD
 ROUTE 5/15 OVER THE RAILROAD
 (CTDOT BRIDGE NO. 06000A WIDENING)**

NOTES:

1. SURVEYED BY: SEE GENERAL NOTE NO. 4 ON DRAWING NO. GEN-04
2. VERTICAL CLEARANCES ARE FROM TOP OF EXISTING RAIL TO BOTTOM OF PROPOSED GIRDER. HORIZONTAL CLEARANCES SHOWN ARE FROM THE CENTERLINE OF THE RAILROAD TO THE INSIDE FACE OF THE PIER EXTENSION.
3. SECTION IS CUT AT THE CONTROLLING HORIZONTAL CLEARANCE LOCATION.
4. AREMA CLEARANCE REQUIREMENTS EQUAL OR EXCEED STATE OF CONNECTICUT MINIMUMS.

REV.	DATE	REVISION DESCRIPTION	SHEET NO.

THE INFORMATION, INCLUDING ESTIMATED QUANTITIES OF WORK, SHOWN ON THESE SHEETS IS BASED ON LIMITED INVESTIGATIONS BY THE STATE AND IS IN NO WAY WARRANTED TO INDICATE THE CONDITIONS OF ACTUAL QUANTITIES OF WORK WHICH WILL BE REQUIRED.

Plotted Date: 7/10/2018

DESIGNER/DRAFTER:
H. MARTINDALE

CHECKED BY:
R. ALLARD

SCALE AS NOTED

STATE OF CONNECTICUT
 DEPARTMENT OF TRANSPORTATION

Filename: ...VHW_MSH_0063_0703_01-10_RRP-07.dgn

LOCHNER
 H.W. LOCHNER, INC.
 55 Hartland Street
 Suite 401
 East Hartford, CT 06108

PROJECT TITLE:
**RELOCATION OF I-91 NB
 INTERCHANGE 29 AND WIDENING
 OF I-91 NB AND ROUTE 15 NB
 TO I-84 EB**

CITY/TOWN:
**HARTFORD
 EAST HARTFORD**

DRAWING TITLE:
**RAILROAD CLEARANCE
 DIAGRAM**

PROJECT NO.
63-703

DRAWING NO.
RRP-07

SHEET NO.
01.10.02.08

F.H.W.A. REGION NO.	STATE	TOWN	FED. AID PROJ. NO.	PROJ. NO.	YEAR	ROUTE NO.	SHEET NO.	TOTAL SHEETS
I	CT	HARTFORD-WETHERSFIELD	IM-91-305737	63-458	1992	1-91	335	336

RESERVE ROAD CURVE DATA

CURVE 1	CURVE 2
Δ = 33°-25'-26.621"	Δ = 10°-19'-8.741"
D = 21°-13'-14.373"	D = 15°-00'-54.667"
R = 270.00'	R = 381.586'
T = 81.066'	T = 34.455'
L = 157.507'	L = 68.724'
P.C. STA. = 10+00.00	P.C. STA. = 13+39.28
P.T. STA. = 11+57.51	P.T. STA. = 14+08.00

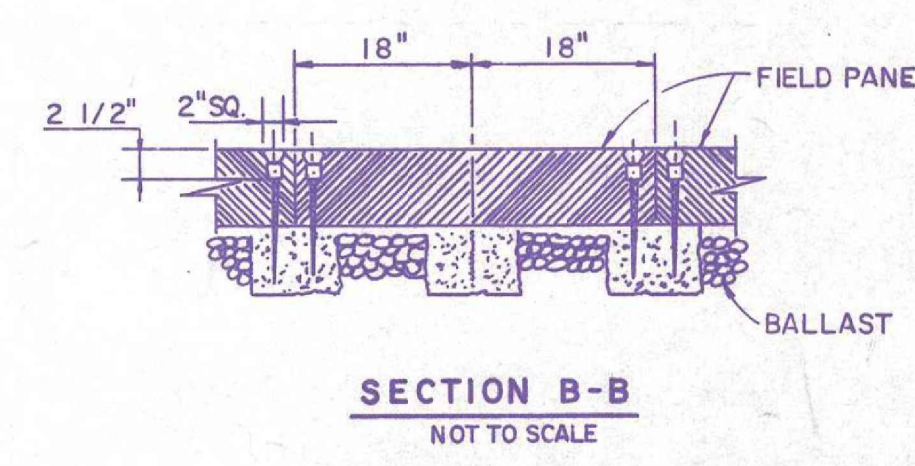
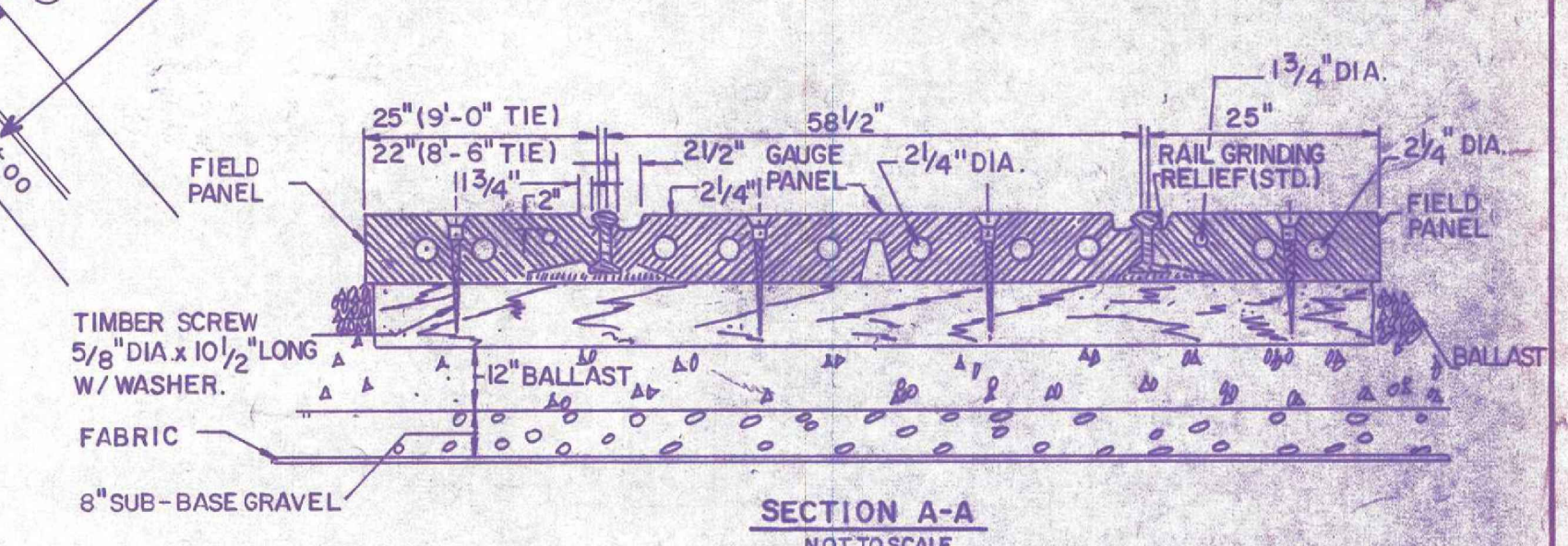
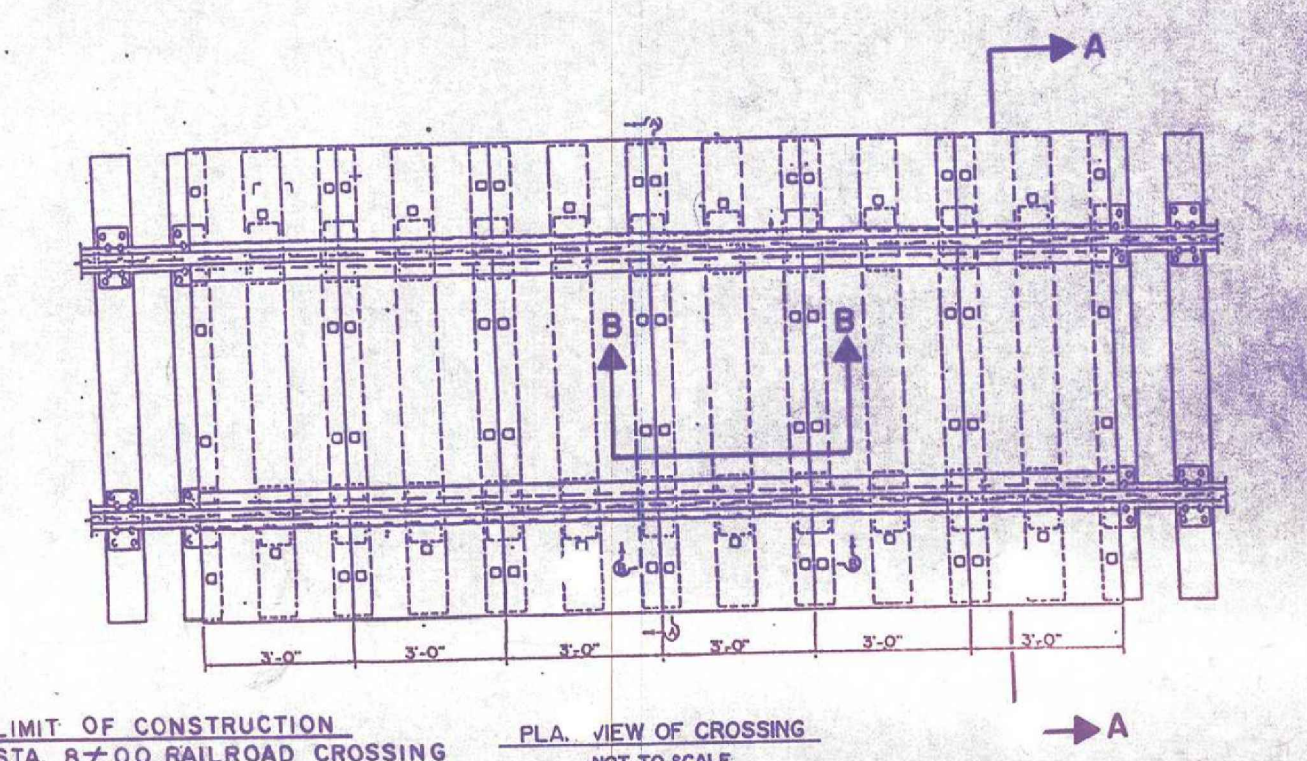
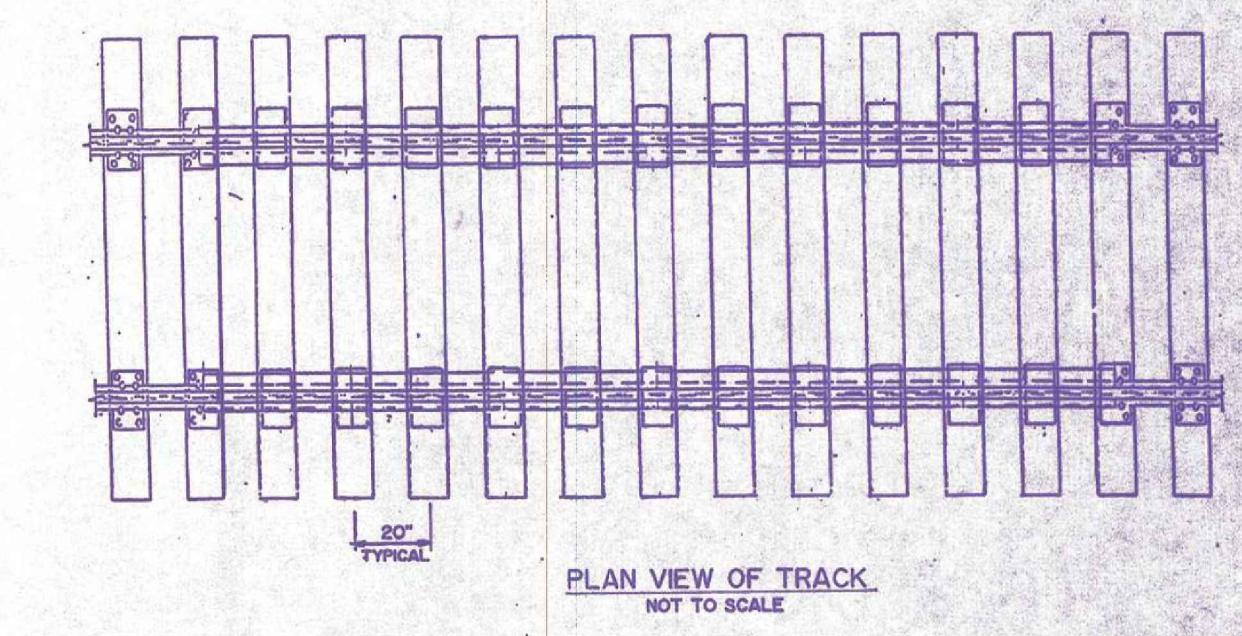
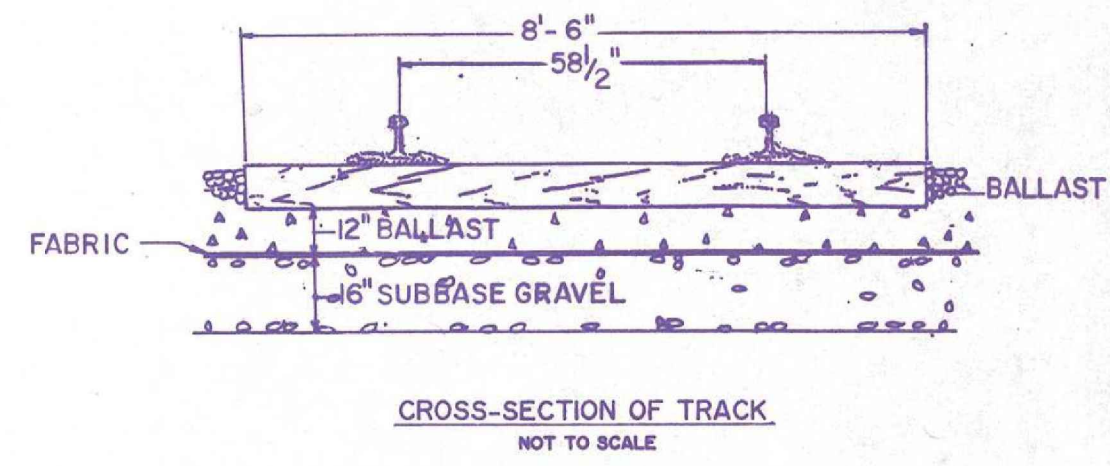
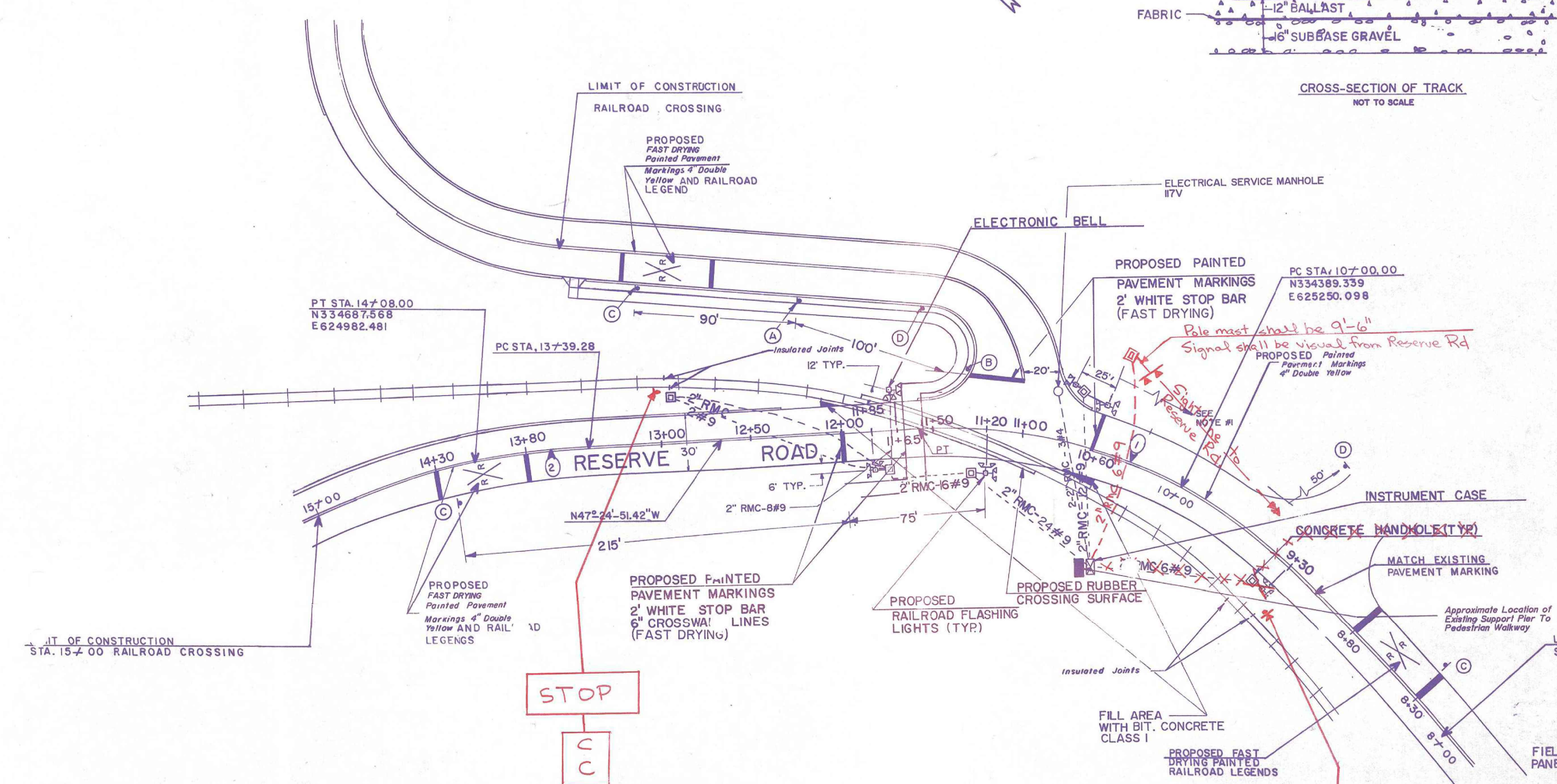

NOTES:

- INSTALL THE RAILROAD CROSSING PAVEMENT MARKINGS 160' FROM THE STOP BAR & THE SIGN NO. 41-0193 230' FROM THE STOP BAR.
- ALL SIGNS, SIGNALS AND MARKINGS ARE TO BE IN CONFORMANCE WITH THE 1988 EDITION OF THE MANUAL OF UNIFORM TRAFFIC CONTROL DEVICES PUBLISHED BY THE FEDERAL HIGHWAY ADMINISTRATION, PART VIII, TRAFFIC CONTROL SYSTEMS FOR RAILROAD-HIGHWAY GRADE CROSSINGS.
- MINIMUM DISTANCE FROM CENTERLINE OF TRACK TO WARNING SIGNALS, - 12 FEET.
- INSULATED JOINTS TO BE APPROXIMATELY 110 FEET FROM ROAD CROSSING.
- THERE ARE TO BE NO SPLICES IN WIRES FROM INSTRUMENT CASE TO TRACK CONNECTORS OR FLASHERS.
- THE ENGINEER SHALL DETERMINE IN THE FIELD IF NEW PAVEMENT MARKINGS & SIGNS NEED TO BE INSTALLED. EXISTING SIGNS SHALL BE RELOCATED AS DIRECTED BY THE ENGINEER.
- THE CONTRACTOR SHALL UTILIZE THE CONTROL PLANS AND HIGHWAY PLANS FROM PROJECT No. 63-434 WESTERN APPROACHES TO THE CHARTER OAK BRIDGE TO ESTABLISH ANY COORDINATES AND SURVEY DATA FOR THE RAILROAD CROSSING. PLANS CAN BE FOUND AT THE DEPARTMENT'S MAP FILE OFFICE, 24 WOLCOTT HILL ROAD, WETHERSFIELD CT.
- TIES 7"x9"x 8'-6" TIE SPACING 18" EVERY 5TH. TIE-SPACING 71 3/8"
- RAIL SPECIFICATION OF 112 @ TO 140 @ CAN BE ACCOMMODATED.
- PANELS CONFORM TO UPPER SURFACE OF TIES, SO A PROPER CROSSING INSTALLATION REQUIRES TIES TO BE IN ONE PLANE THE SPACING IS CRITICAL AS TIES SHOULD BE SPACED ON 18"
- NO PREDRILLING IS NECESSARY FOR SCREW FASTENERS, PANELS ARE MOLDED FOR SCREW FASTENERS AND SPECIAL FITTED RUBBER PLUG.
- THE BOTTOM OF THE PANELS ARE MOLDED TO ACCOMMODATE RAIL ANCHOR SYSTEMS AND PAIL FASTENING SYSTEMS, PLEASE CONTACT SUPPLIER FOR VERIFICATION PRIOR TO INSTALLATION.
- CONTRACTOR TO HAVE SUPPLIER REPRESENTATIVE AT SITE TO VERIFY THE SPACING & INSTALLATION OF RUBBER.
- FULL DEPTH ASPHALT TO EXTEND 4' BEYOND FIELD PANELS.

SIGN LEGEND

- (A) CONNDOT # 41-0501 (STOP AHEAD)
- (B) CONNDOT # 31-0002 (STOP)
- (C) CONNDOT # 41-0193
- (D) CONNDOT # 41-2207

CONNECTICUT
DEPARTMENT OF TRANSPORTATION
BUREAU OF HIGHWAYS - DIVISION OF TRAFFIC

CITY OF HARTFORD
RESERVE ROAD

RAILROAD - HIGHWAY GRADE CROSSING

ENGINEER	URBITRAN ASSOCIATES	
DESIGNER	L.M. RODGERS	DRAFTSMAN K. McDERMOTT
CHECKER		
APPROVED	DATE 7-2-92	
SCALE		

63-458

469-01

335

REV.	DATE	REVISION DESCRIPTION	SHEET NO.	Plotted Date: 7/10/2018

DESIGNER/DRAFTER: K. MCDYER
CHECKED BY: S. WEXELL
NOT TO SCALE

STATE OF CONNECTICUT
DEPARTMENT OF TRANSPORTATION

Filename: ...VHW_MSH_0063_0703_01-10_RRP-08.dgn

LOCHNER
H.W. LOCHNER, INC.
55 Hartland Street
Suite 401
East Hartford, CT 06108

PROJECT TITLE:
RELOCATION OF I-91 NB INTERCHANGE 29 AND WIDENING OF I-91 NB AND ROUTE 15 NB TO I-84 EB

CITY/TOWN: **HARTFORD EAST HARTFORD**
DRAWING TITLE: **EXISTING RAILROAD CROSSING PLAN**

PROJECT NO. **63-703**
DRAWING NO. **RRP-08**
SHEET NO. **01.10.02.09**