

GENERAL DESIGN CRITERIA

1. VERTICAL GRADES SHALL BE DESIGNED USING FLAT SLOPES OF 5% OR LESS WHERE PRACTICAL
2. SLOPES EXCEEDING 5% BUT LESS THAN 8.33% SHALL BE LESS THAN 200 FEET IN LENGTH
3. IN NON-COMPLIANT SECTIONS, THE MAXIMUM ALLOWABLE SLOPES SHALL NOT EXCEED 12.5% AND SHALL BE LESS THAN 200 FEET IN LENGTH

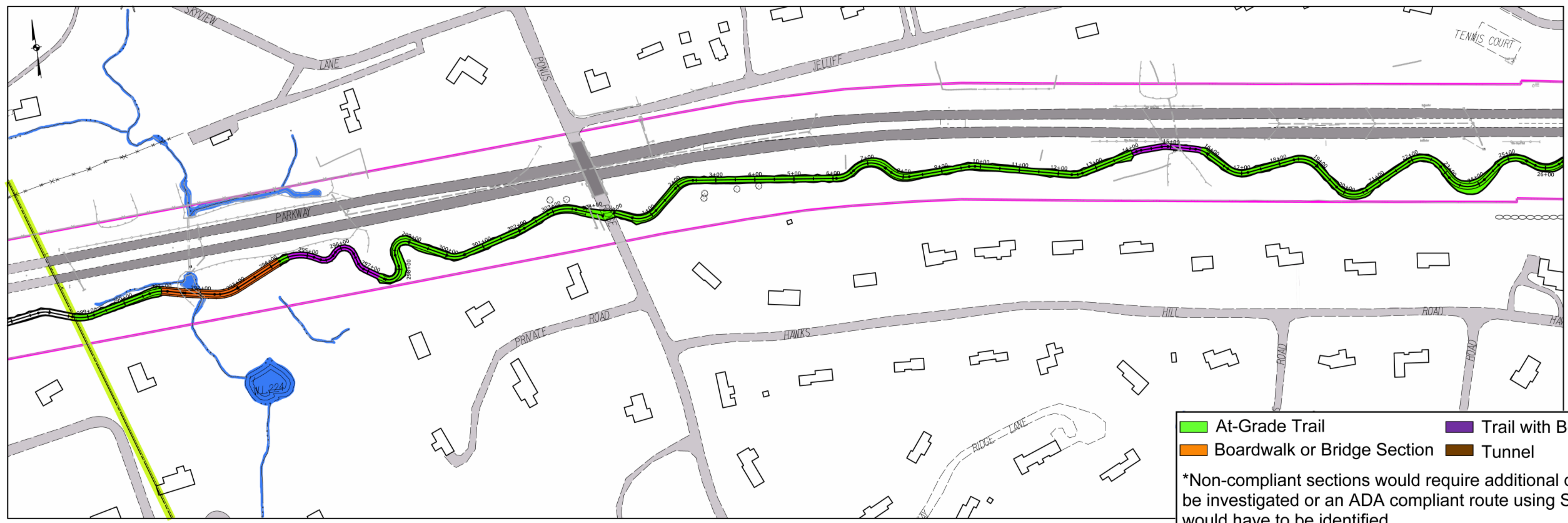
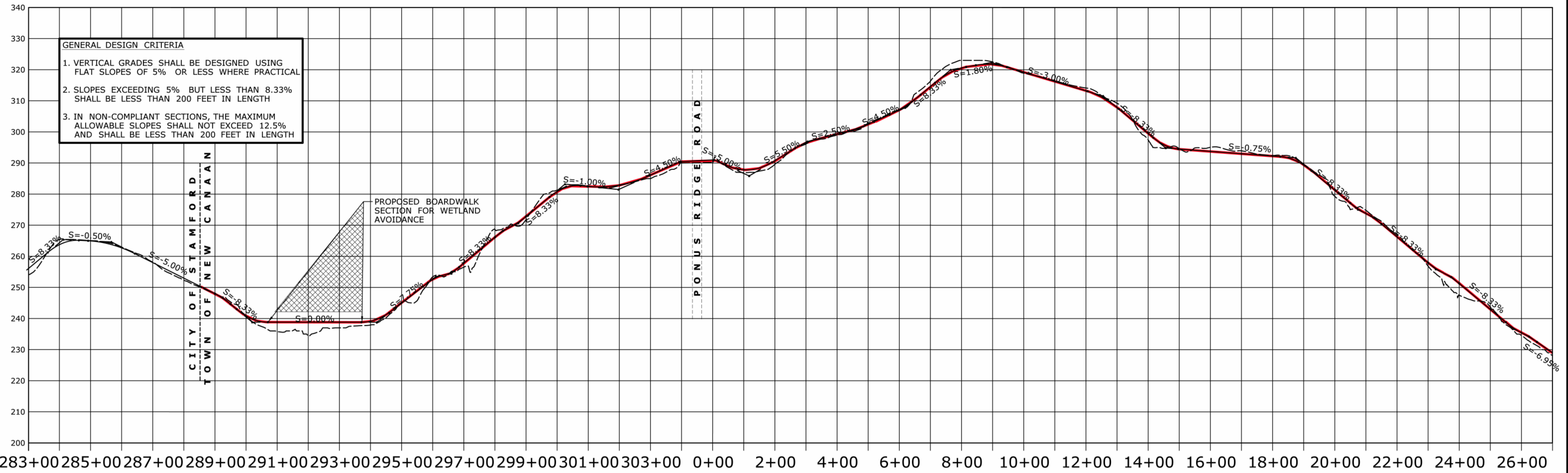

■ At-Grade Trail ■ Trail with Benched Retaining Wall
■ Boardwalk or Bridge Section ■ Tunnel
 *Non-compliant sections would require additional design alternatives to be investigated or an ADA compliant route using State or Local roads would have to be identified.

NOTE: STATION NOS. FROM STAMFORD/ NEW CANAAN TOWN LINE TO PONUS RIDGE ROAD CONTINUE FROM TOWN OF STAMFORD CONCEPTUAL ALIGNMENT

PRELIMINARY DESIGN REVIEW

DESIGNER/DRAFTER: MLW CHECKED BY: MSC		<p>STATE OF CONNECTICUT DEPARTMENT OF TRANSPORTATION</p>	SIGNATURE/BLOCK: OFFICE OF ENGINEERING APPROVED BY:		PROJECT TITLE: MERRITT PARKWAY MULTI-USE TRAIL FEASIBILITY STUDY		TOWN: TOWN OF NEW CANAAN		PROJECT NO. 173-410	
SCALE AS NOTED			FILENAME: ...LHW_MSH_0173_0410_NewCanaan_PLN-01.dgn		CONCEPTUAL ALIGNMENT PLAN AND PROFILE		DRAWING NO. SHT-01		SHEET NO.	
REV.	DATE	REVISION DESCRIPTION	SHEET NO.	Plotted Date: 4/23/2014						

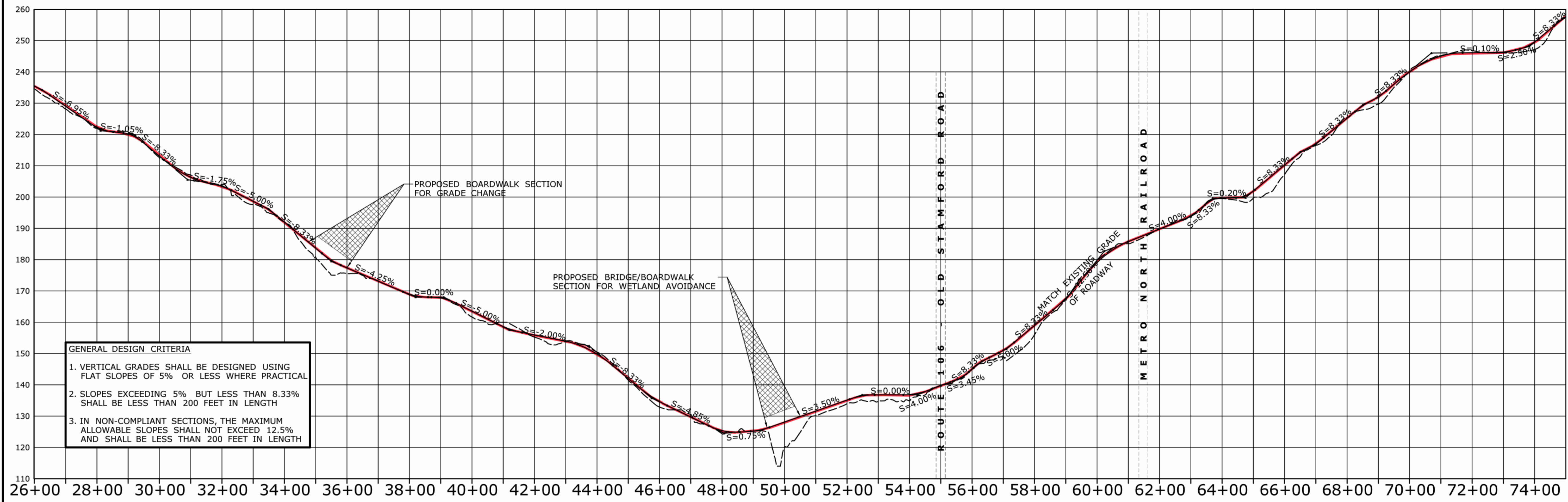

GENERAL DESIGN CRITERIA

1. VERTICAL GRADES SHALL BE DESIGNED USING FLAT SLOPES OF 5% OR LESS WHERE PRACTICAL
2. SLOPES EXCEEDING 5% BUT LESS THAN 8.33% SHALL BE LESS THAN 200 FEET IN LENGTH
3. IN NON-COMPLIANT SECTIONS, THE MAXIMUM ALLOWABLE SLOPES SHALL NOT EXCEED 12.5% AND SHALL BE LESS THAN 200 FEET IN LENGTH

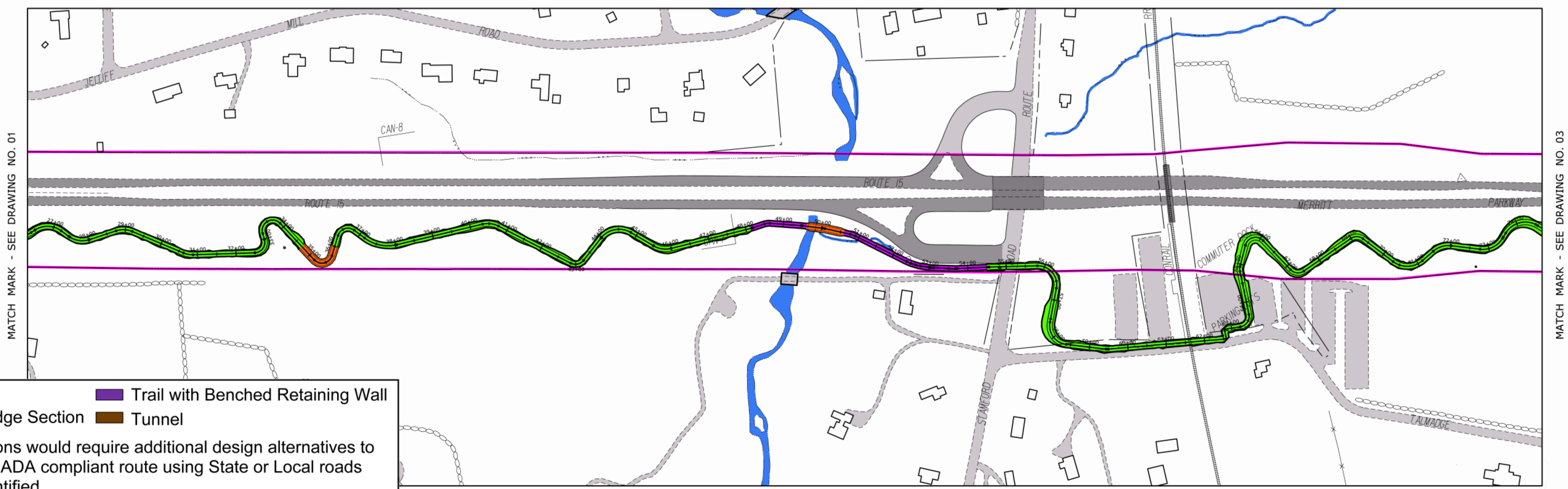

■ At-Grade Trail ■ Trail with Benched Retaining Wall
■ Boardwalk or Bridge Section ■ Tunnel

*Non-compliant sections would require additional design alternatives to be investigated or an ADA compliant route using State or Local roads would have to be identified.

PRELIMINARY DESIGN REVIEW

DESIGNER/DRAFTER: MLW CHECKED BY: MSC		<p>STATE OF CONNECTICUT DEPARTMENT OF TRANSPORTATION</p>	SIGNATURE/BLOCK: OFFICE OF ENGINEERING APPROVED BY:	PROJECT TITLE: MERRITT PARKWAY MULTI-USE TRAIL FEASIBILITY STUDY	TOWN: TOWN OF NEW CANAAN	PROJECT NO.: 173-410
SCALE AS NOTED						
REV.	DATE	REVISION DESCRIPTION	SHEET NO.	Plotted Date: 4/22/2014	File name: ...JHW_MSH_0173_0410_NewCanaan_PLN-02.dgn	

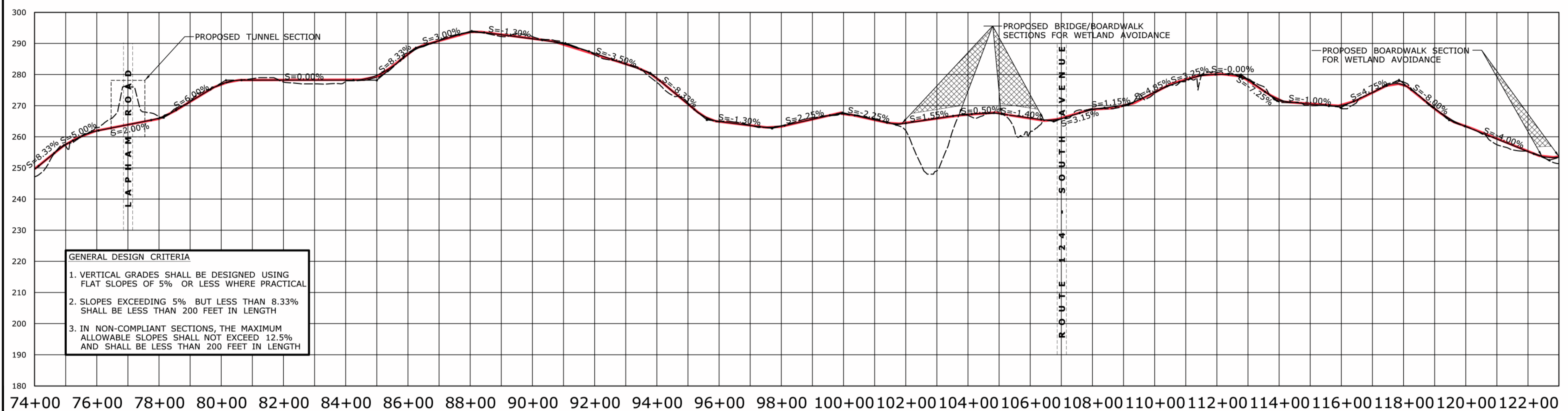

GENERAL DESIGN CRITERIA

1. VERTICAL GRADES SHALL BE DESIGNED USING FLAT SLOPES OF 5% OR LESS WHERE PRACTICAL
2. SLOPES EXCEEDING 5% BUT LESS THAN 8.33% SHALL BE LESS THAN 200 FEET IN LENGTH
3. IN NON-COMPLIANT SECTIONS, THE MAXIMUM ALLOWABLE SLOPES SHALL NOT EXCEED 12.5% AND SHALL BE LESS THAN 200 FEET IN LENGTH

74+00 76+00 78+00 80+00 82+00 84+00 86+00 88+00 90+00 92+00 94+00 96+00 98+00 100+00 102+00 104+00 106+00 108+00 110+00 112+00 114+00 116+00 118+00 120+00 122+00

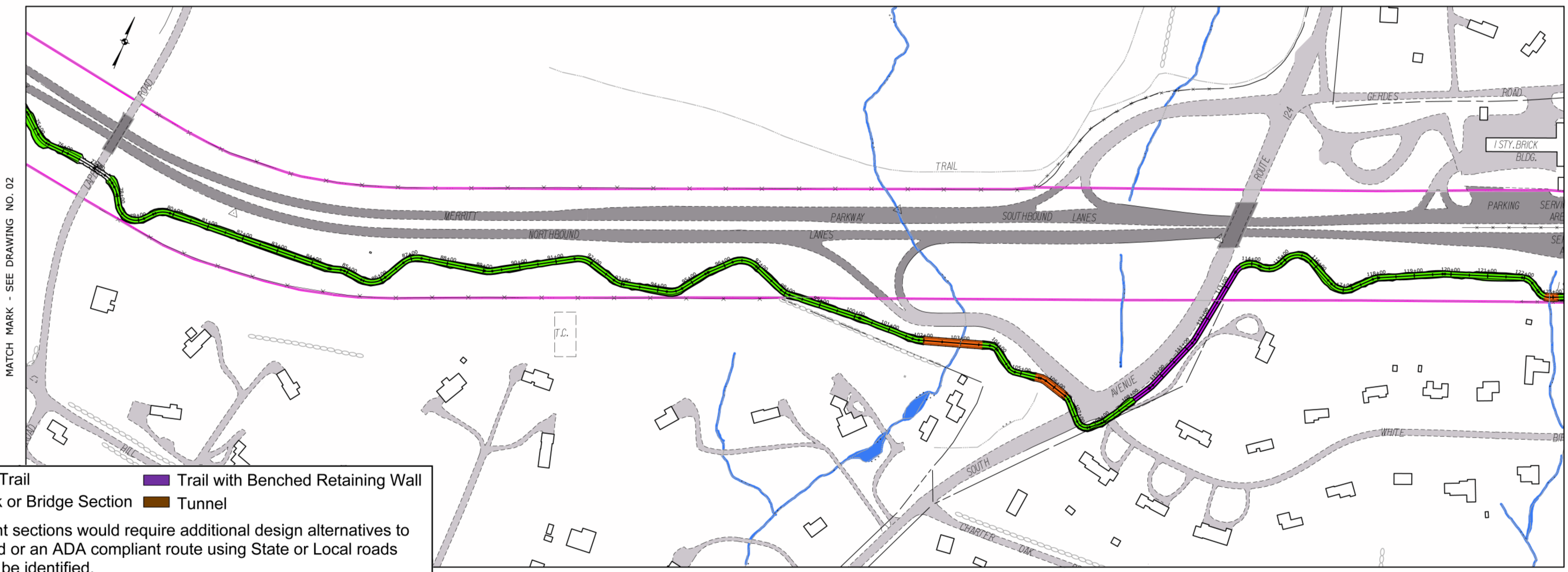

■ At-Grade Trail ■ Trail with Benched Retaining Wall
■ Boardwalk or Bridge Section ■ Tunnel

*Non-compliant sections would require additional design alternatives to be investigated or an ADA compliant route using State or Local roads would have to be identified.

PRELIMINARY DESIGN REVIEW

THE INFORMATION, INCLUDING ESTIMATED QUANTITIES OF WORK, SHOWN ON THESE SHEETS IS BASED ON LIMITED INVESTIGATIONS BY THE STATE AND IS IN NO WAY WARRANTED TO INDICATE THE CONDITIONS OF ACTUAL QUANTITIES OF WORK WHICH WILL BE REQUIRED. Plotted Date: 4/22/2014		DESIGNER/DRAFTER: MLW CHECKED BY: MSC SCALE AS NOTED	STATE OF CONNECTICUT DEPARTMENT OF TRANSPORTATION Filename: ...LHW_MSH_0173_0410_NewCanaan_PLN-03.dgn	SIGNATURE/BLOCK: OFFICE OF ENGINEERING APPROVED BY:	PROJECT TITLE: MERRITT PARKWAY MULTI-USE TRAIL FEASIBILITY STUDY	TOWN: TOWN OF NEW CANAAN DRAWING TITLE: CONCEPTUAL ALIGNMENT PLAN AND PROFILE	PROJECT NO. 173-410 DRAWING NO. SHT-03 SHEET NO.
REV.	DATE	REVISION DESCRIPTION	SHEET NO.				

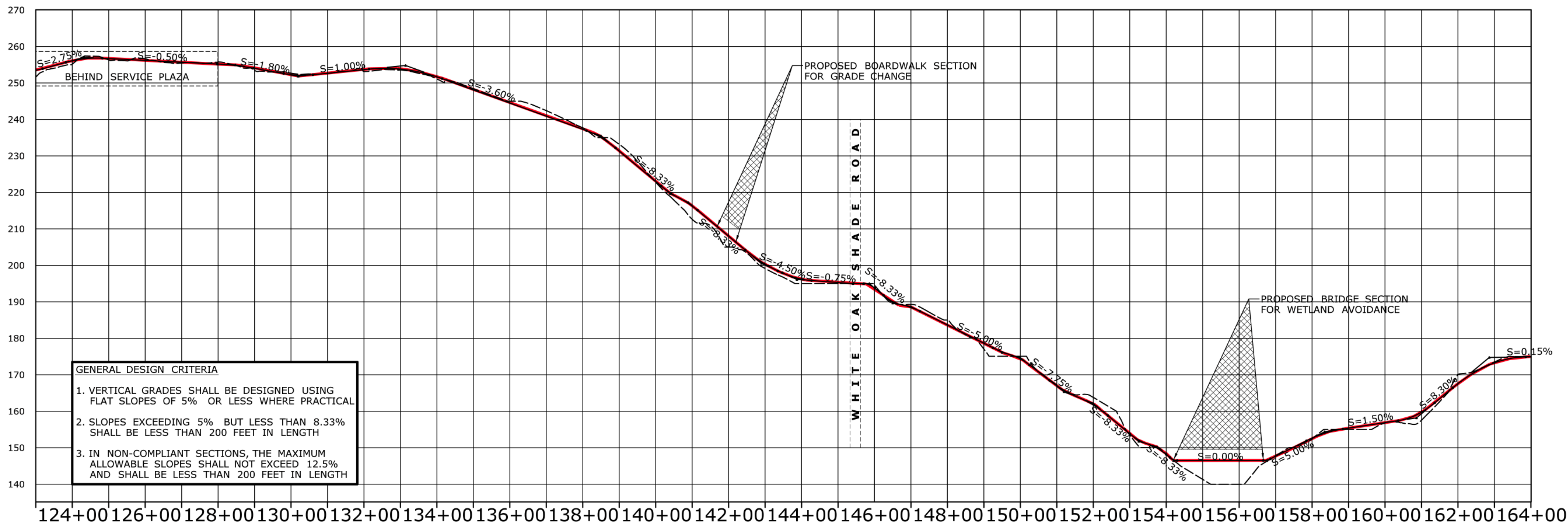

GENERAL DESIGN CRITERIA

1. VERTICAL GRADES SHALL BE DESIGNED USING FLAT SLOPES OF 5% OR LESS WHERE PRACTICAL
2. SLOPES EXCEEDING 5% BUT LESS THAN 8.33% SHALL BE LESS THAN 200 FEET IN LENGTH
3. IN NON-COMPLIANT SECTIONS, THE MAXIMUM ALLOWABLE SLOPES SHALL NOT EXCEED 12.5% AND SHALL BE LESS THAN 200 FEET IN LENGTH

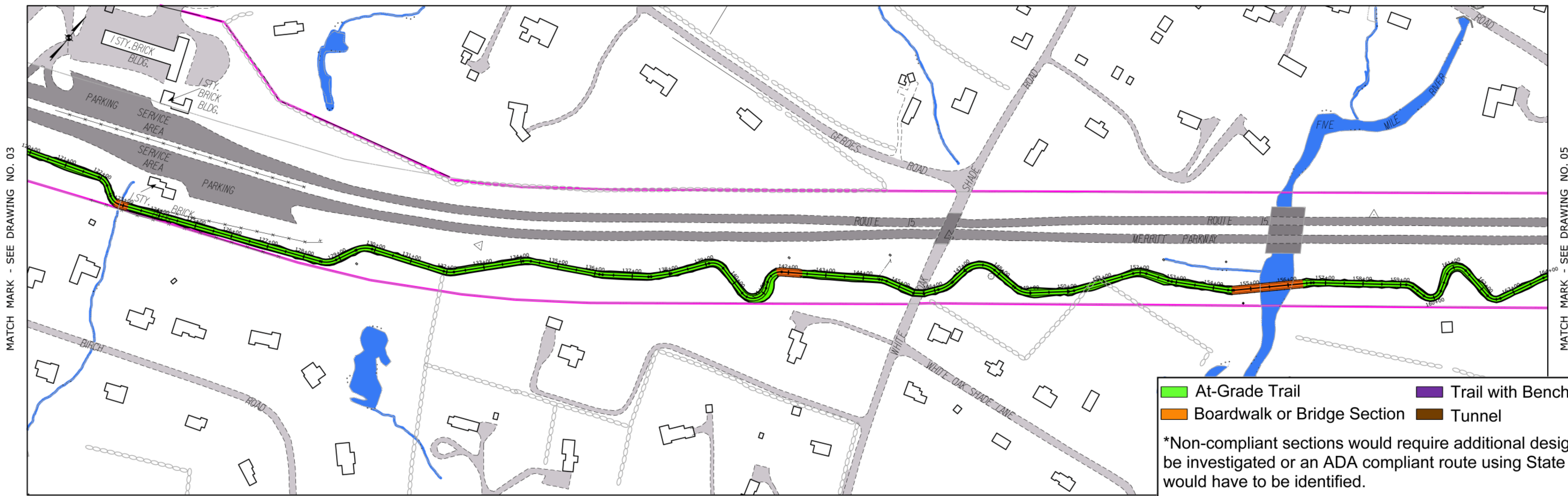

■ At-Grade Trail ■ Trail with Benched Retaining Wall
■ Boardwalk or Bridge Section ■ Tunnel

*Non-compliant sections would require additional design alternatives to be investigated or an ADA compliant route using State or Local roads would have to be identified.

PRELIMINARY DESIGN REVIEW

DESIGNER/DRAFTER: MLW CHECKED BY: MSC		<p>STATE OF CONNECTICUT DEPARTMENT OF TRANSPORTATION</p> <p>Signature/Block: OFFICE OF ENGINEERING Approved By:</p>	PROJECT TITLE: MERRITT PARKWAY MULTI-USE TRAIL FEASIBILITY STUDY	TOWN: TOWN OF NEW CANAAN	PROJECT NO.: 173-410
SCALE AS NOTED					
REV. DATE REVISION DESCRIPTION SHEET NO.	THE INFORMATION, INCLUDING ESTIMATED QUANTITIES OF WORK, SHOWN ON THESE SHEETS IS BASED ON LIMITED INVESTIGATIONS BY THE STATE AND IS IN NO WAY WARRANTED TO INDICATE THE CONDITIONS OF ACTUAL QUANTITIES OF WORK WHICH WILL BE REQUIRED.		Plotted Date: 4/22/2014		Filename: ...\\HW_MSH_0173_0410_NewCanaan_PLN-04.dgn

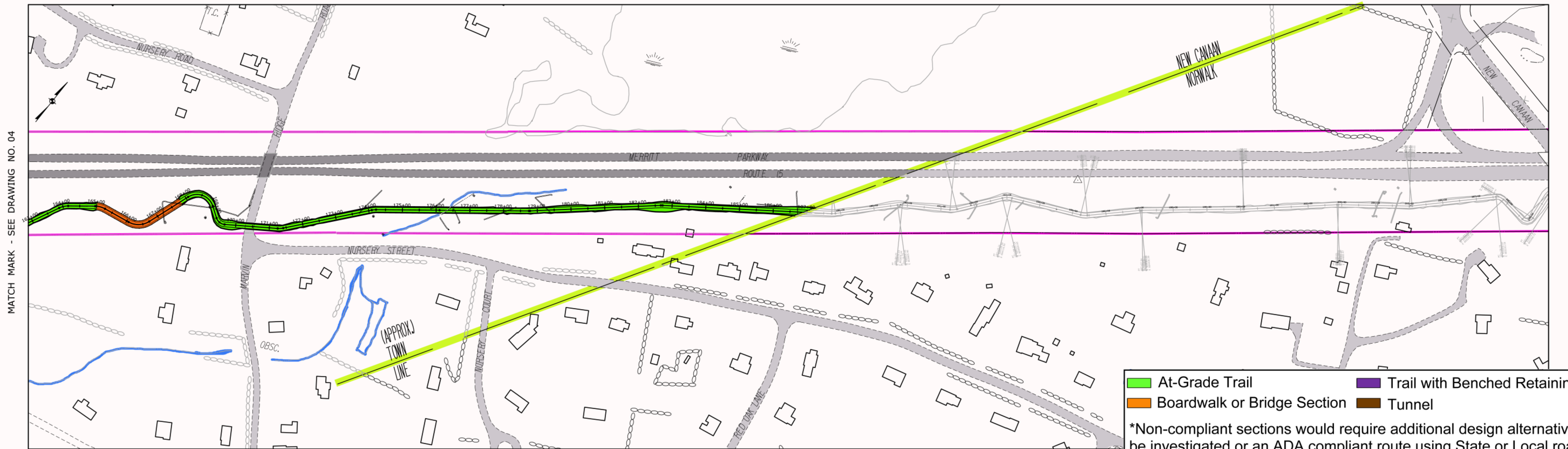
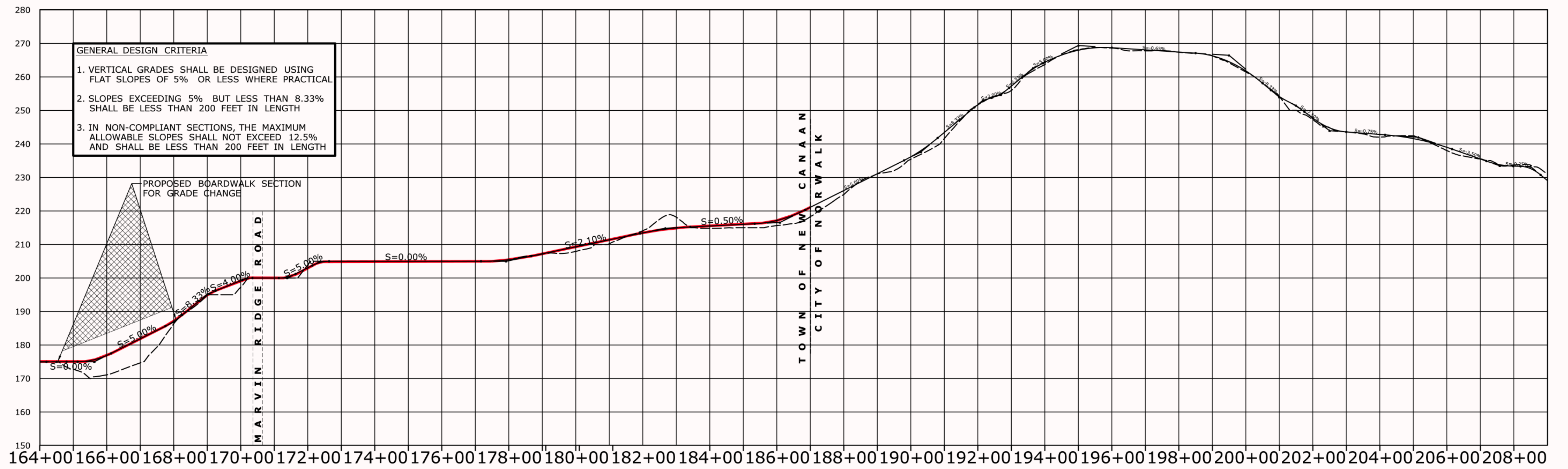

PRELIMINARY DESIGN REVIEW

THE INFORMATION, INCLUDING ESTIMATED QUANTITIES OF WORK, SHOWN ON THESE SHEETS IS BASED ON LIMITED INVESTIGATIONS BY THE STATE AND IS IN NO WAY WARRANTED TO INDICATE THE CONDITIONS OF ACTUAL QUANTITIES OF WORK WHICH WILL BE REQUIRED.		DESIGNER/DRAFTER: MLW CHECKED BY: MSC SCALE AS NOTED	STATE OF CONNECTICUT DEPARTMENT OF TRANSPORTATION Filename: ...VHW_MSH_0173_0410_NewCanaan_PLN-05.dgn	SIGNATURE/BLOCK: OFFICE OF ENGINEERING APPROVED BY:	PROJECT TITLE: MERRITT PARKWAY MULTI-USE TRAIL FEASIBILITY STUDY	TOWN: TOWN OF NEW CANAAN DRAWING TITLE: CONCEPTUAL ALIGNMENT PLAN AND PROFILE	PROJECT NO. 173-410 DRAWING NO. SHT-05 SHEET NO.
REV.	DATE	REVISION DESCRIPTION	SHEET NO.	Plotted Date: 4/23/2014			